

Montageanleitung / Assembly instructions  
Instructions de montage  
Istruzioni di montaggio

## Verkleidung Stahl montieren

Mounting complete steel side cladding  
Installer l'habillage latéral en acier  
Montaggio rivestimento laterale in acciaio



**AUSTROFLAMM**

[www.austroflamm.com](http://www.austroflamm.com)

Originalbetriebsanleitung  
17/01/2025

Version:

#### IMPRESSUM

Eigentümer und Herausgeber

AUSTROFLAMM GMBH  
Austroflamm-Platz 1  
A- 4631 Krenglbach  
Tel: +43 (0) 7249 / 46 443  
[www.austroflamm.com](http://www.austroflamm.com)  
[info@austroflamm.com](mailto:info@austroflamm.com)

Redaktion: Olivera Stojanovic

Abbildungen: Konstruktion

Text: Technische Abteilung (Austroflamm)

#### Copyright

Alle Rechte vorbehalten. Der Inhalt dieser Anleitung darf nur mit Genehmigung des Herausgebers vervielfältigt oder verbreitet werden! Druck-, Rechtschreib- und Satzfehler vorbehalten.

Die Informationen in diesem Dokument können ohne vorherige Ankündigung geändert werden und stellen keine Verpflichtung seitens der Austroflamm GmbH dar. Für eventuelle Fehler in diesem Dokument übernimmt die Austroflamm GmbH keine Haftung.

## Inhaltsverzeichnis

Deutsch.....	4
English .....	8
Français.....	12
Italiano .....	16

## 1 Allgemeines

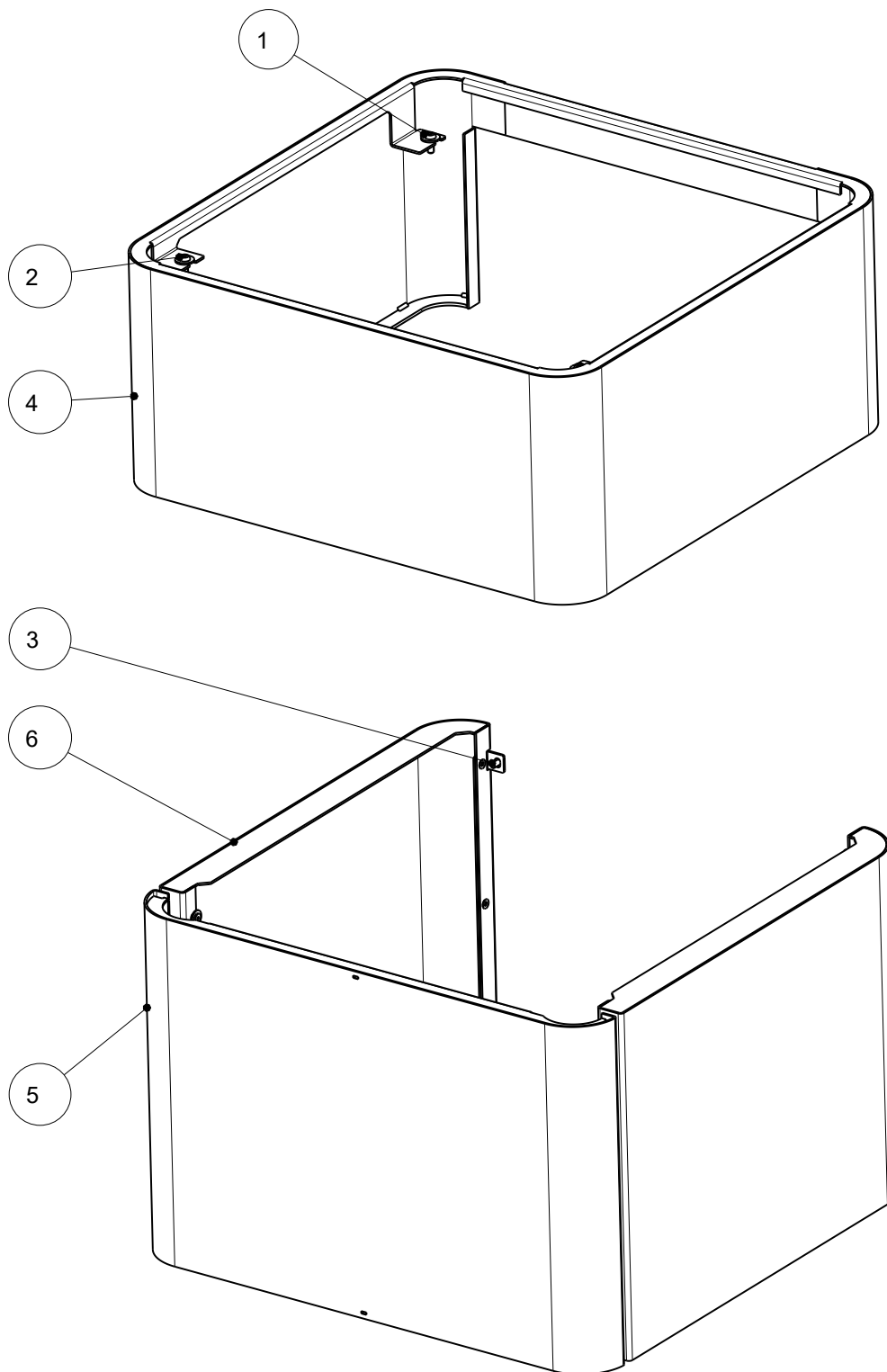

Pos. Nr.	Anzahl	Artikel	Artikel-Nr.
1	4	Karosserie-Scheibe für M6	718131-92
2	4	Linsenschabe mit ISK M6x16	718257-92
3	8	Zylinder-Schraube mit ISK. e. n. K. M5x10	718587-92
4	1	Verkleidung oben geschweißt	729880-29
5	1	Verkleidung Tür geschweißt	729884-29
6	2	Verkleidung unten geschweißt	729887-29

## 2 Verkleidung Stahl montieren



Abb. 1: Tank öffnen

1) Tankdeckel öffnen.

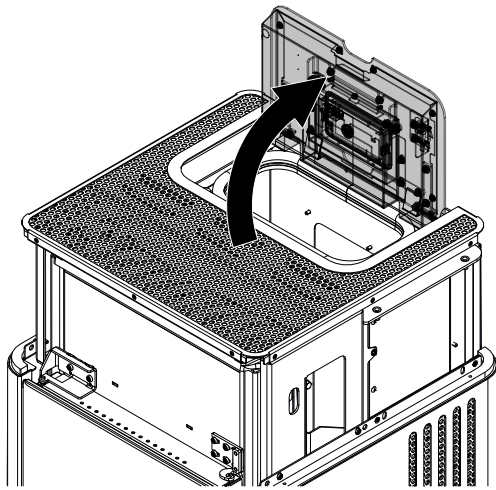

Abb. 2: Schrauben lösen

2) Schrauben lösen.

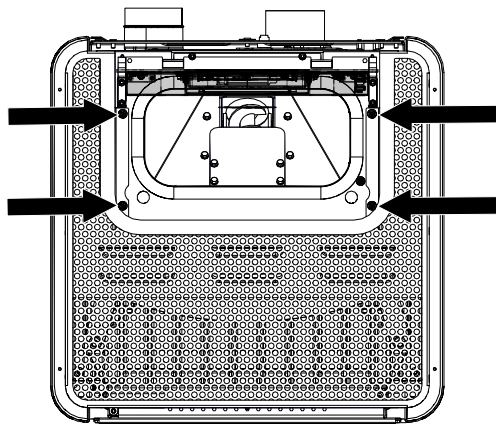

Abb. 3: Deckel abnehmen

3) Deckel abnehmen.

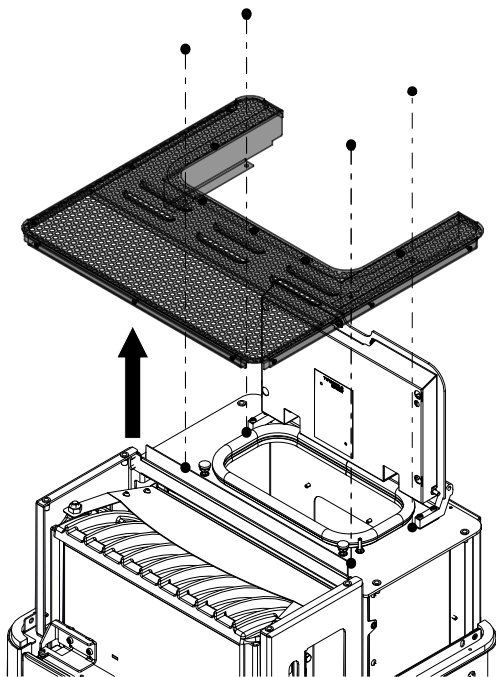

Abb. 4: untere Seitenteile befestigen

- 4) Die unteren Seitenteile zuerst einhängen und befestigen.

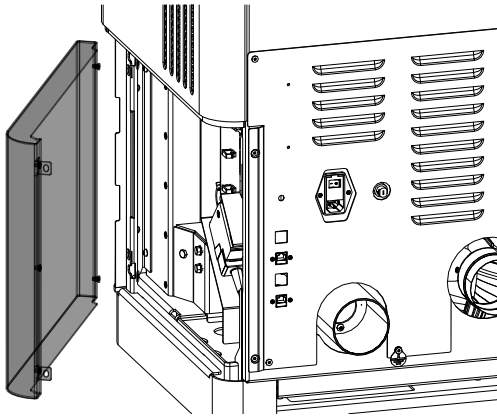

Abb. 5: Seitenteile befestigen

- 5) Seitenteil nun zum Pelletofen bringen und mit den Schrauben auf der Rückseite des Pelletofens befestigen.
- 6) Wiederholen Sie die letzten zwei Schritte für die andere Seite und montieren Sie das zweite untere Seitenteil.

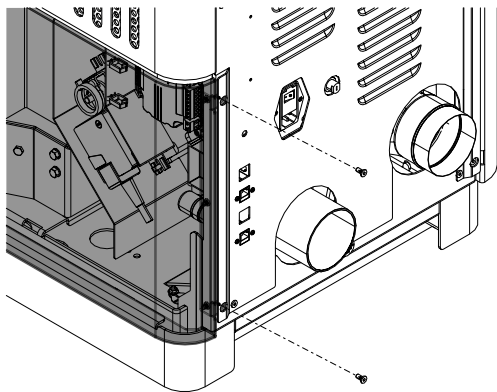

Abb. 6: vordere Stahlverkleidung montieren

- 7) Verkleidungstür öffnen.
- 8) Die vordere Stahlverkleidung mit den Schrauben an der Verkleidungstür montieren.
- 9) Verkleidungstür schließen.

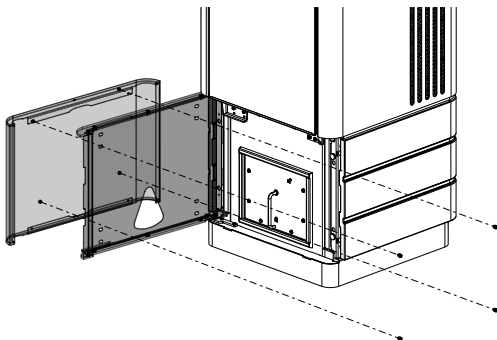

Abb. 7: obere Stahlverkleidung montieren

- 10) Obere Stahlverkleidung anbringen und mit den Schrauben montieren.

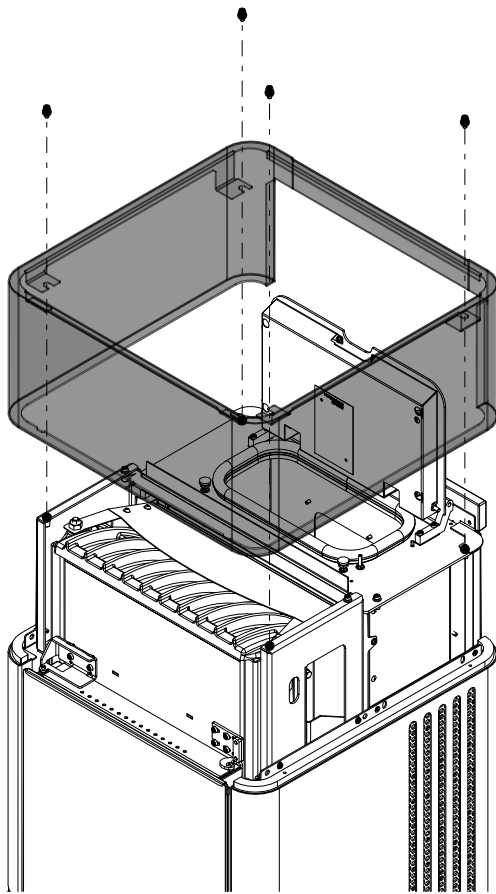

Abb. 8: Deckel wieder montieren

- 11) Deckel wieder anbringen und montieren.

# 1 General

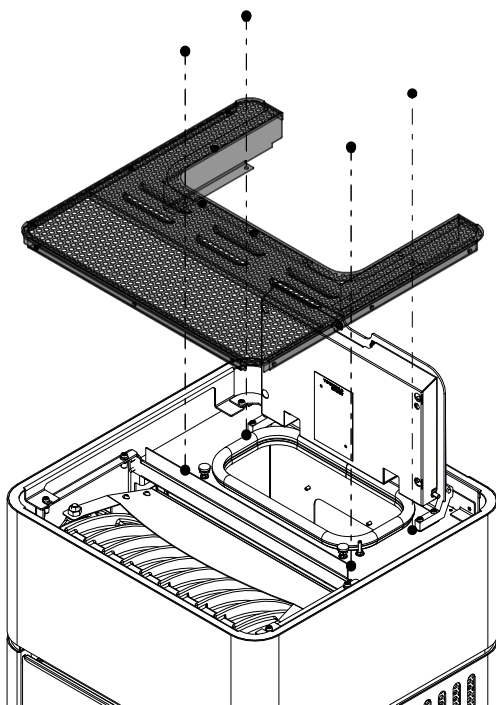
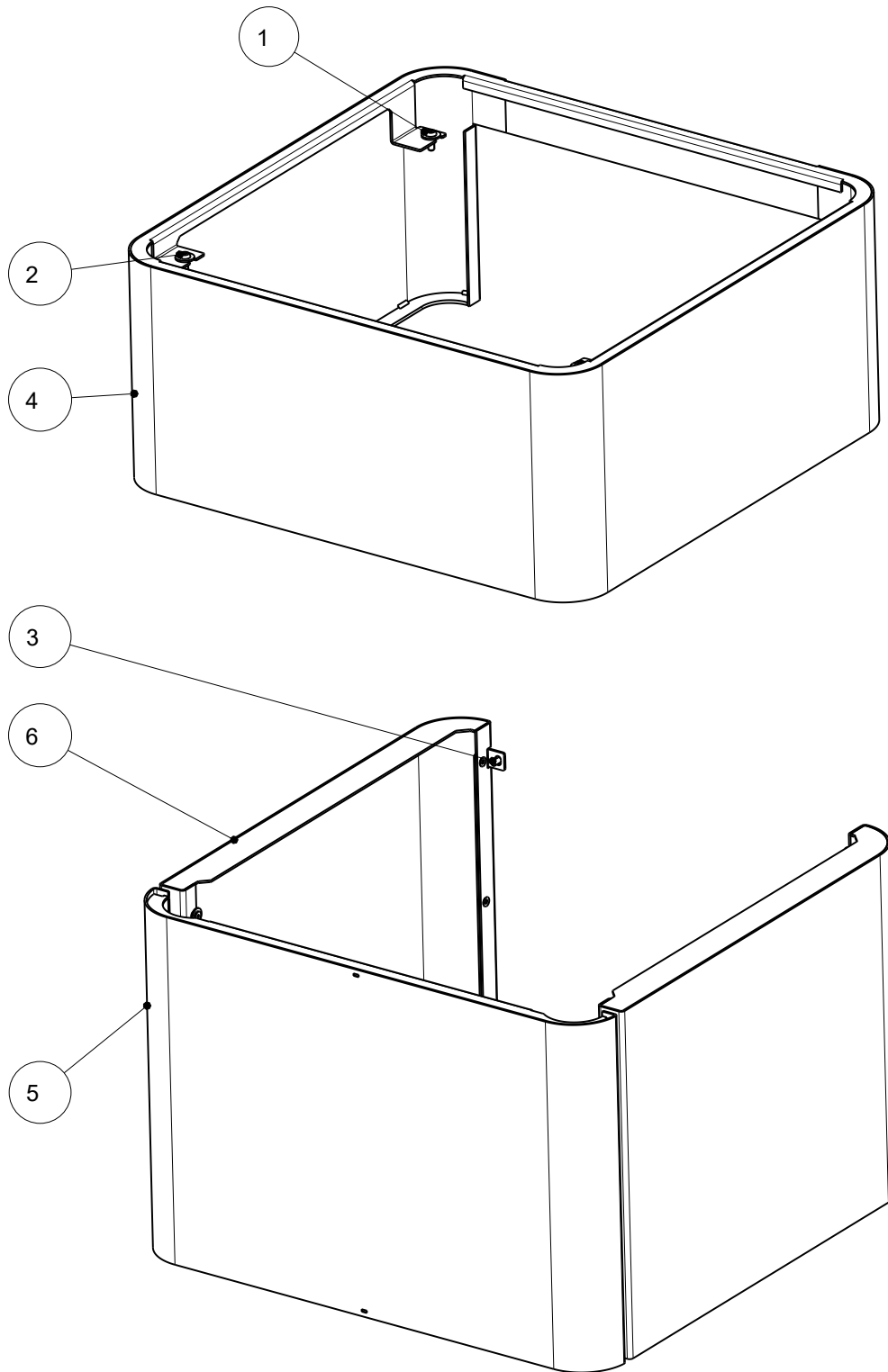

Item no.	Quantity	Article	Article no.
1	4	Large diameter washer for M6	718131-92
2	4	Oval-head screw with hexagon socket M6x16	718257-92
3	8	Cylinder screw with hexagon socket v.l.h. M5x10	718587-92
4	1	Cladding, welded at top	729880-29
5	1	Cladding door, welded	729884-29
6	2	Cladding, welded at bottom	729887-29



## 2 Mounting complete steel side cladding

1) Open hopper lid.

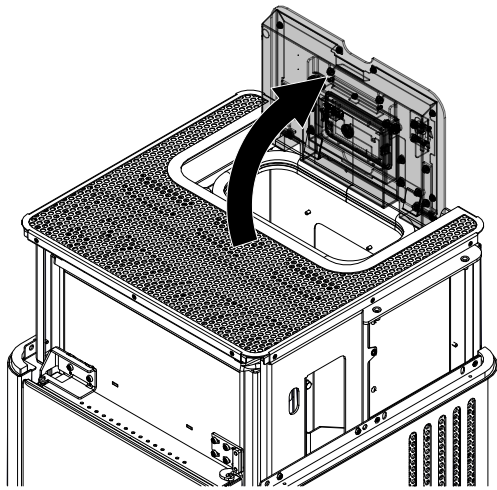

Fig. 1: Opening the hopper

2) Undo screws.

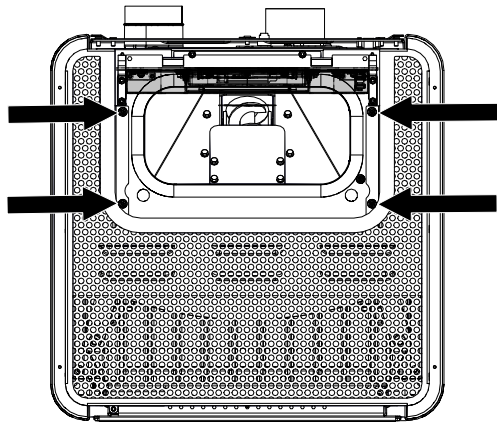

Fig. 2: Undoing the screws

3) Detach lid.

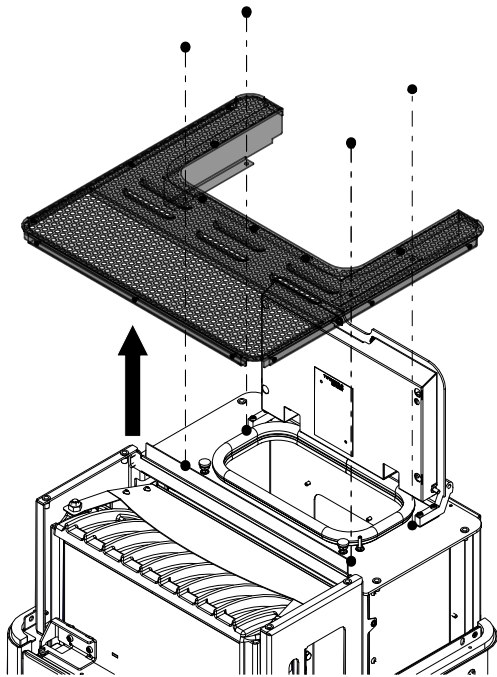

Fig. 3: Detaching the lid

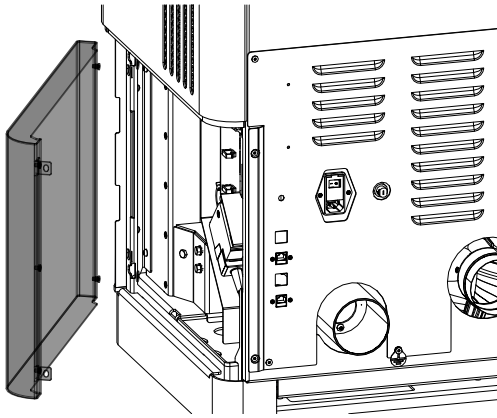

Fig. 4: fastening the lower side parts

4) First fit and fasten the lower side parts.

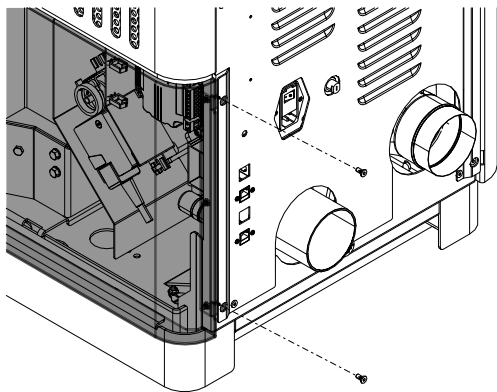

Fig. 5: Fastening the side parts

5) Now bring the side part to the pellet stove and use the screws to fasten it on the back of the pellet stove.

6) Repeat the last two steps for the other side and mount the second lower side part.

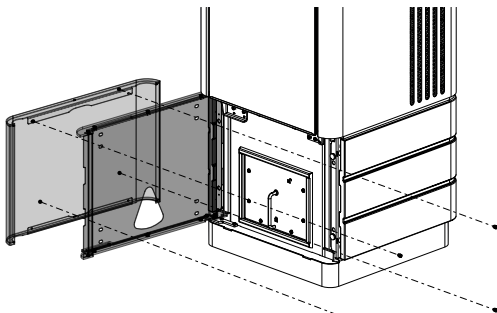

Fig. 6: mounting front steel cladding

7) Open cladding door.

8) Use the screws to mount the front steel cladding on the cladding door.

9) Close cladding door.

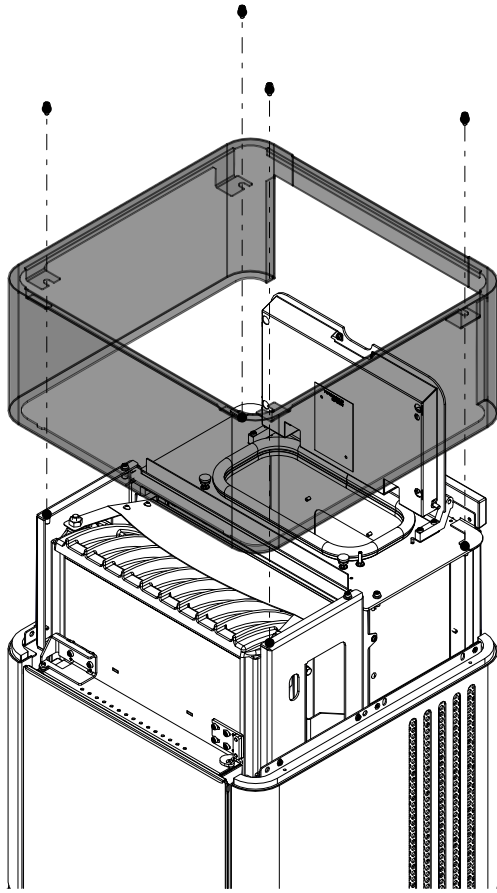

Fig. 7: mounting the upper steel cladding

10) Attach steel cladding and mount with the screws.

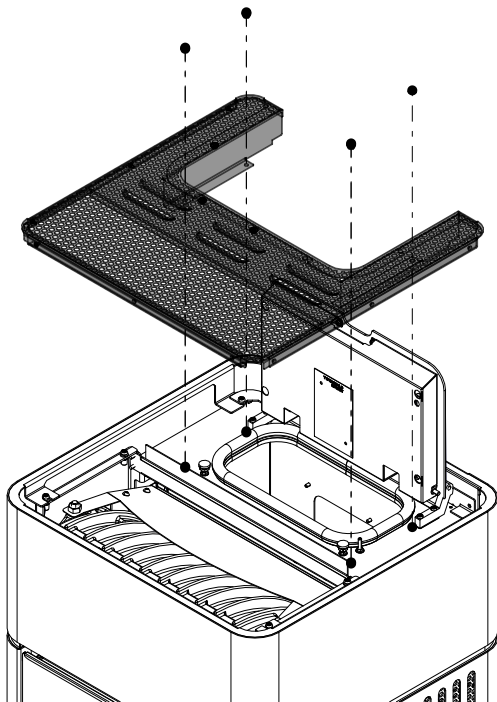
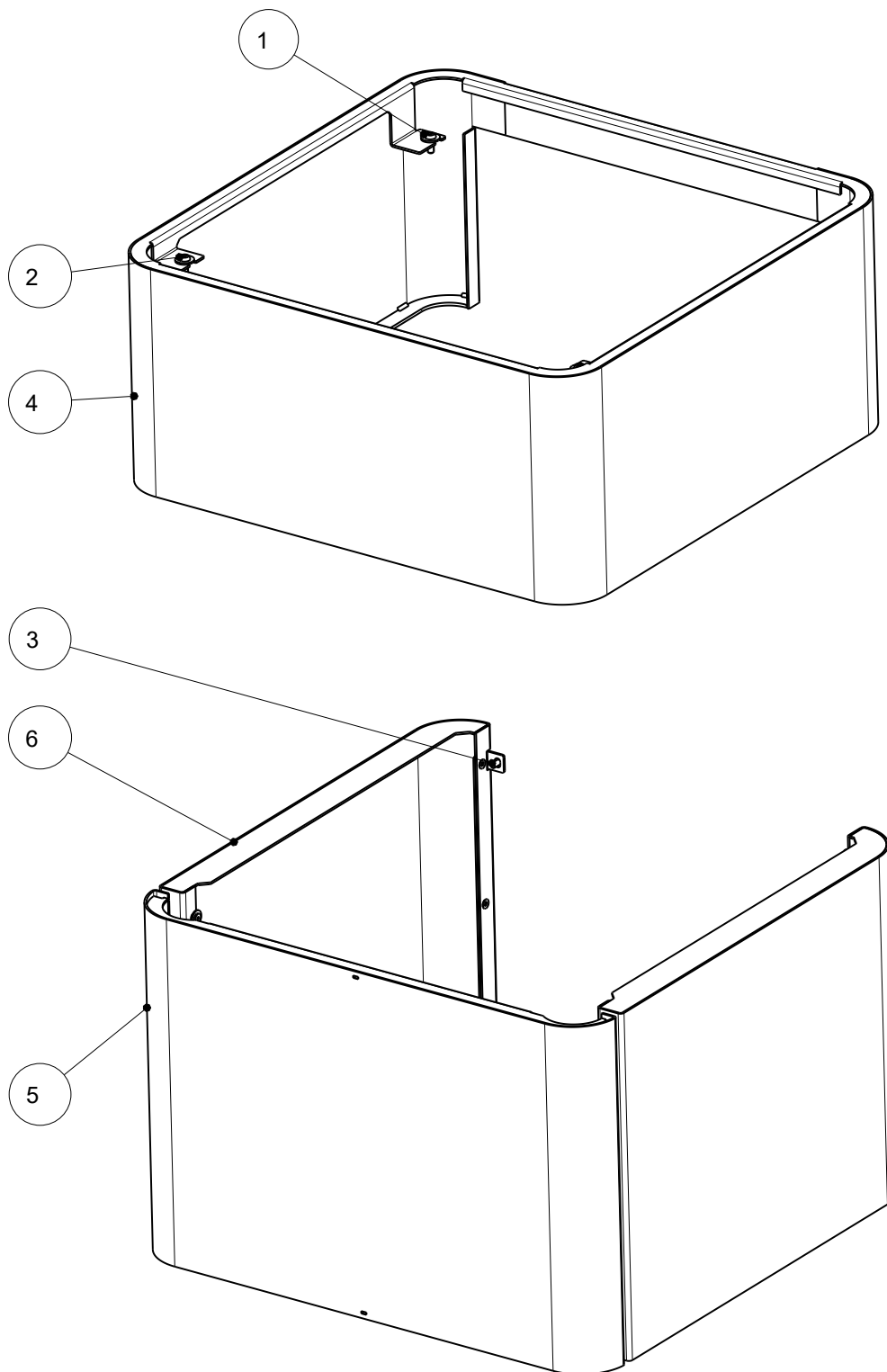

Fig. 8: Refitting the lid

11) Reattach and refit lid.

## 1 Généralités



Pos. n°.	Quantité	Article	Article n°
1	4	Rondelle de carrosserie pour M6	718131-92
2	4	Vis à tête bombée 6 pans creux M6x16	718257-92
3	8	Vis cylindrique 6 pans creux à tête extrêmement basse M5x10	718587-92
4	1	Habillage haut soudé	729880-29
5	1	Habillage porte soudé	729884-29
6	2	Habillage bas soudé	729887-29

## 2 Installer l'habillage latéral en acier

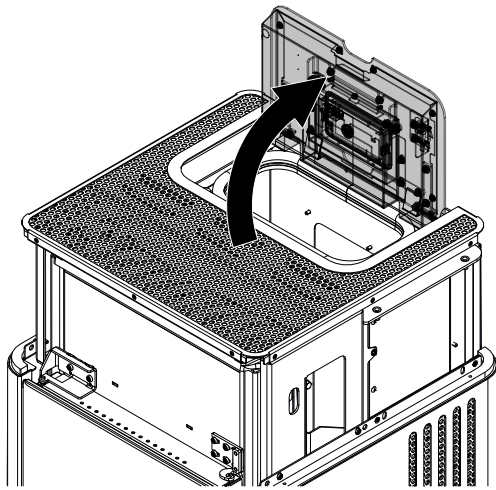

Fig. 1: Ouvrir le réservoir

1) Ouvrir le couvercle du réservoir.

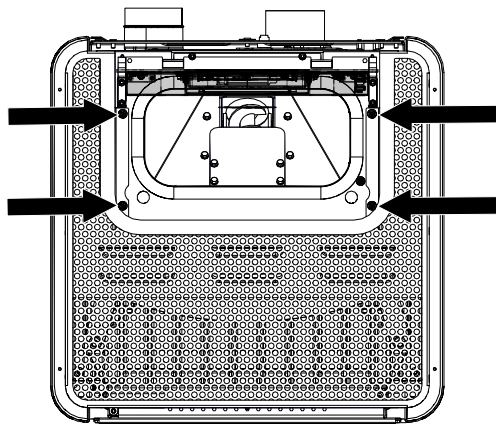

Fig. 2: Dévisser les vis

2) Dévisser les vis.

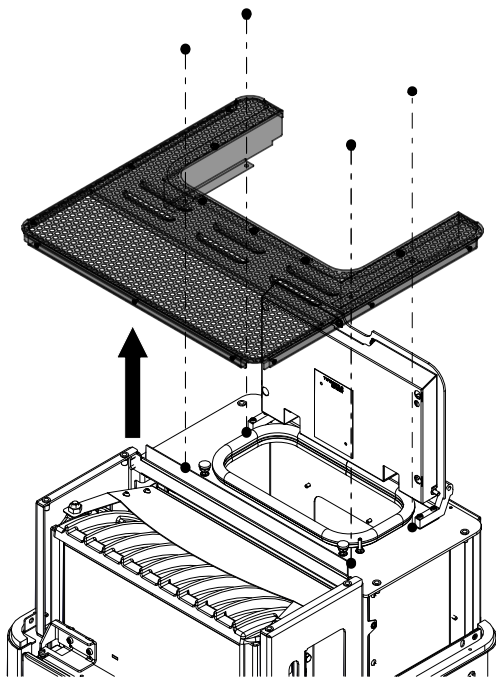

Fig. 3: Enlever le couvercle

3) Enlever le couvercle.

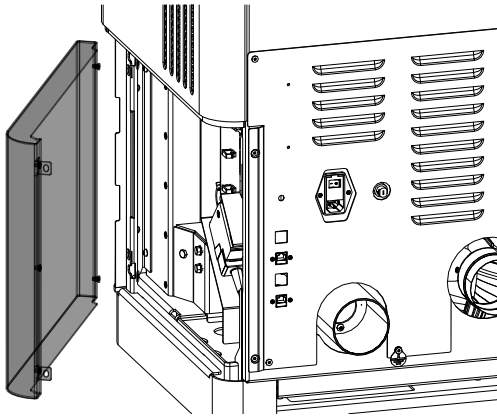

Fig. 4: Fixer les parties latérales inférieures

- 4) Commencer par accrocher et fixer les parties latérales basses.

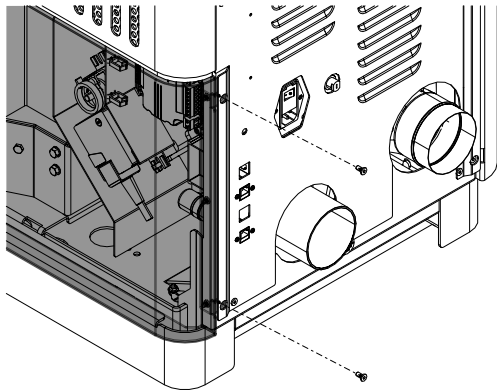

Fig. 5: Fixer les parties latérales

- 5) Rabattre ensuite la partie latérale contre le poêle à pellets et la fixer avec les vis au dos du poêle à pellets.
- 6) Répétez les deux dernières étapes pour l'autre côté et fixez la seconde partie latérale basse.

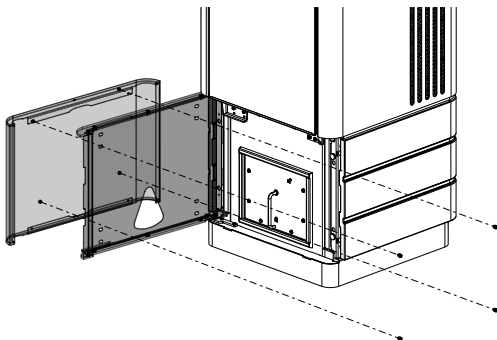

Fig. 6: Installer l'habillage en acier avant

- 7) Ouvrir la porte habillable.
- 8) Visser l'habillage en acier avant sur la porte habillable.
- 9) Fermer la porte habillable.

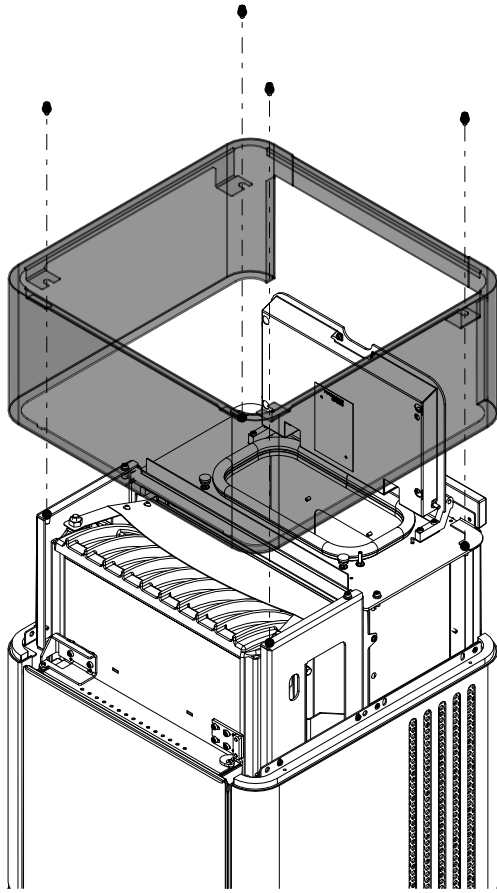

Fig. 7: Installer l'habillage en acier supérieur

10) Poser l'habillage en acier supérieur et le fixer avec les vis.

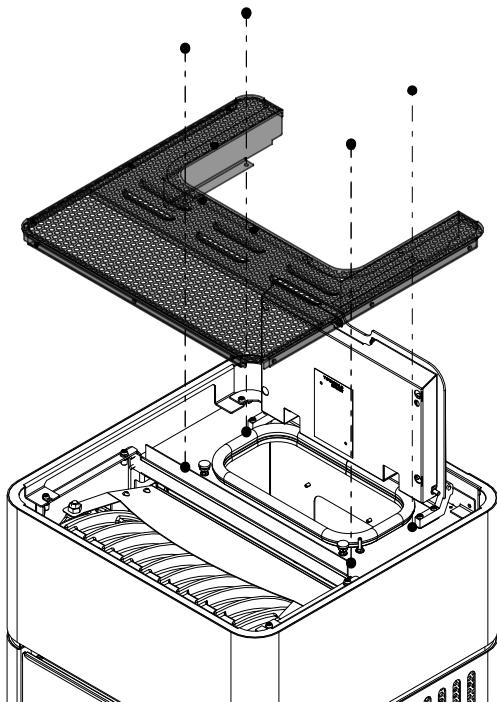
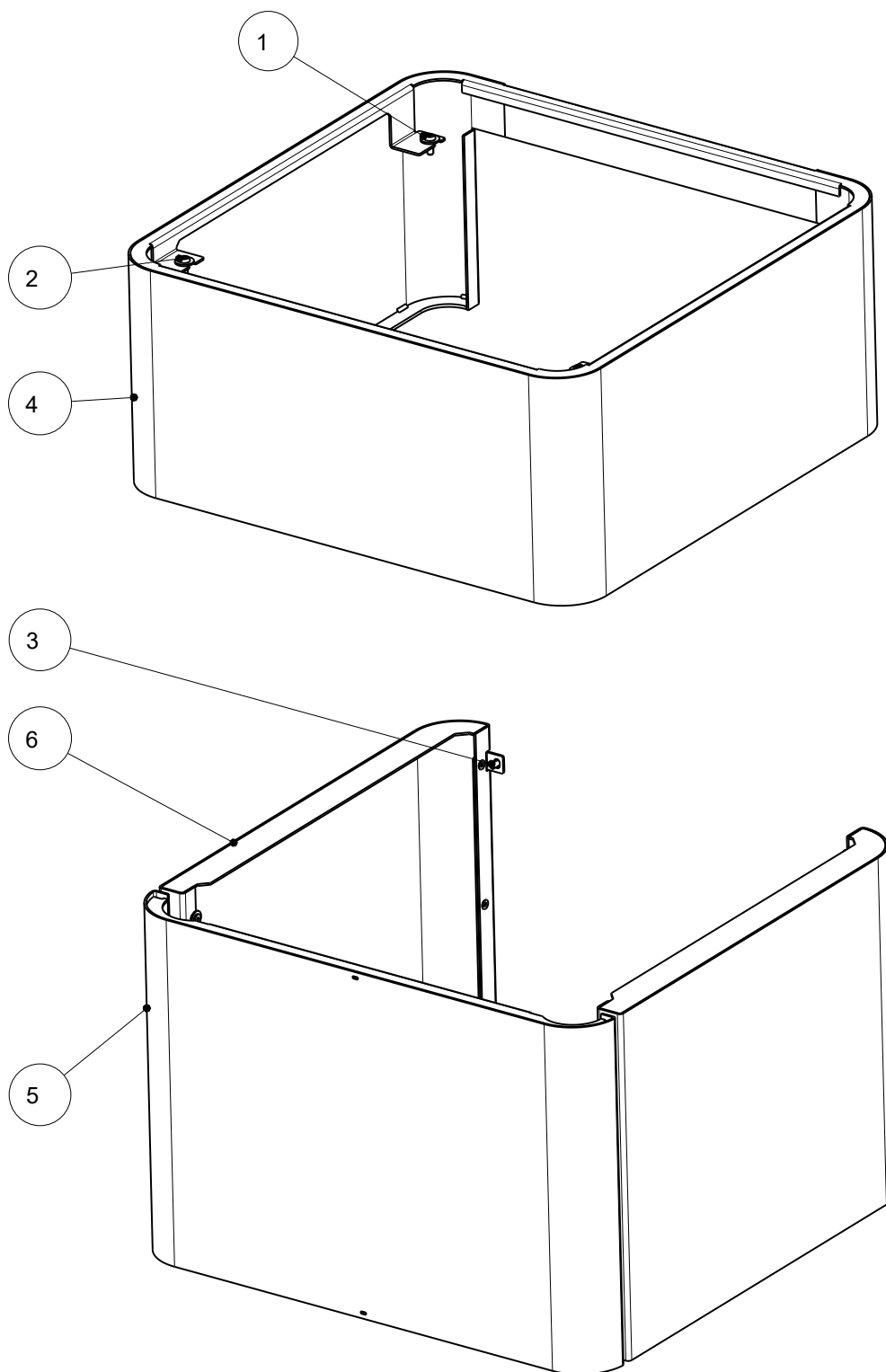

Fig. 8: Remettre le couvercle en place

11) Remettre le couvercle en place et le fixer.

## 1 Generalità



N. pos.	Q.tà	Articolo	N. art.
1	4	Rondella del corpo per M6	718131-92
2	4	Vite a testa bombata con esag. inc. M6x16	718257-92
3	8	Vite cilindrica con esag. inc. a testa bassissima M5x10	718587-92
4	1	Rivestimento superiore saldato	729880-29
5	1	Rivestimento sportello saldato	729884-29
6	2	Rivestimento inferiore saldato	729887-29



## 2 Montaggio del rivestimento in acciaio

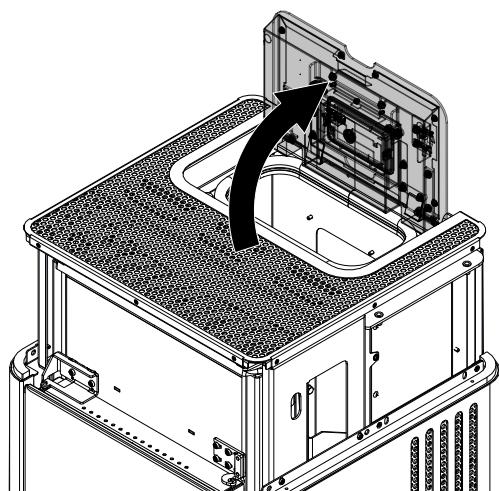

Fig. 1: Apertura del serbatoio

1) Aprire il coperchio del serbatoio.

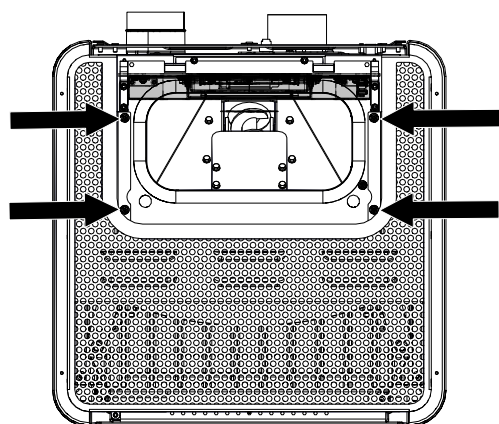

Fig. 2: Svitamento delle viti

2) Svitare le viti.

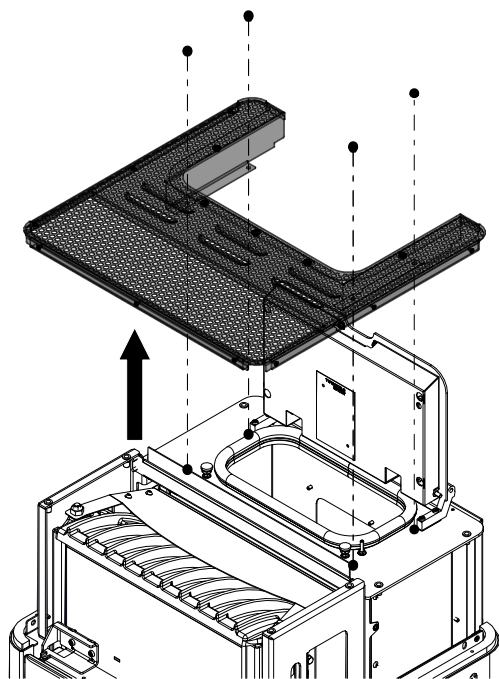

Fig. 3: Rimozione del coperchio

3) Rimuovere il coperchio.

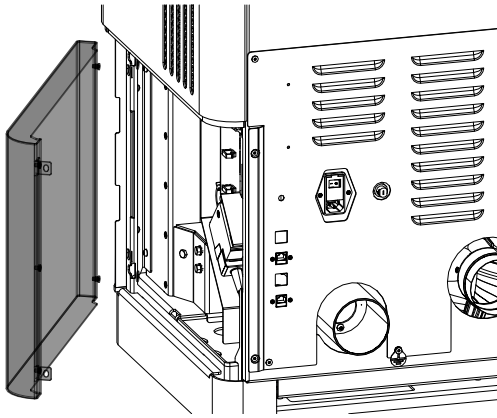

Fig. 4: Fissaggio delle parti laterali inferiori

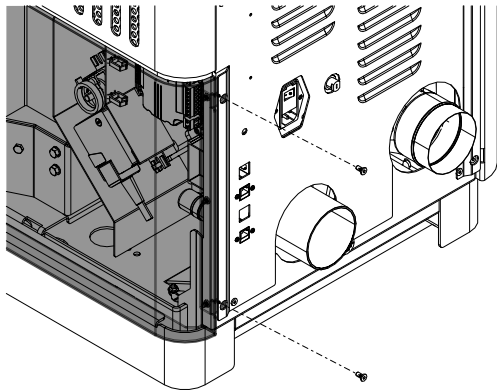

Fig. 5: Fissaggio delle parti laterali

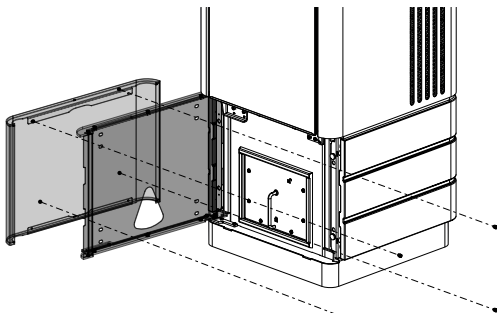

Fig. 6: Montaggio del cappotto in acciaio anteriore

4) Agganciare innanzitutto le parti laterali inferiori e fissarle.

5) Ora accostare la parte laterale alla stufa a pellet e fissarla con le viti sul retro della stufa stessa.

6) Ripetere gli ultimi due passaggi sull'altro lato e montare la seconda parte laterale inferiore.

7) Aprire lo sportello del rivestimento.

8) Con le viti, montare il cappotto anteriore in acciaio sullo sportello del rivestimento.

9) Chiudere lo sportello del rivestimento.

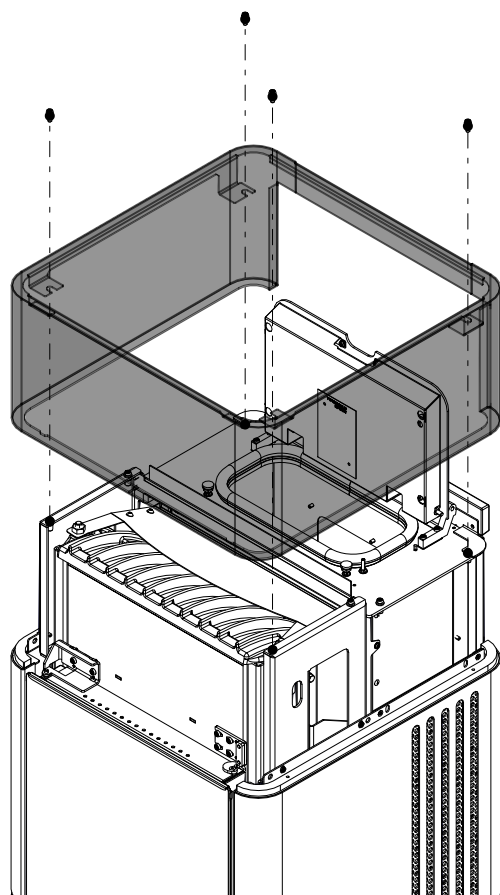

Fig. 7: Montaggio del cappotto in acciaio superiore

10) Mettere il cappotto in acciaio e fissarlo con le viti.

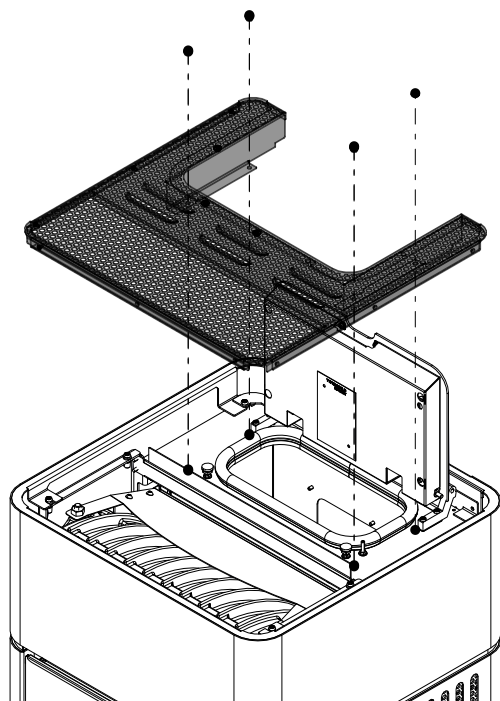

Fig. 8: Rimontaggio del coperchio

11) Ricollocare il coperchio al suo posto e montarlo.

AUSTROFLAMM GMBH  
Austroflamm-Platz 1  
A- 4631 Krenglbach

Tel: +43 (0) 7249 / 46 443  
[www.austroflamm.com](http://www.austroflamm.com)  
[info@austroflamm.com](mailto:info@austroflamm.com)

813003-29 - 945200

