

Montageanleitung / Assembly instructions
Instructions de montage
Istruzioni di montaggio

Verkleidung Stahl montieren - Scotty Duo

Mounting steel cladding - Scotty Duo

Installer l'habillage acier - Scotty Duo

Montaggio del rivestimento in acciaio - Scotty Duo



AUSTROFLAMM

www.austroflamm.com

Originalbetriebsanleitung
17/01/2025

Version: 1.0

IMPRESSUM

Eigentümer und Herausgeber

AUSTROFLAMM GMBH
Austroflamm-Platz 1
A- 4631 Krenglbach
Tel: +43 (0) 7249 / 46 443
www.austroflamm.com
info@austroflamm.com

Redaktion: Olivera Stojanovic

Abbildungen: Konstruktion

Text: Technische Abteilung (Austroflamm)

Copyright

Alle Rechte vorbehalten. Der Inhalt dieser Anleitung darf nur mit Genehmigung des Herausgebers vervielfältigt oder verbreitet werden! Druck-, Rechtschreib- und Satzfehler vorbehalten.

Die Informationen in diesem Dokument können ohne vorherige Ankündigung geändert werden und stellen keine Verpflichtung seitens der Austroflamm GmbH dar. Für eventuelle Fehler in diesem Dokument übernimmt die Austroflamm GmbH keine Haftung.

Inhaltsverzeichnis

Deutsch.....	4
English	18
Français.....	32
Italiano	46

Inhaltsverzeichnis

1	Allgemein.....	5
2	Montage.....	6
2.1	Verkleidung Stahl montieren	6

1 Allgemein

Stahlverkleidung

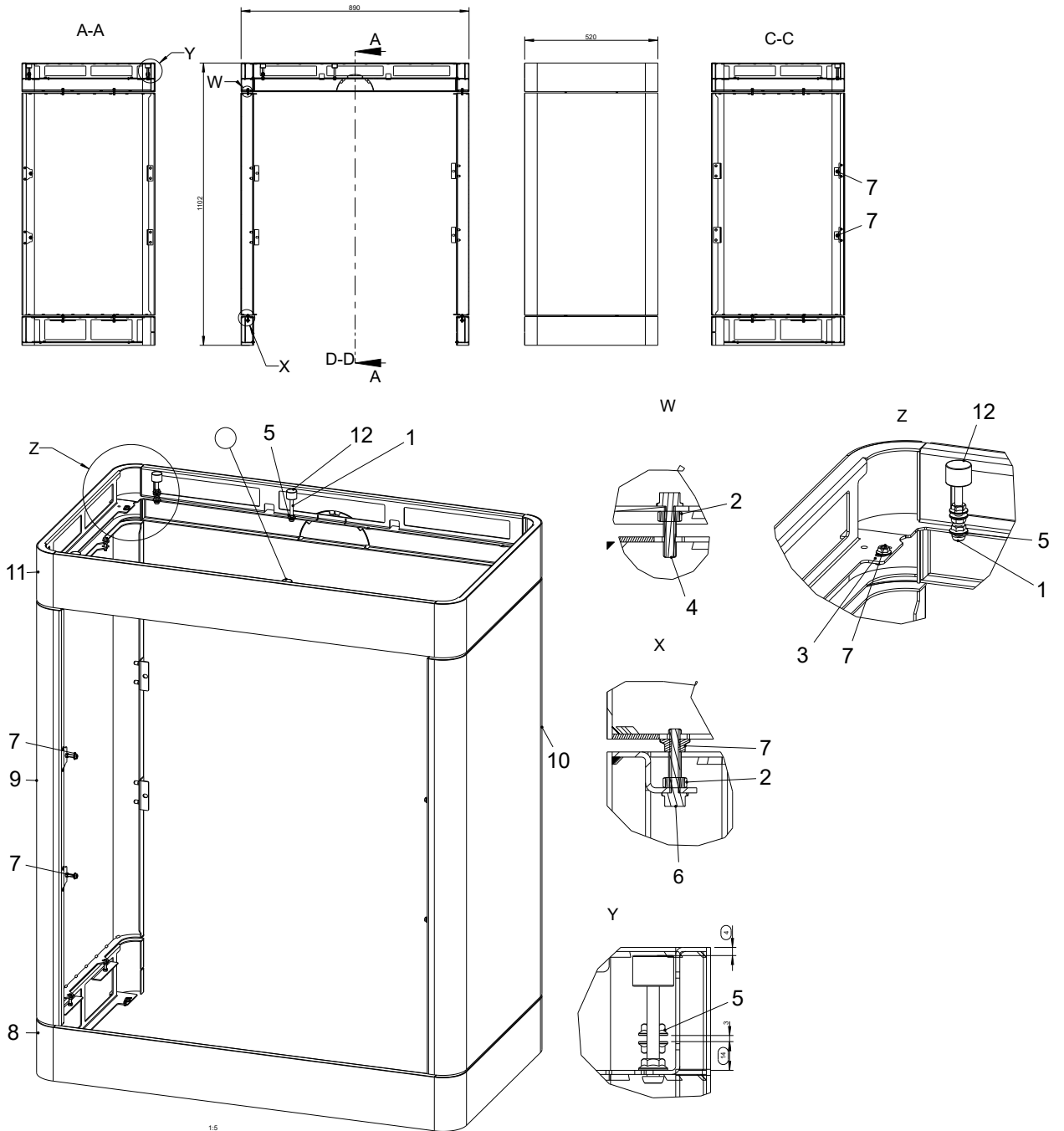

Pos.	Stück	Artikel	Artikel-Nr.
1	4	Linsenschrauben mit Innensechskant M6x50 ISO7380	718043-92
2	8	Sechskant-Mutter M5 DIN934	718148-92
3	8	Gewindestift mit Innensechskant + Ringschrauben M5x8 DIN916	718199-92
4	4	Taptite Sechskantschraube M5x20 DIN7500D	718230-92
5	8	Sechskant-Mutter mit Flansch M6 DIN6923	718740-92
6	4	Taptite Sechskantschraube M5x25 DIN7500D	718923-92
7	16	Sechskant-Mutter mit Flansch M5 DIN6923	723916-92
8	1	Verkleidung Sockel	733144-29
9	1	Verkleidung links	733145
10	1	Verkleidung rechts	733146

2 Montage

2.1 Verkleidung Stahl montieren



Abb. 1: Sockel aus Verpackung nehmen

- 1) Unteren Sockel aus der Verpackung nehmen.
⇒ Der Sockel ist vormontiert.

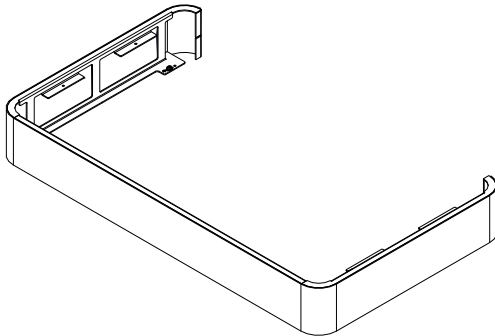

Abb. 2: Sockel montieren

- 2) Sockel montieren.

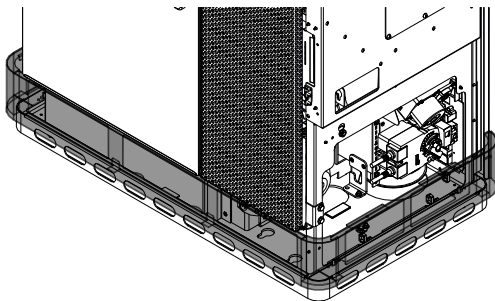

Abb. 3: Kipprostmotor abbauen

- 3) Kipprostmotor abbauen.
⇒ Die Stellung vom Kipprostmotor (A) beachten. Ist die Stellung anders als abgebildet kontaktieren Sie unseren Fachhändler.
- 4) Die zwei Schrauben lösen und Kipprostmotor abnehmen.

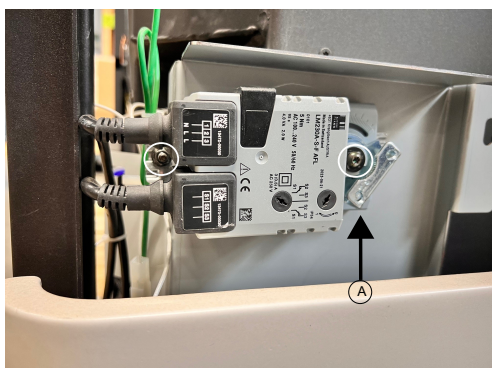

Abb. 4: Sockel einstellen

- 5) Den Sockel mit der Einstellschraube seitlich am Kombiofen ausrichten.

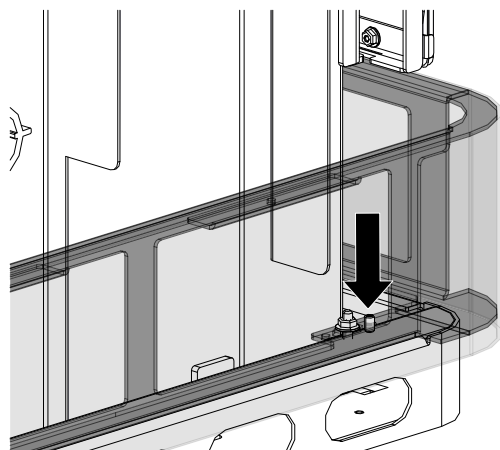

Abb. 5: Muttern festziehen

- 6) Vier Muttern seitlich festziehen.

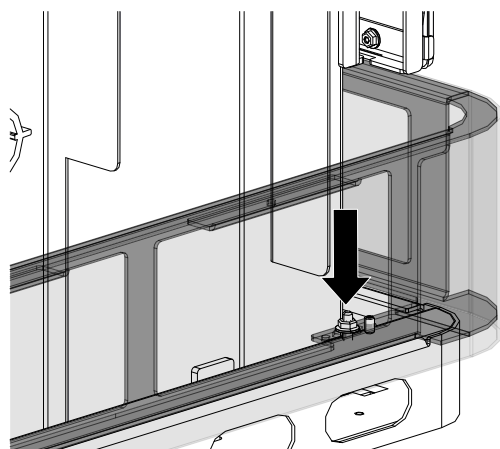

Abb. 6: Sockel oben zusammenbauen

- 7) Oberen Sockel aus der Verpackung nehmen.
⇒ Der Sockel ist vormontiert.

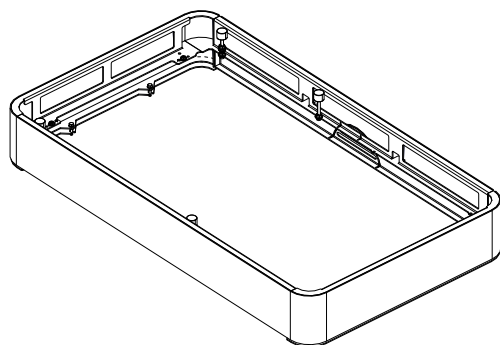

Abb. 7: Abstand auf 13 mm

8) Den Abstand auf 13 mm überprüfen und justieren.

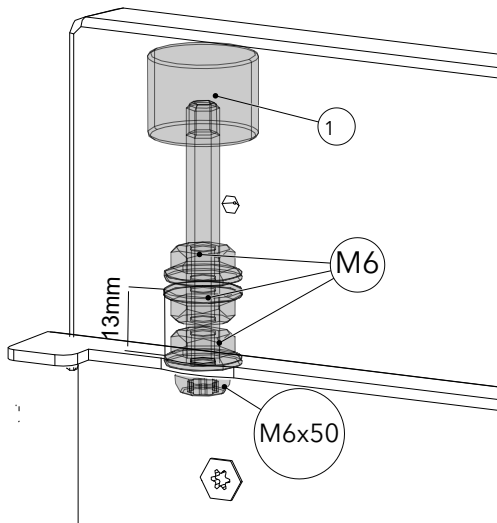

Abb. 8: Schrauben lösen und Abdeckung entfernen

9) Die beiden Schrauben (TX25) lockern und die Abdeckung (Langlöcher) entfernen.

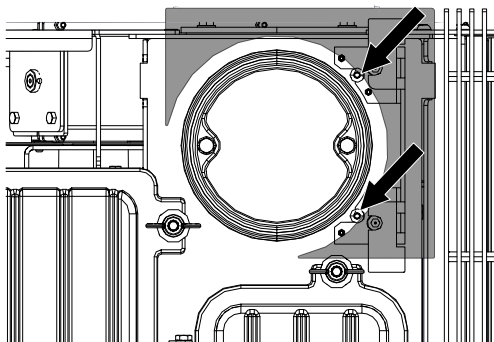

Abb. 9: Behälterdeckel öffnen

10) Den Behälterdeckel (1) ganz öffnen.

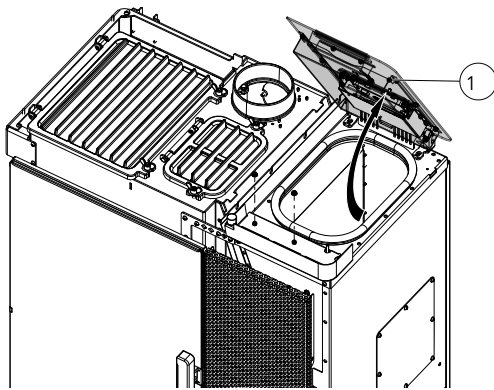

Abb. 10: Oberen Ring montieren

11) Oberen Ring montieren. Aufpassen, dass der Behälterdeckel nicht zerkratzt wird.



- 12) Den oberen Ring mit den Gewindestift M5x8 (1) ausrichten.
- 13) Die vier Muttern mit Flansch M5 (2) montieren und festziehen.

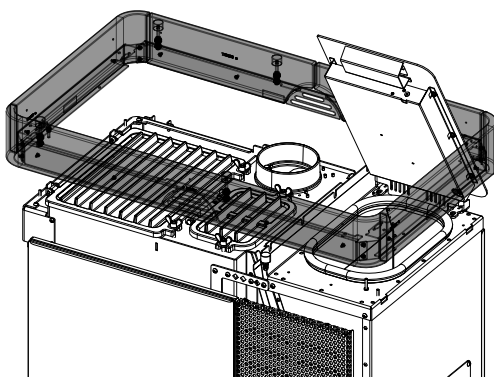
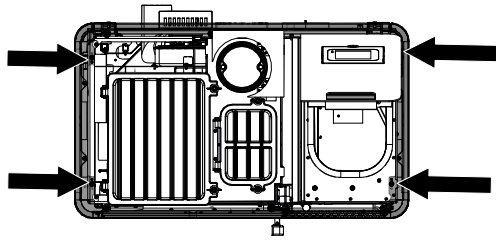

Abb. 11: Oberen Ring ausrichten



- 14) Darauf achte, dass sich der Behälterdeckel ohne Problem öffnen und schließen lässt.

Abb. 12: Oberen Keramik-Rahmen ausrichten

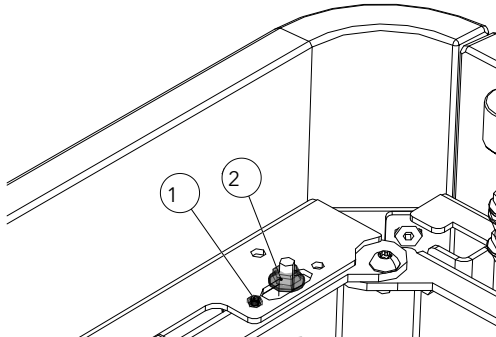
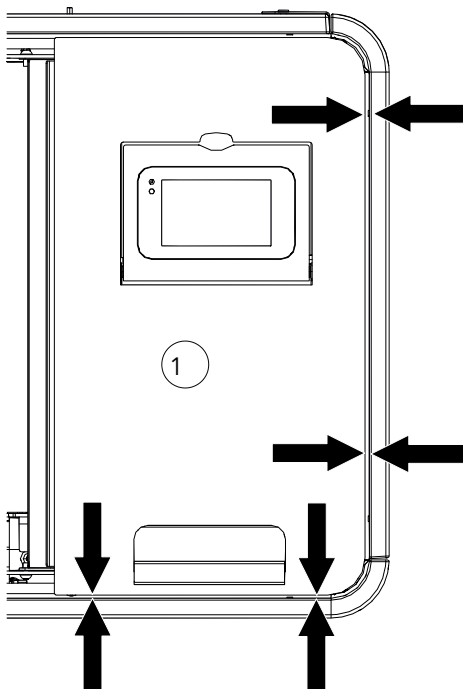
15) Die hinteren Blenden demontieren.



Abb. 13: Blenden demontieren



Abb. 14: Stahlverkleidung von hinten befestigen

16) Linke seitliche Seitenverkleidung von hinten am Kaminofen befestigen.

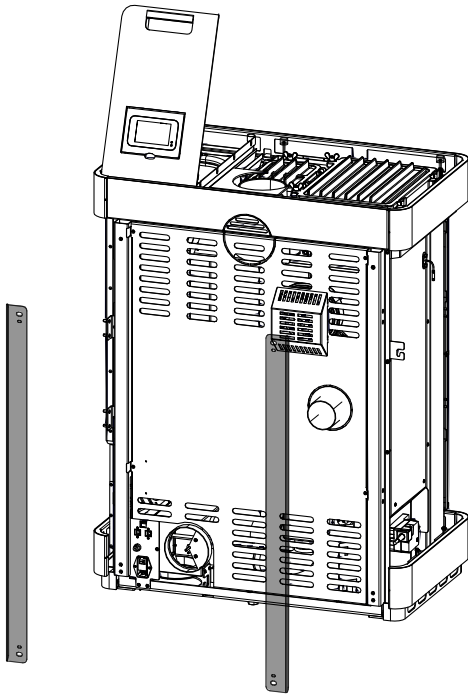
17) Wenn die Löcher nicht passen, muss der unteren Sockel, mit den Muttern so ausgerichtet werden, dass die linke Seitenverkleidung montiert werden kann.

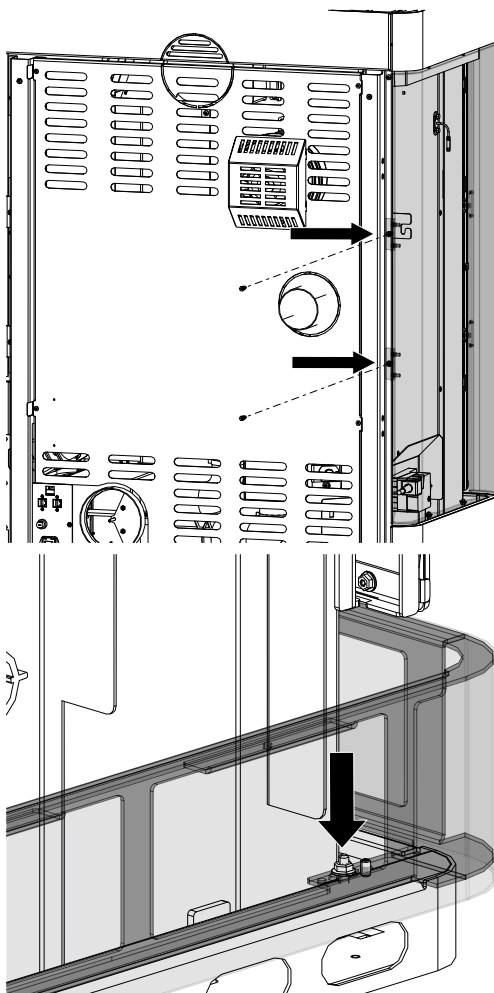

Abb. 15: Tür öffnen und Stahlverkleidung befestigen

18) Tür öffnen und von der Innenseite die seitliche Stahlverkleidung befestigen.

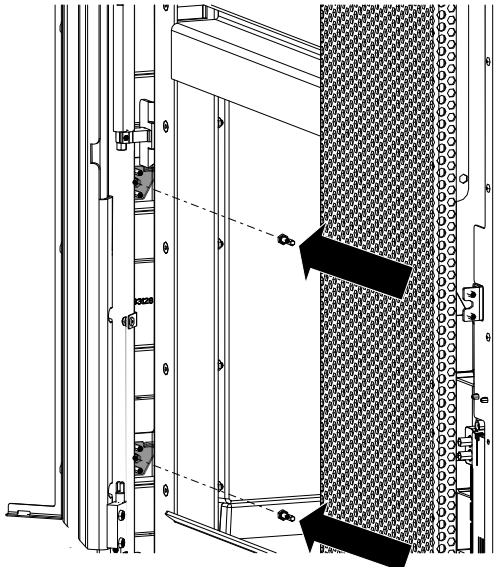

Abb. 16: Stahlverkleidung ausrichten

19) Mit den Einstellschrauben (1) kann die Stahlverkleidung mit der Tür ausgerichtet werden.

- ⇒ Stellen Sie die Einstellschrauben so ein, dass die Tür leicht aufgemacht werden kann, ohne die seitliche Stahlverkleidung zu berühren.

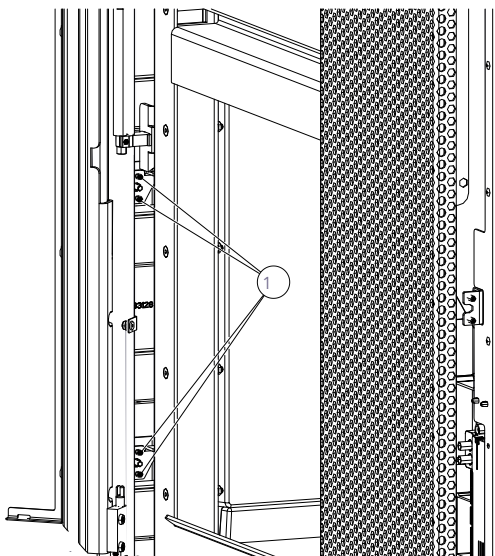

Abb. 17: Vordere Verkleidung entfernen

- 20) Bei der vorderen Verkleidung die Schraube lösen und die Verkleidung entfernen.

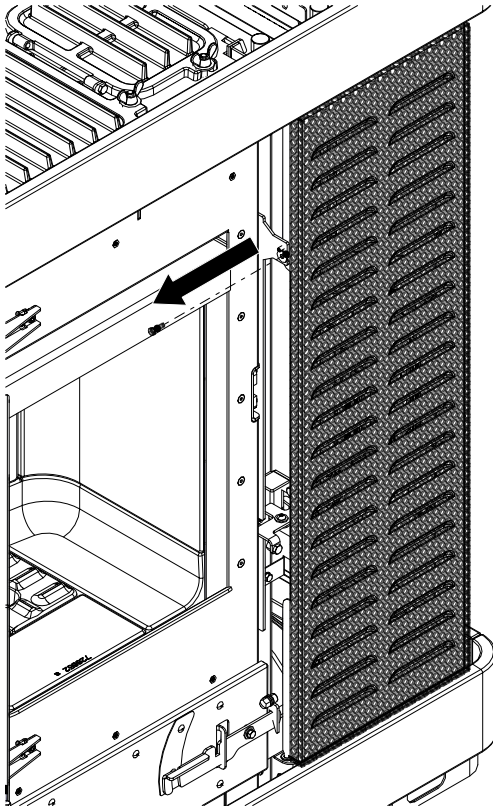

Abb. 18: Seitenverkleidung befestigen

- 21) Die rechte Seitenverkleidung wie bereits beschrieben anbringen und hinten befestigen.

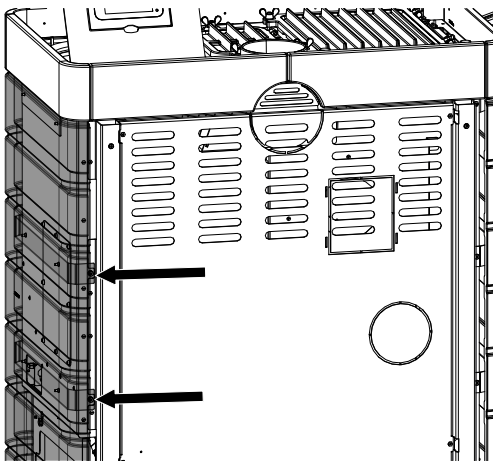
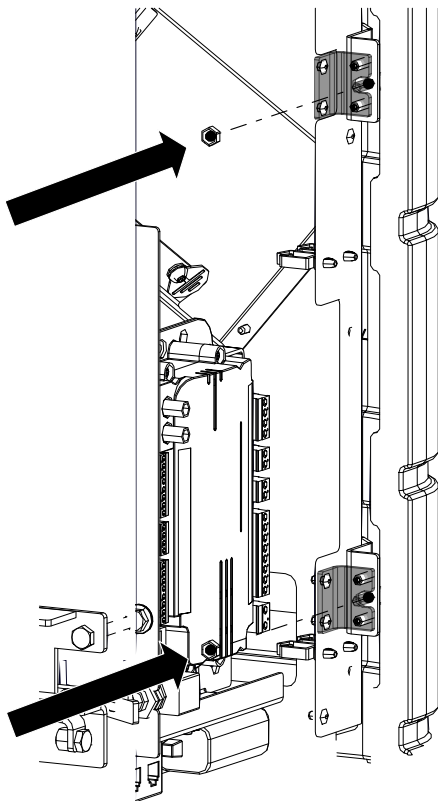

- 22) Vorne die rechte Seitenverkleidung befestigen und mit Einstellschrauben ausrichten.

Abb. 19: Seitenverkleidung befestigen und ausrichten

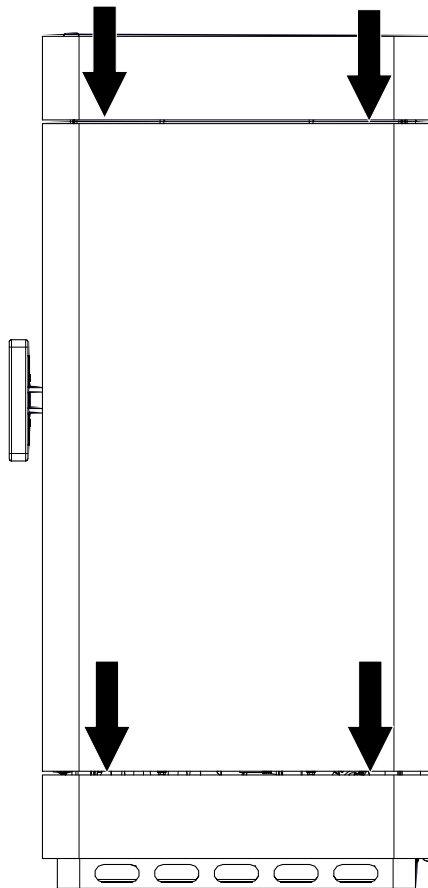

- 23) Kontrollieren Sie am Schluss, ob die Stahlverkleidung auf allen Seiten den gleichen Abstand hat.
⇒ Gegebenenfalls mit den Einstellschrauben die Abstände nachjustieren.

Abb. 20: Abstände kontrollieren



Abb. 21: Verkleidung aufsetzen

24) Verkleidung vorne aufsetzen und Schrauben locker eindrehen.

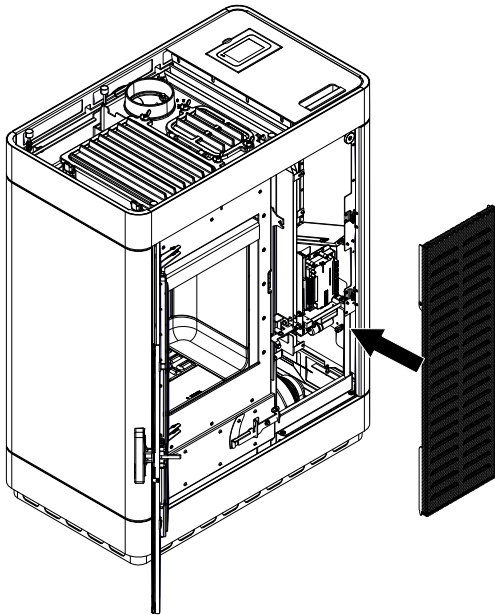

Abb. 22: Blenden montieren

25) Montieren Sie wieder die hinteren zwei Blenden.



Abb. 23: Behältermulde montieren

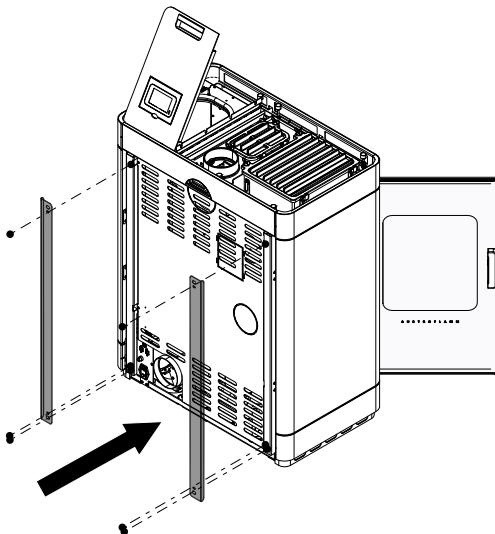

Abb. 24: Muttern und Silikon-Metall-Puffer anbringen

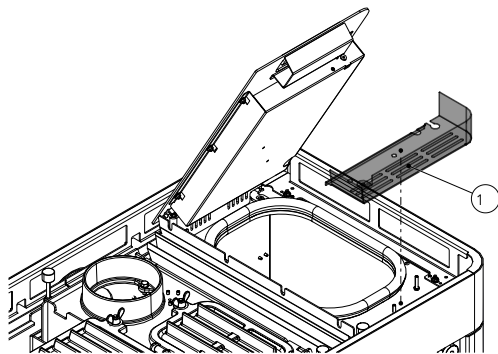

Abb. 25: Konvektionslamellen rechts montieren

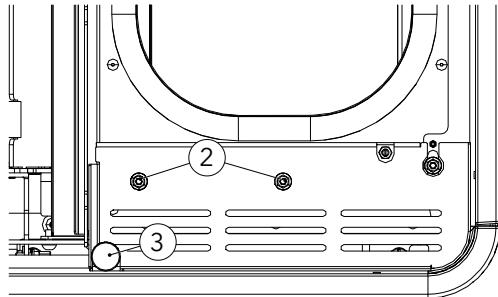

Abb. 26: Abdeckung anbringen

- 26) Die Behältermulde (1) montieren und mit den Muttern (2) (M5/SW8) befestigen.
- 27) Silikon-Metall-Puffer (3) (M6/SW10) anbringen und den Behälterdeckel ausrichten.
- 28) Funktionalität des Behälterdeckelschalters überprüfen (hörbares Klick-Geräusch beim Öffnen/Schließen).
- 29) Behältermulde (1) soll mit dem Sockel in einer Flucht sein.

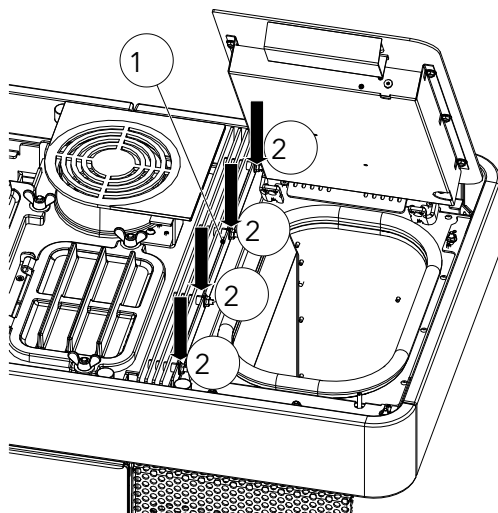
- 30) Konvektionslamellen rechts (1) montieren.
- 31) Die vier Muttern (2) (M6/SW10) festdrehen.

- 32) Obere Abdeckung (1) anbringen und die beiden Schrauben (2) (TX25) befestigen.

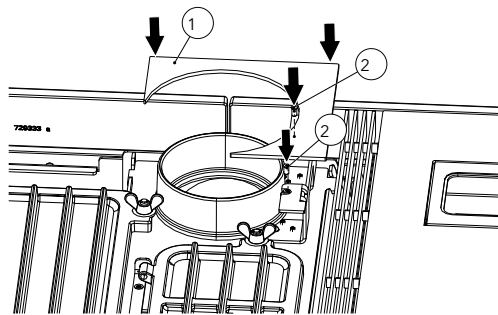
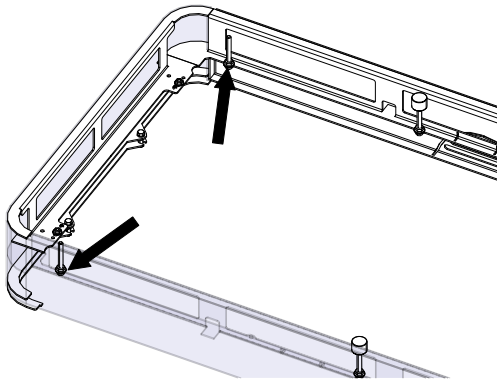

- 33) Die linken zwei Siliconpuffer (1) und die obere Mutter mit Flansch (M6) entfernen.



Abb. 27: Puffer entfernen



Abb. 28: Konvektionslamelle links montieren

- 34) Konvektionslamelle (1) links einsetzen und mit den beiden Muttern (2) (M6/SW10) montieren.
 35) Silicon-Metall-Puffer (3) (M6/SW10) montieren und korrekt ausrichten.

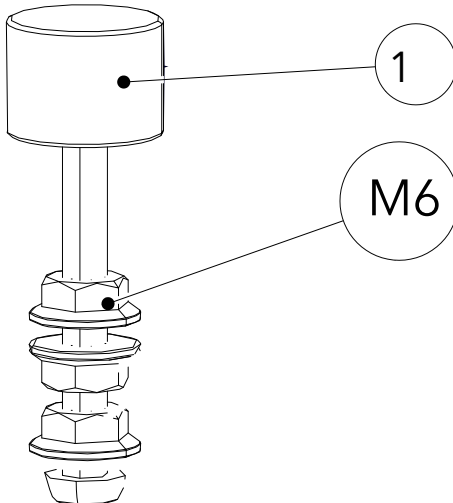
36) Glaseinlegedeckel einlegen.

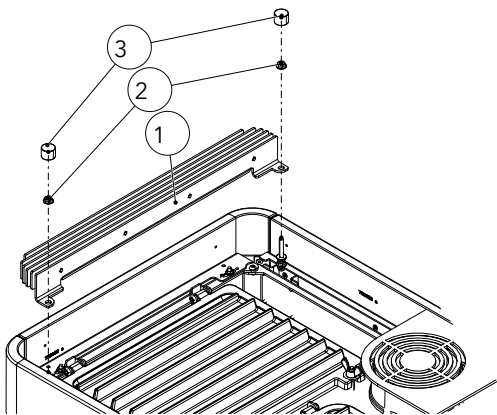

Abb. 29: Glaseinlegedeckel einlegen

Contents

1	General.....	19
2	Installation	20
2.1	Mounting complete steel side cladding.....	20

1 General

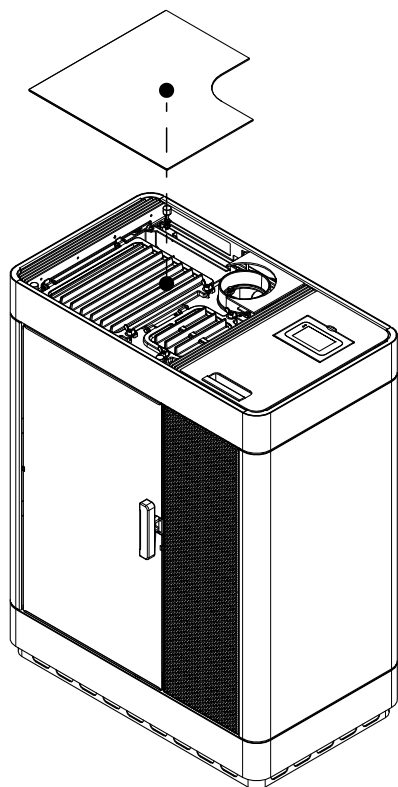
Steel cladding

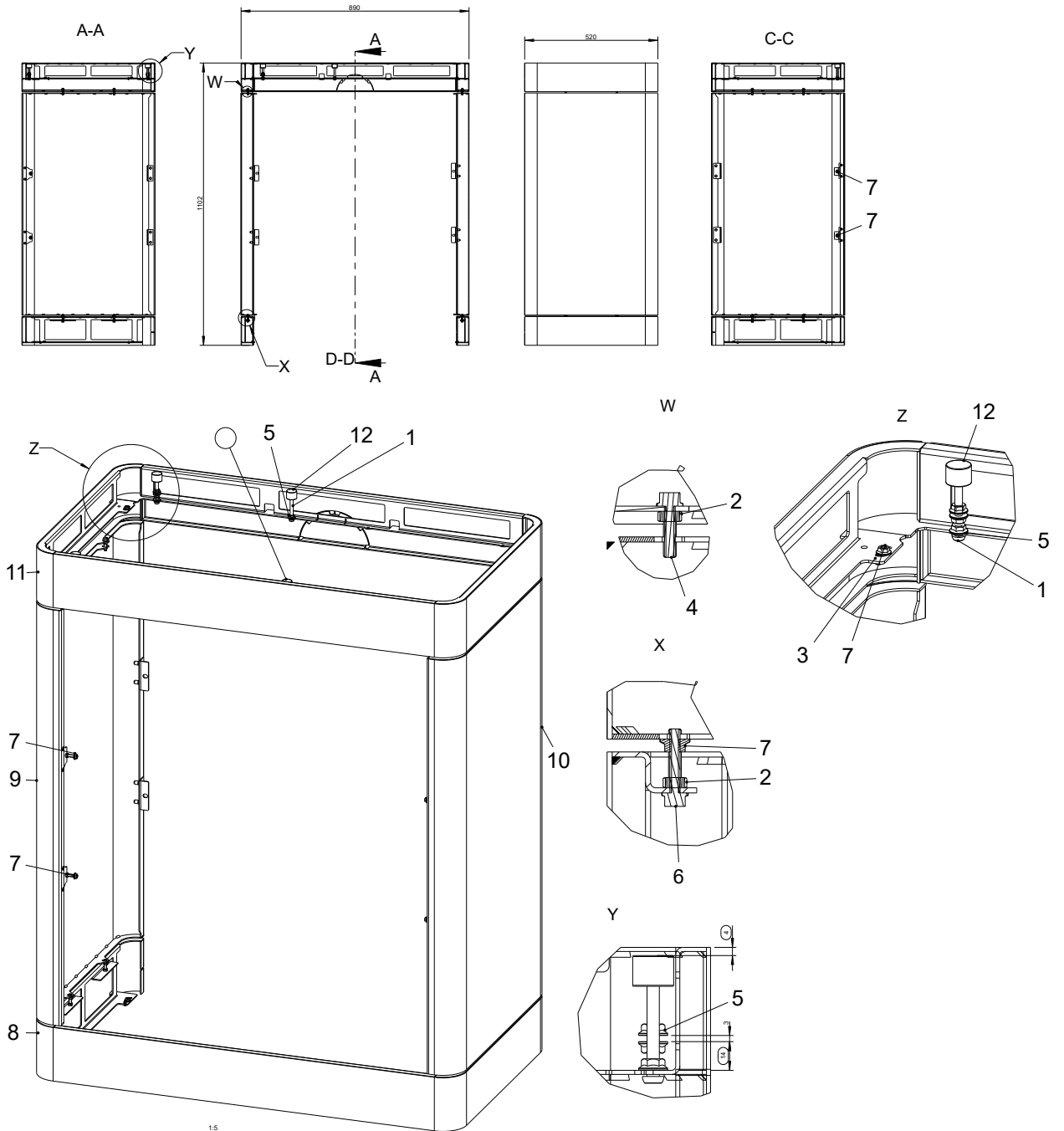

Item	Qty	Article	Article no.
1	4	Oval-head screws with hexagon socket M6x50 ISO7380	718043-92
2	8	Hexagon nut M5 DIN934	718148-92
3	8	Grub screw with hexagon socket + eyebolts M5x8 DIN916	718199-92
4	4	Taptite hex bolt M5x20 DIN7500D	718230-92
5	8	Hexagon nut with flange M6 DIN6923	718740-92
6	4	Taptite hex bolt M5x25 DIN7500D	718923-92
7	16	Hexagon nut with flange M5 DIN6923	723916-92
8	1	Base cladding	733144-29
9	1	Cladding left	733145
10	1	Cladding right	733146

2 Installation

2.1 Mounting complete steel side cladding

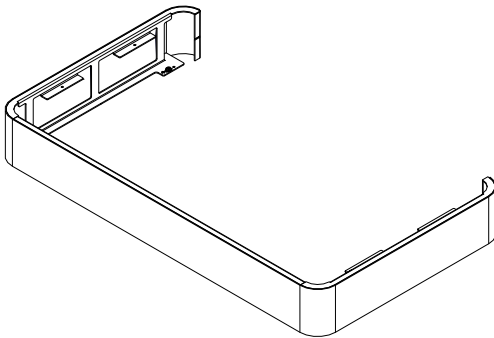

Fig. 1: Removing base from packaging

- 1) Remove bottom base from the packaging.
⇒ The base is preassembled.

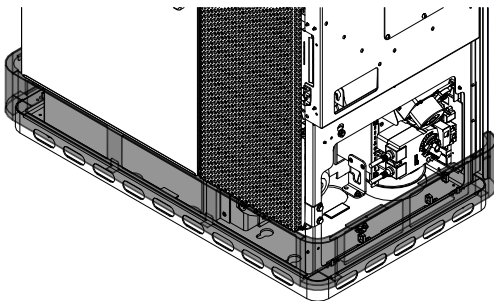

Fig. 2: Mounting the base

- 2) Mount the base.

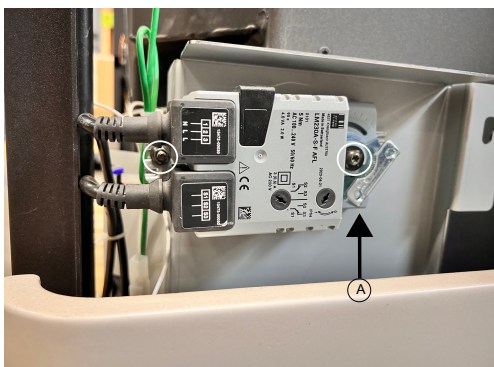

Fig. 3: Detaching riddling grate motor

- 3) Detaching riddling grate motor.
⇒ Observe the position of the riddling grate motor (A). If the position is different to the one illustrated, contact our dealer.
- 4) Undo the two screws and remove riddling grate motor.

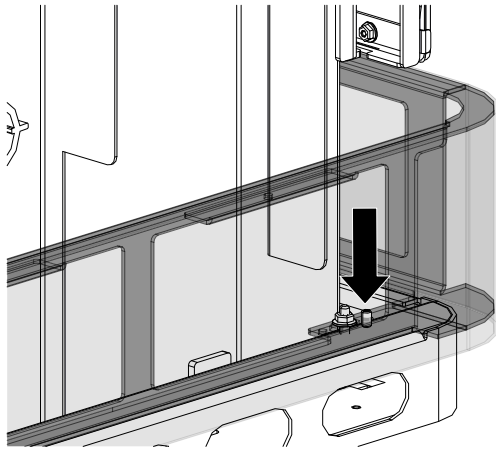

Fig. 4: Adjusting the base

- 5) Align the base with the adjusting screw on the side on the hybrid stove.

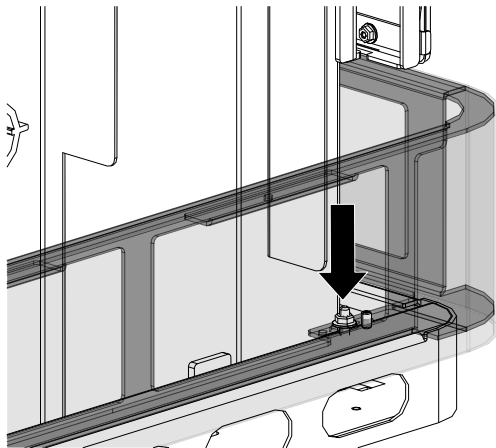

Fig. 5: Tightening nuts

- 6) Tighten the four nuts on the sides.

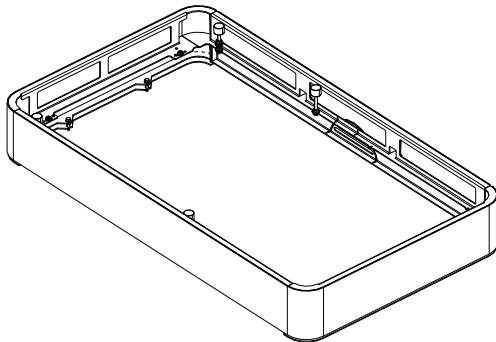

Fig. 6: Mounting the base at the top

- 7) Remove upper base from the packaging.
⇒ The base is preassembled.

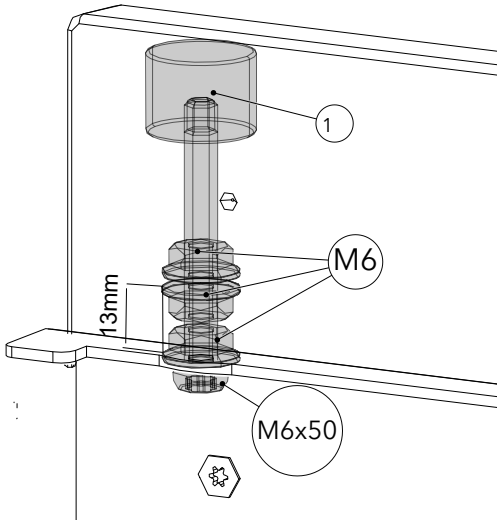

Fig. 7: Distance to 13 mm

8) Check and adjust the distance to 13 mm.

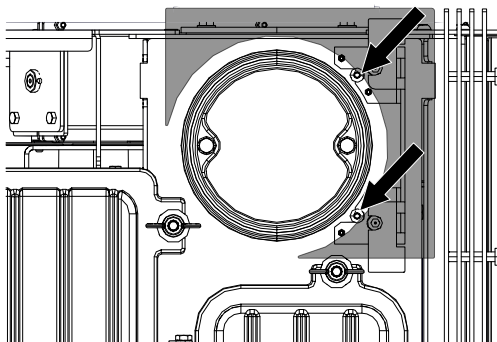

Fig. 8: Undoing the screws and removing the cover (slots).

9) Loosen both screws (TX25) and remove the cover (slots).

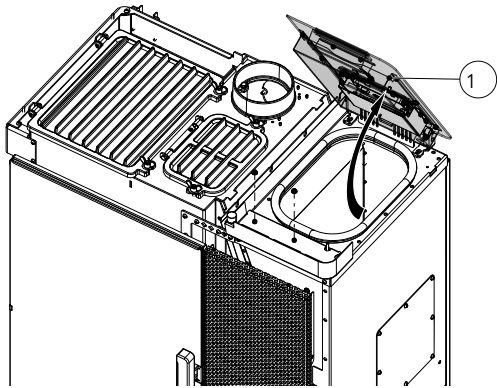

Fig. 9: Opening the hopper lid

10) Completely open the hopper lid (1).

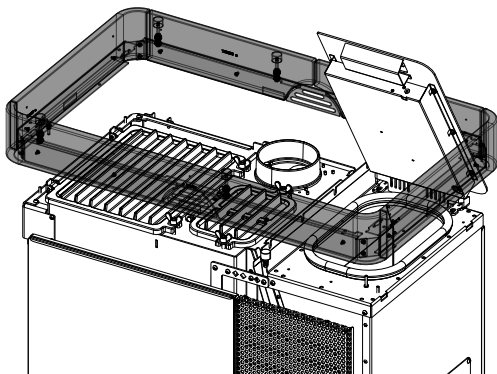
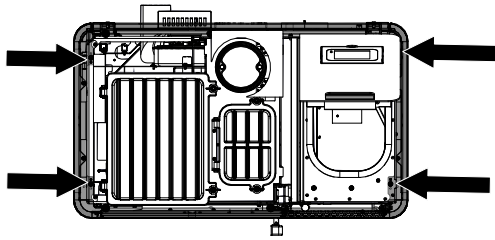

Fig. 10: Attaching the upper ring

11) Mount the upper ring. Take care that the hopper lid is not scratched.



- 12) Align the upper ring with the grub screw M5x8 (1).
- 13) Mount and tighten the four nuts with flange M5 (2).

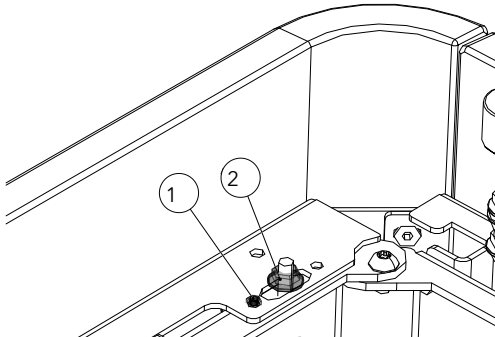

Fig. 11: Aligning the upper ring

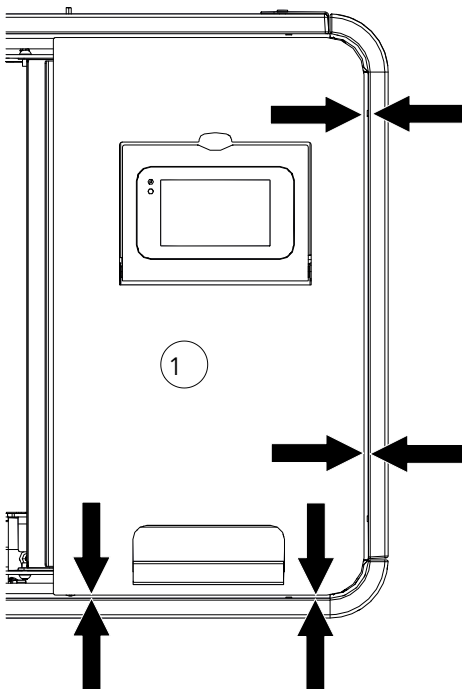

Fig. 12: Aligning the upper ceramic frame

- 14) Make sure that the hopper lid can open and close without any problems.

15) Remove the rear trims.

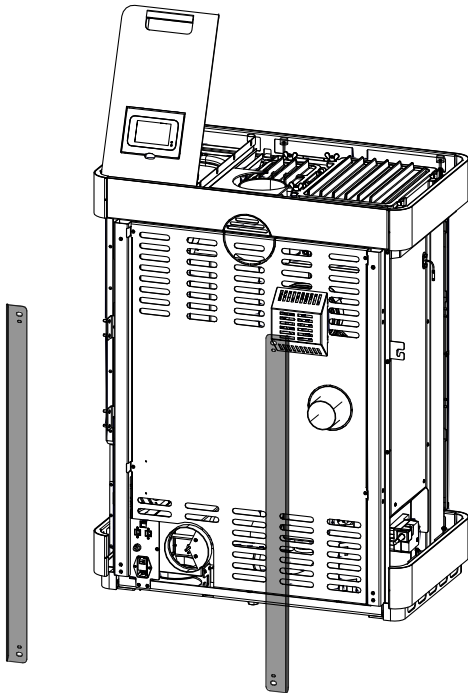

Fig. 13: Removing trims

16) Fasten the left-hand side cladding to the hybrid stove from the rear.

17) If the holes do not fit, the lower base must be aligned with the nuts so that the left-hand side cladding can be mounted.

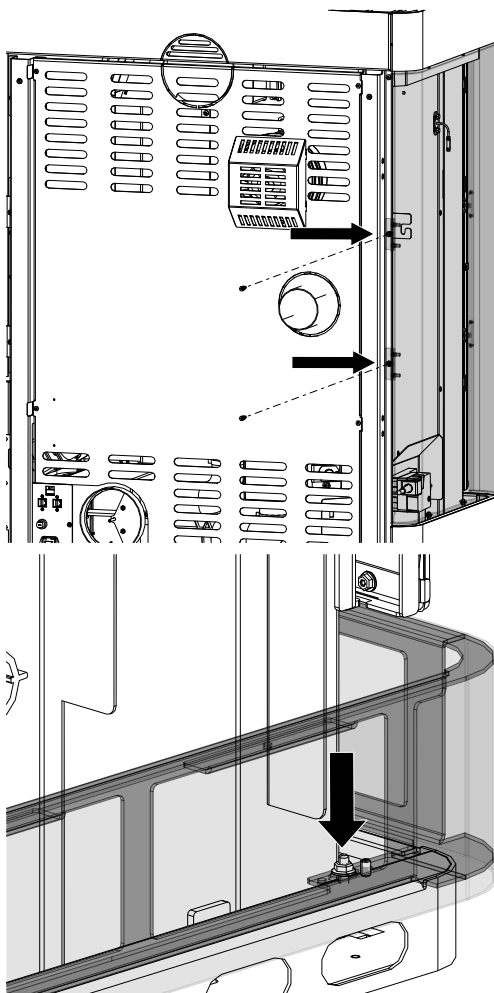

Fig. 14: Fastening the side steel cladding from the rear

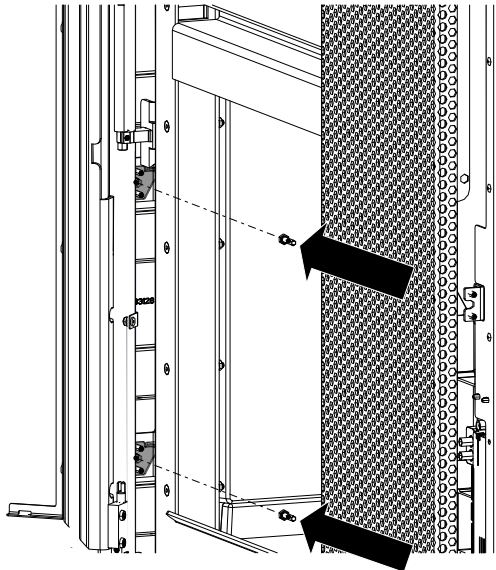

Fig. 15: Opening the door and fastening the steel cladding

18) Open door and from the inside fasten the side steel cladding.

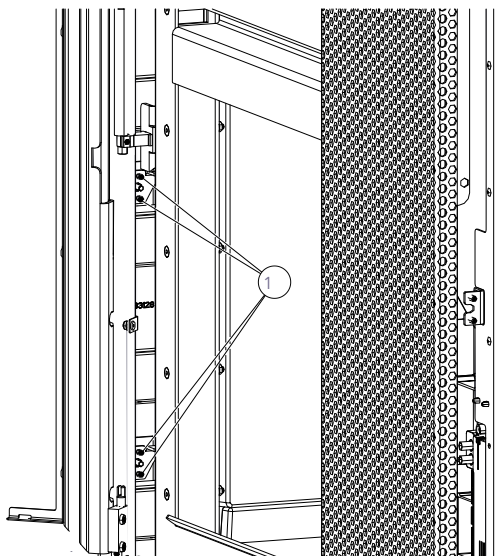

Fig. 16: Aligning steel cladding

19) The steel cladding can be aligned with the door using the adjusting screws (1).

⇒ Adjust the adjusting screws so that the door can easily be opened without it touching the side steel cladding.

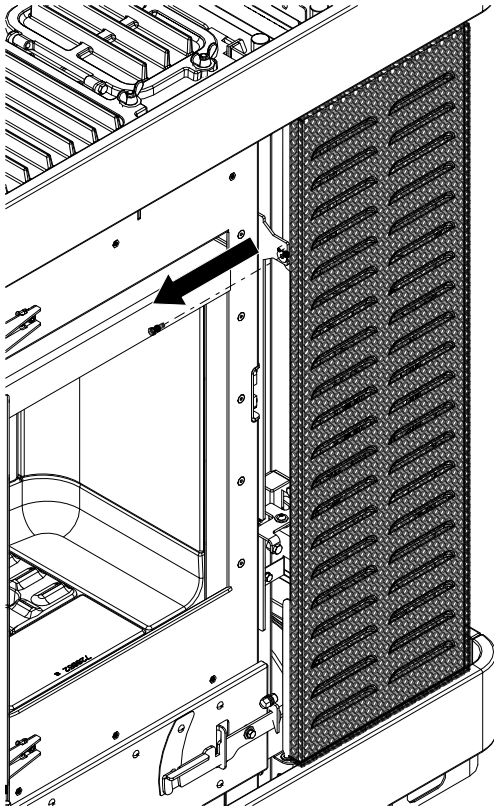

Fig. 17: Removing the front cladding

- 20) Loosen the screw on the front cladding and remove the cladding.

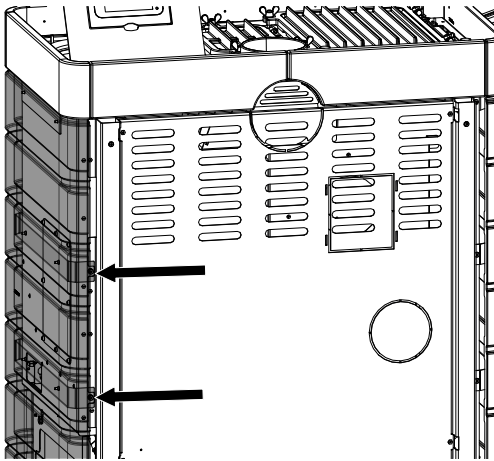

Fig. 18: Fastening the side cladding

- 21) Attach the right-hand side cladding as already described and fasten at the rear.

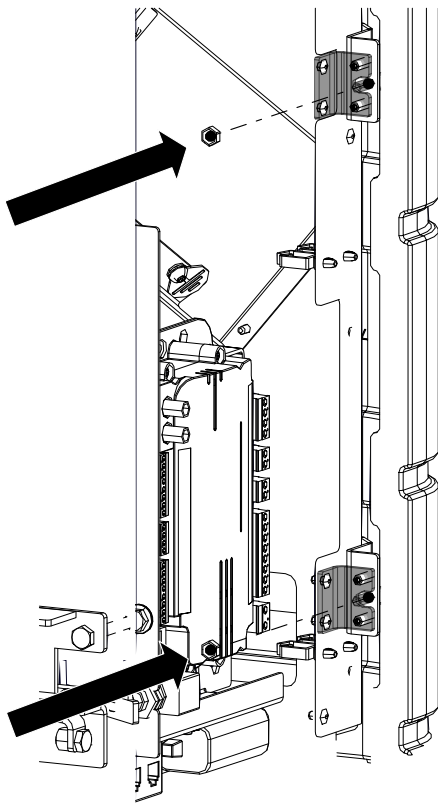

Fig. 19: Fastening and aligning the side cladding

22) Fasten the right-hand side cladding at the front and align using adjusting screws.

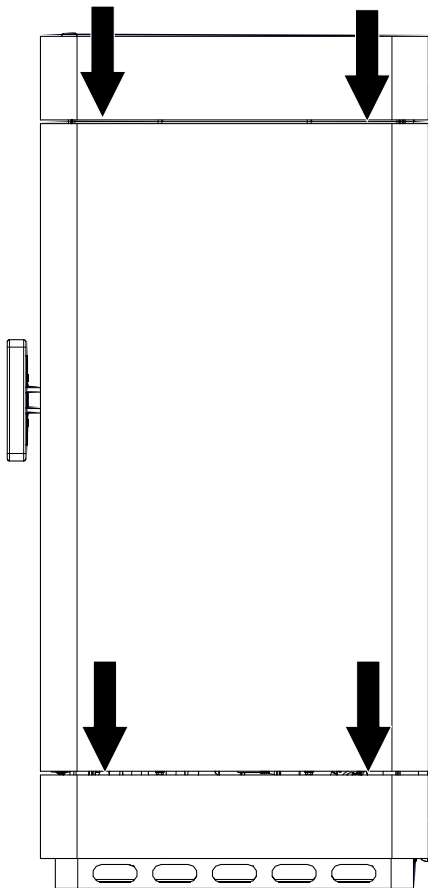

Fig. 20: Checking the spacings

23) Finally, check that the steel cladding has the same spacing on all sides.

⇒ If necessary use the adjusting screws to readjust the spacings.

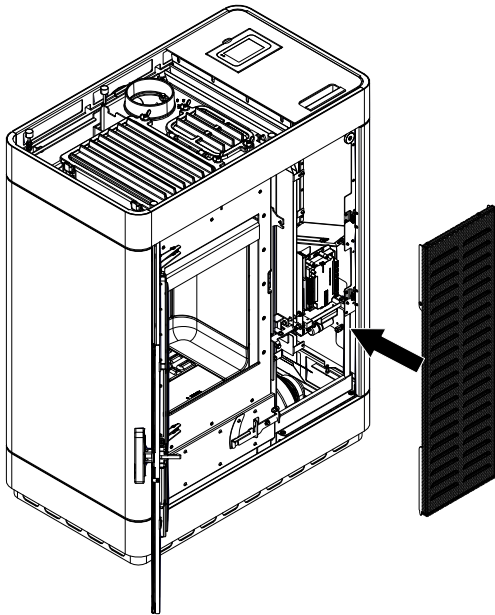

Fig. 21: Placing the front cladding on

24) Put on the front cladding and loosely turn in the screws.

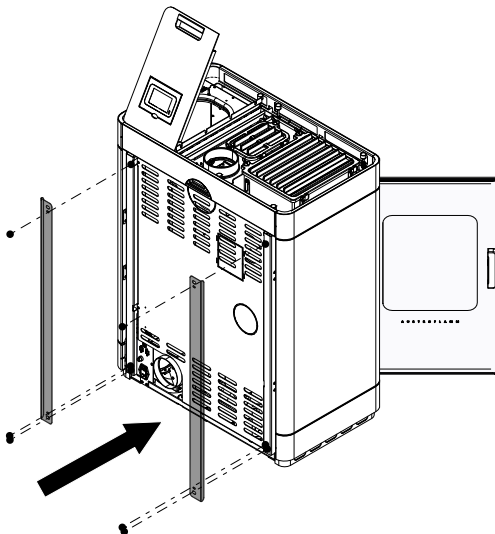

Fig. 22: Mounting the trims

25) Remount the two trims at the back.

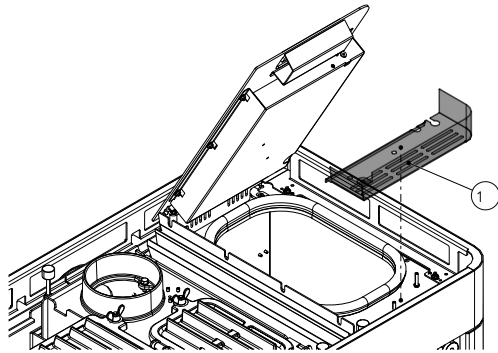

Fig. 23: Mounting the hopper trough

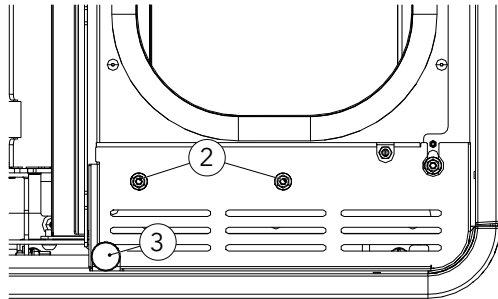

Fig. 24: Attaching the nuts and silicon metal buffer

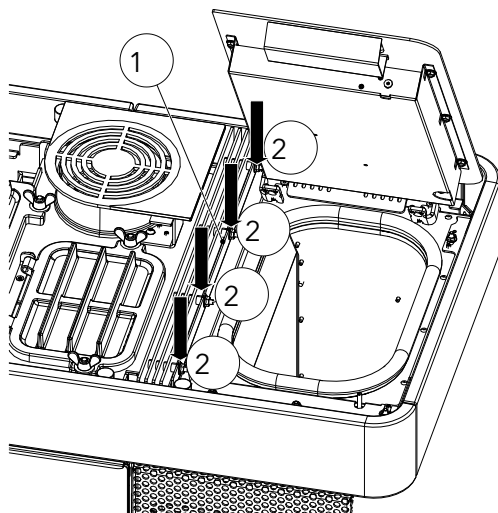

Fig. 25: Mounting convection lamella right

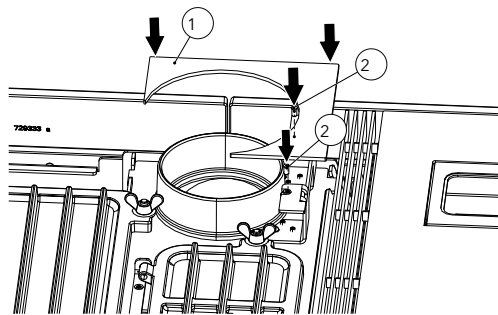
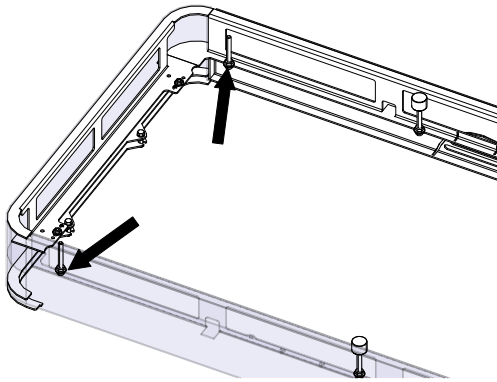

Fig. 26: Attaching cover

- 26) Mount the hopper trough (1) and fasten with the two nuts (2) (M5/SW8).
- 27) Attach silicon metal buffer (3) (M6/SW10) and align the hopper cover.
- 28) Check the functioning of the hopper lid switch (audible click sound when opening/closing).
- 29) Hopper trough (1) should be aligned with the base.

- 30) Mounting convection lamella right (1).
- 31) Tighten the four nuts (2) (M6/SW10).

- 32) Attach top cover (1) and fasten the two screws (2) (TX25).



- 33) Remove the two left-hand silicon buffers (1) and the upper nut with flange (M6).

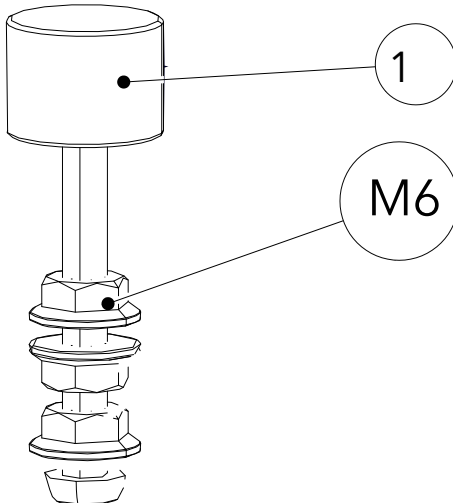
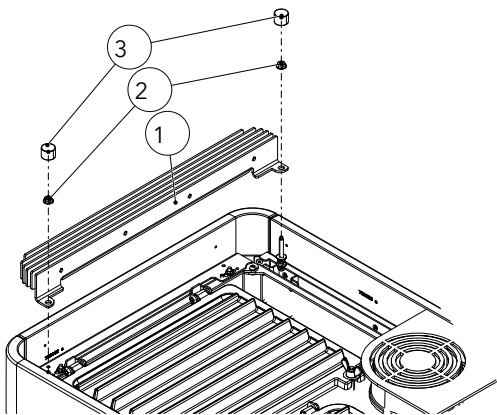

Fig. 27: Removing buffers



- 34) Insert convection lamella (1) left and mount with the two nuts (2)(M6/SW10).
- 35) Mount and correctly align the silicon metal (3) buffer (M6/SW10).

Fig. 28: Mounting the convection lamella on the left

36) Insert window inlay cover.

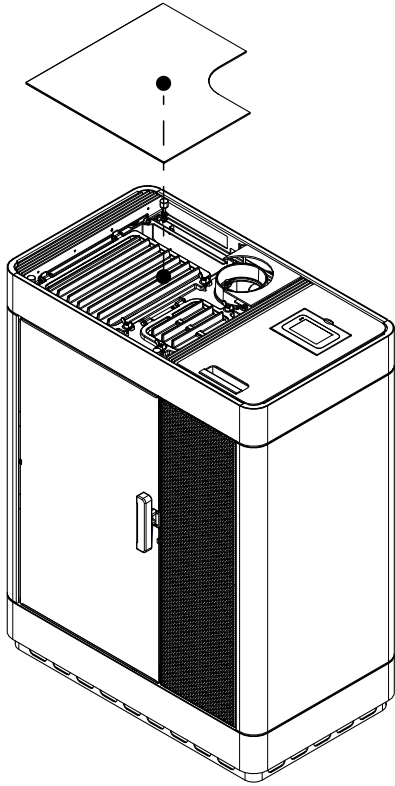

Fig. 29: Inserting the window inlay cover

Sommaire

1	Généralités	33
2	Montage.....	34
2.1	Installer l'habillage latéral en acier.....	34

1 Généralités

Habillage en acier

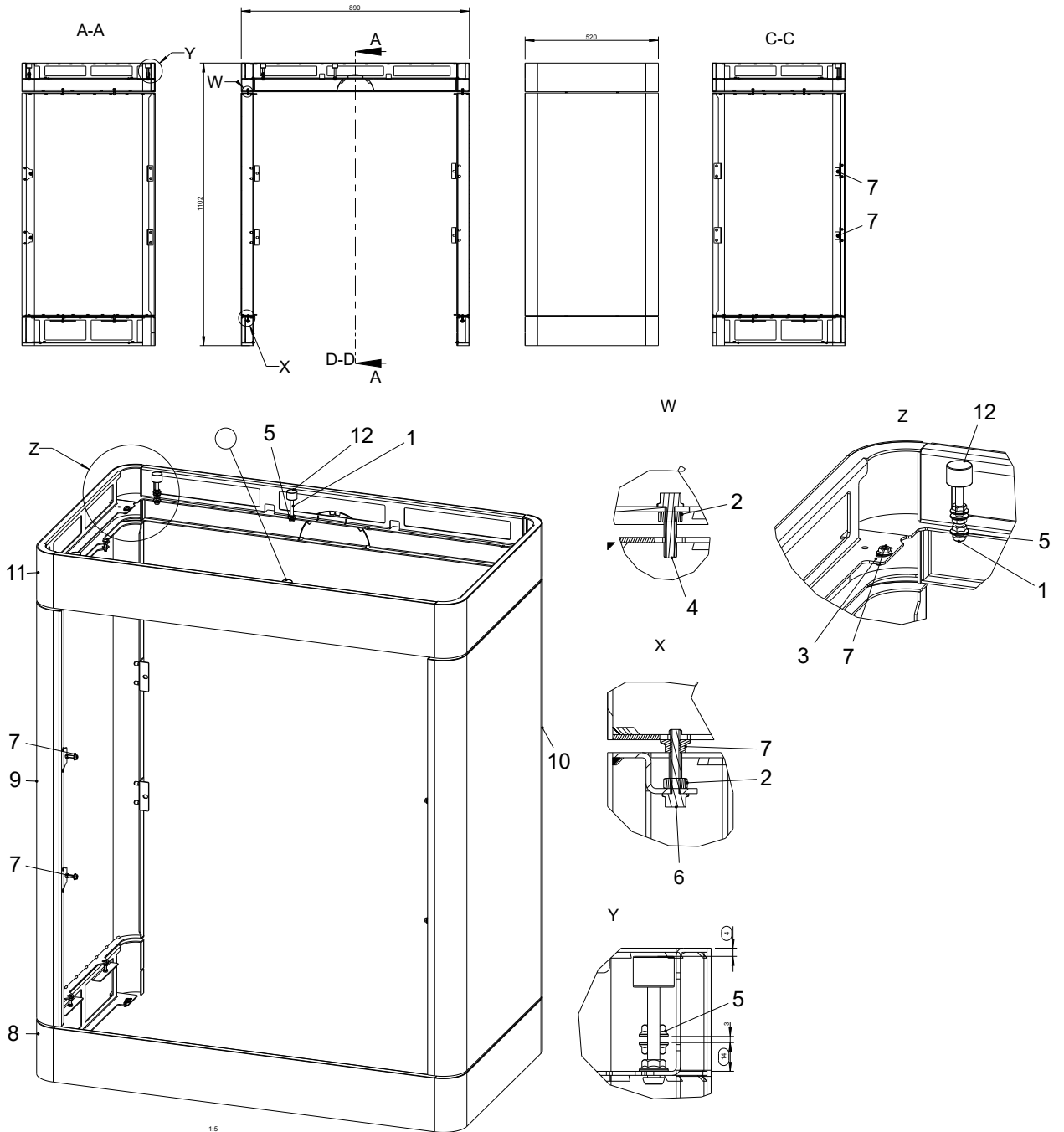

Pos.	Quantité	Article	Article n°
1	4	Vis à tête bombée 6 pans creux M6x50 ISO7380	718043-92
2	8	Écrou hexagonal M5 DIN934	718148-92
3	8	Vis sans tête 6 pans creux bout cuvette M5x8 DIN916	718199-92
4	4	Vis à tête hexagonale Taptite M5x20 DIN7500D	718230-92
5	8	Écrou hexagonal à embase M6 DIN6923	718740-92
6	4	Vis à tête hexagonale Taptite M5x25 DIN7500D	718923-92
7	16	Écrou hexagonal à embase M5 DIN6923	723916-92
8	1	Ajuster le socle de l'habillage	733144-29
9	1	Habillage gauche	733145
10	1	Habillage droit	733146

2 Montage

2.1 Installer l'habillage latéral en acier

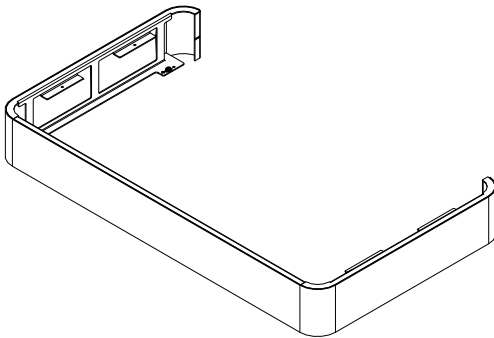

Fig. 1: Enlever le socle de l'emballage

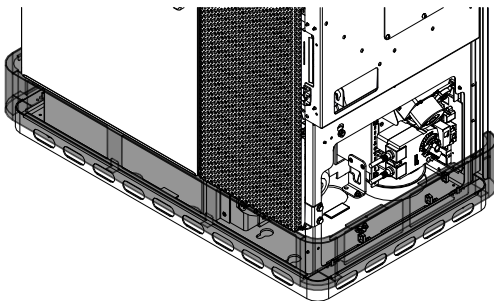

Fig. 2: Installer le socle

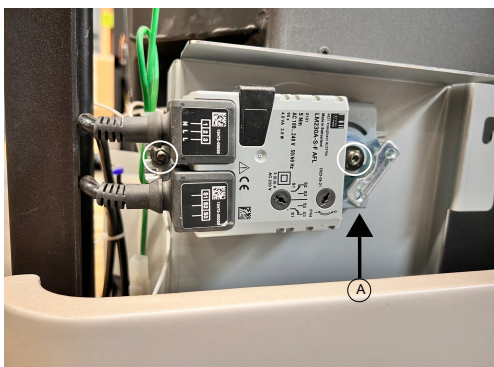

Fig. 3: Déposer le moteur de la grille basculante

- 1) Enlever le socle inférieur de l'emballage.
 - ⇒ Le socle est préassemblé.
- 2) Installer le socle.
- 3) Déposer le moteur de la grille basculante.
 - ⇒ Vérifiez la position du moteur de la grille basculante (A). Si la position est différente de celle de l'illustration, contactez notre revendeur spécialisé.
- 4) Dévisser les deux vis et enlever le moteur de la grille basculante.

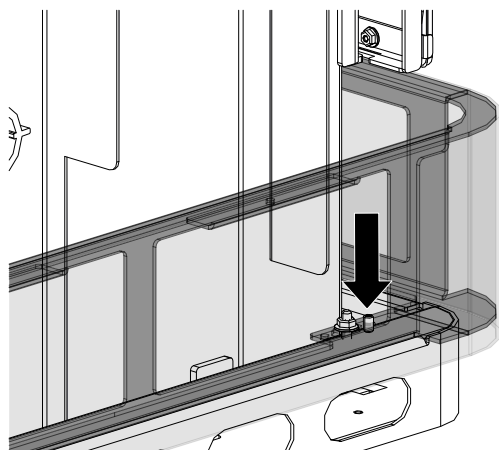

Fig. 4: Ajuster le socle

- 5) Ajuster le socle à l'aide de la vis de réglage sur le côté du poêle mixte.

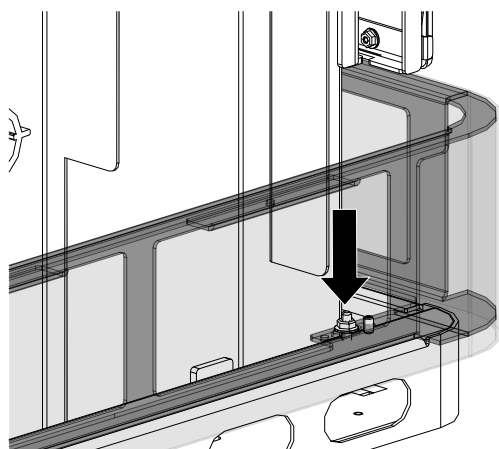

Fig. 5: Visser les écrous à fond

- 6) Visser à fond quatre écrous latéraux.

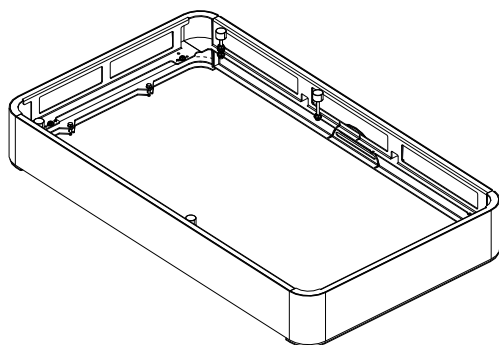

Fig. 6: Installer le socle en haut

- 7) Enlever le socle supérieur de l'emballage.
⇒ Le socle est préassemblé.

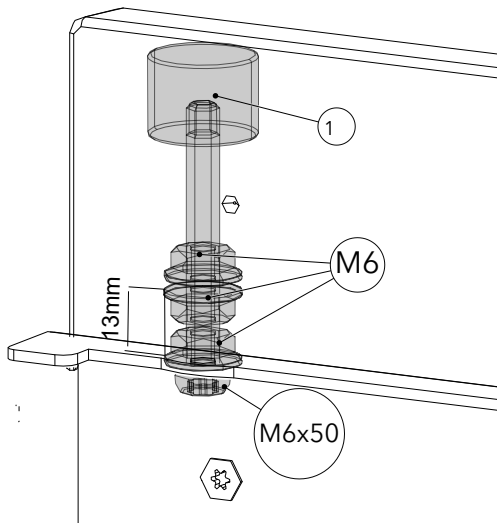

Fig. 7: Espacement de 13 mm

8) Vérifier et ajuster l'espacement sur 13 mm.

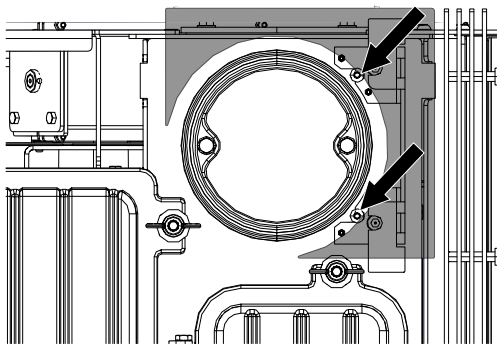

Fig. 8: Dévisser les vis et enlever le recouvrement

9) Desserrer les deux vis (TX25) et enlever le recouvrement (trous ovales).

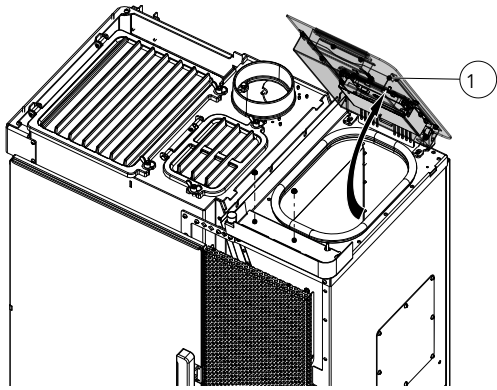

Fig. 9: Ouvrir le couvercle de réservoir

10) Ouvrir complètement le couvercle du réservoir (1).

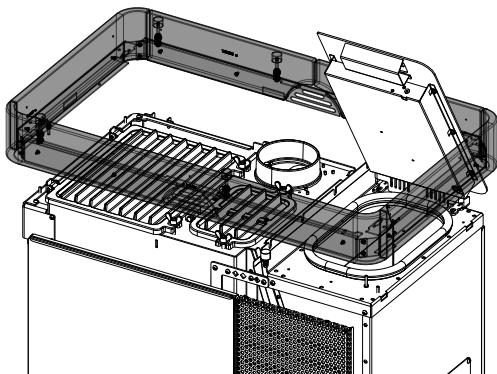
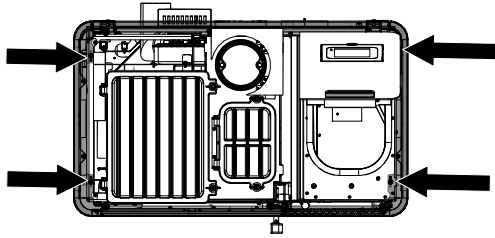

Fig. 10: Poser l'anneau supérieur

11) Poser l'anneau supérieur. Veiller à ne pas rayer le couvercle du réservoir.



- 12) Ajuster l'anneau supérieur avec de tige filetée M5x8 (1).
- 13) Poser les quatre écrous à embase M5 (2) et les visser à fond.

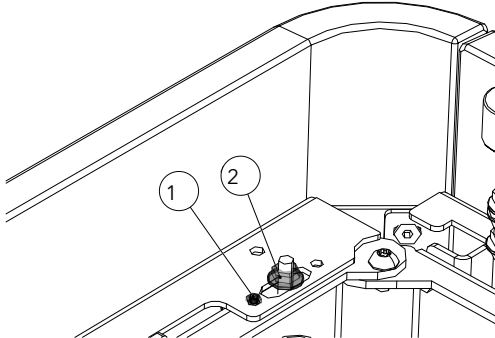

Fig. 11: Ajuster l'anneau supérieur

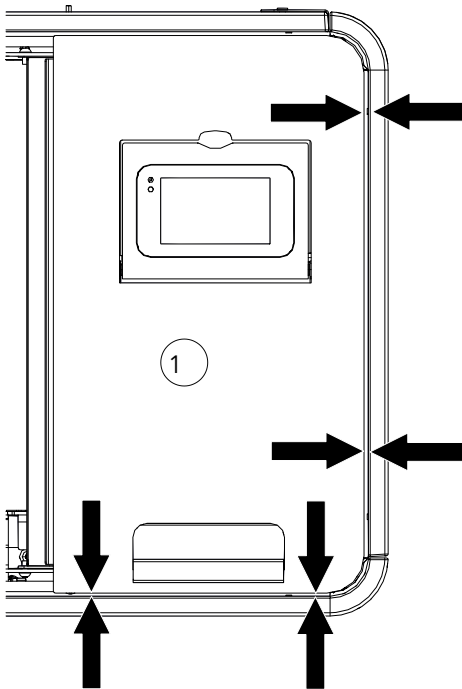

Fig. 12: Ajuster le cadre céramique supérieur

- 14) Veiller à ce que le couvercle du réservoir puisse s'ouvrir et se fermer sans problème.

15) Déposer les parements arrière.

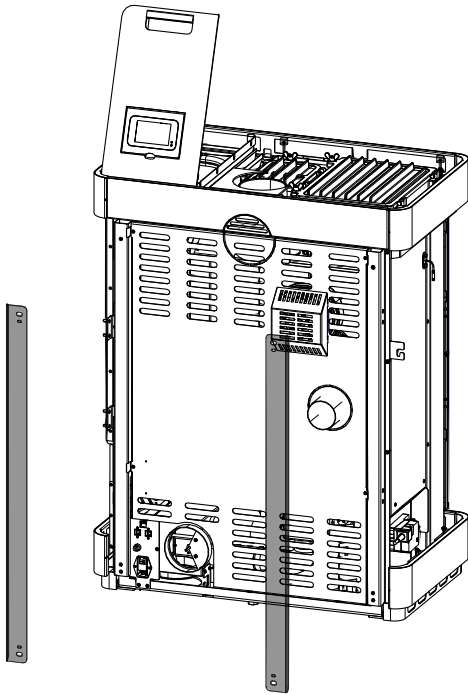

Fig. 13: Déposer les parements

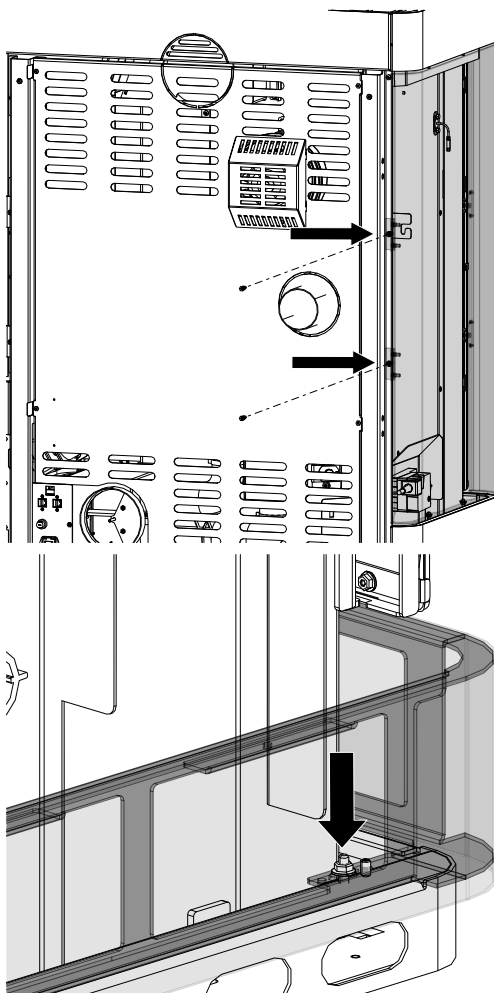

Fig. 14: Fixer l'habillage en acier par l'arrière

- 16) Fixer l'habillage latéral gauche au poêle mixte par l'arrière.
- 17) Si les trous ne correspondent pas, ajuster le socle inférieur avec les écrous de sorte que l'habillage latéral gauche puisse être fixé.

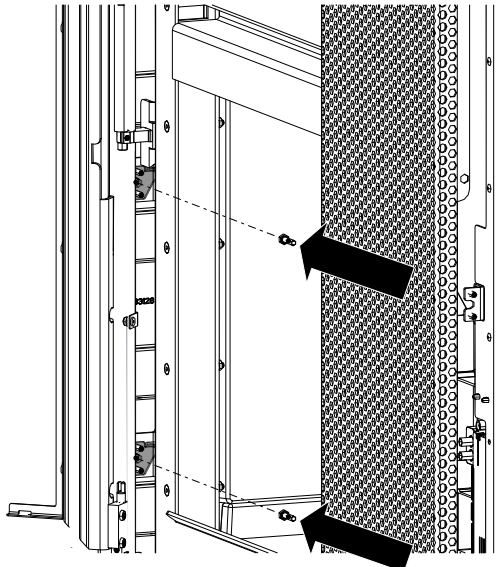

Fig. 15: Ouvrir la porte et fixer l'habillage en acier

18) Ouvrir la porte et fixer l'habillage latéral en acier de l'intérieur.

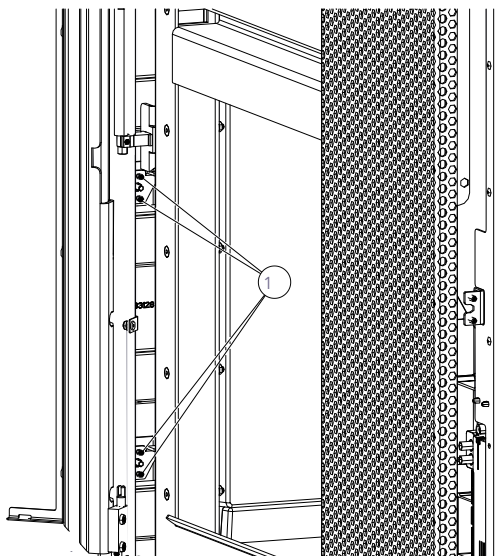

Fig. 16: Ajuster l'habillage en acier

19) Les vis de réglage (1) permettent d'ajuster l'habillage en acier avec la porte.

- ⇒ Ajustez les vis de réglage de sorte que la porte puisse s'ouvrir facilement sans toucher l'habillage en acier.

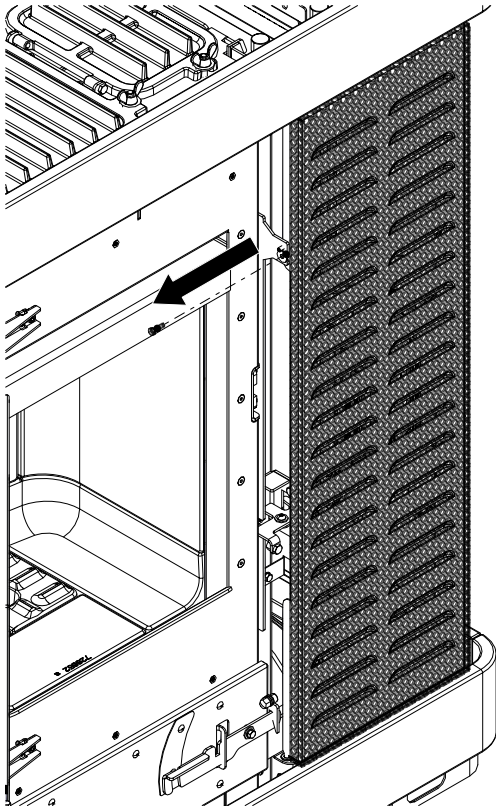

Fig. 17: Enlever le capot avant

20) Dévisser les vis de l'habillage avant et enlever l'habillage.

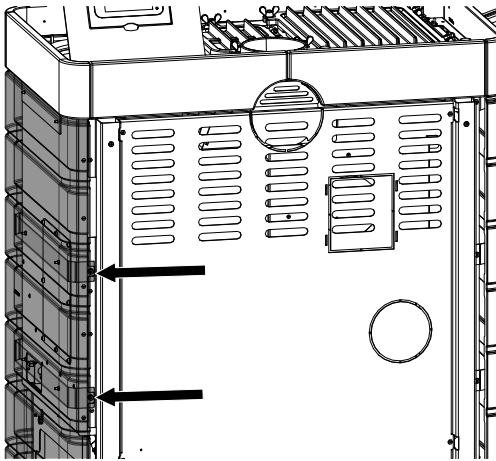

Fig. 18: Fixer le capot latéral

21) Poser le capot latéral droit comme décrit précédemment et le fixer à l'arrière.

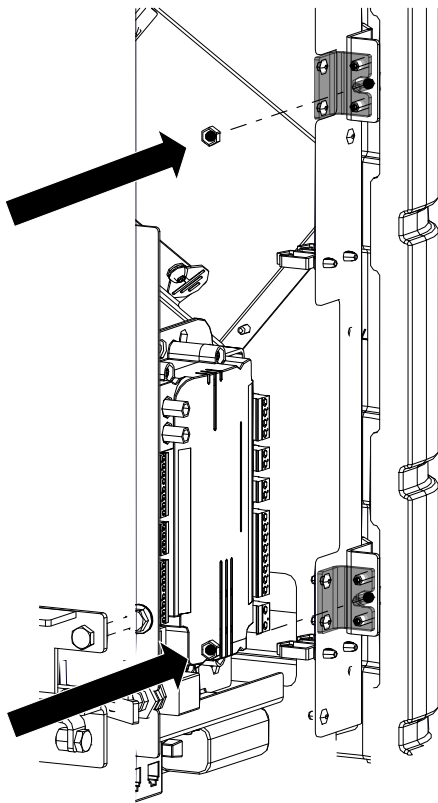

Fig. 19: Fixer et ajuster le capot latéral

22) Fixer le capot latéral droit à l'avant et l'ajuster avec les vis de réglage.

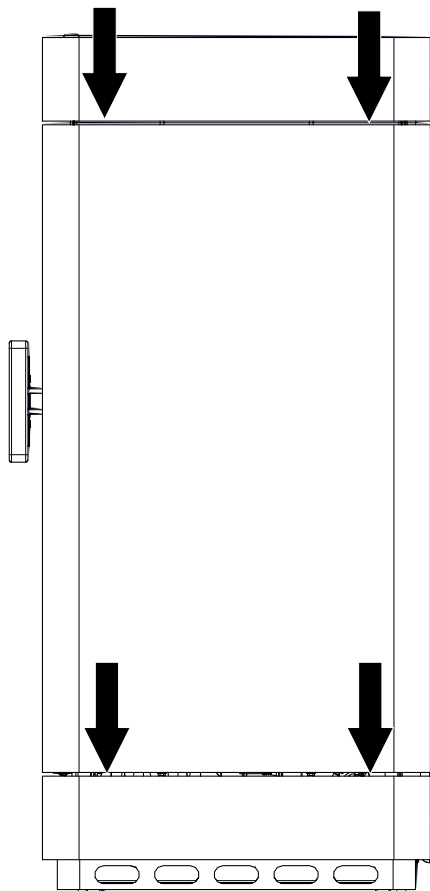

Fig. 20: Contrôler les espacements

23) Pour finir, contrôlez si l'espacement de l'habillage en acier est le même de tous les côtés.

⇒ Au besoin, réajuster les espacements avec les vis de réglage.

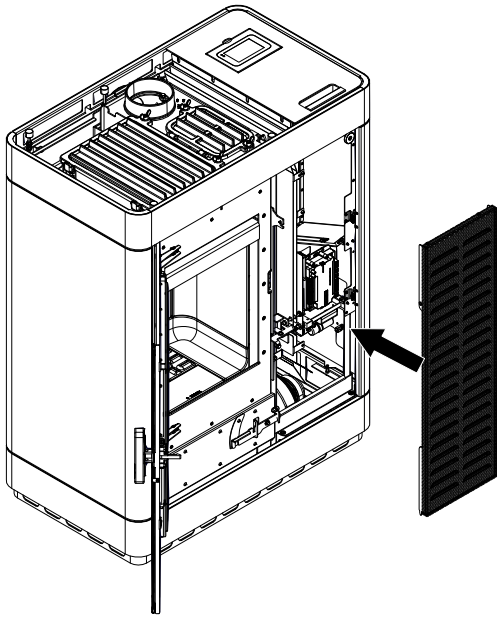

Fig. 21: Poser l'habillage

24) Poser l'habillage avant et visser légèrement les vis.

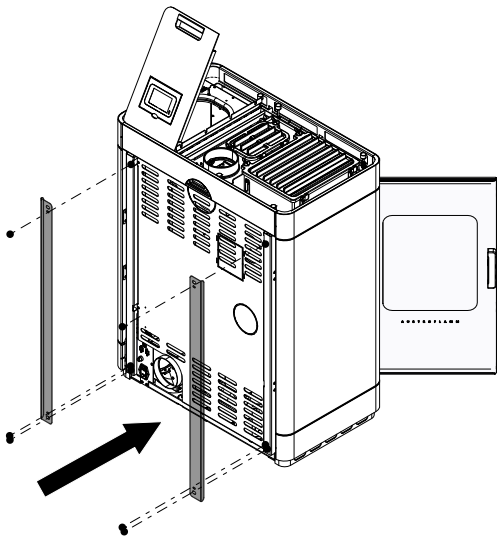

Fig. 22: Remettre les parements en place

25) Remettre en place les deux parements arrière.

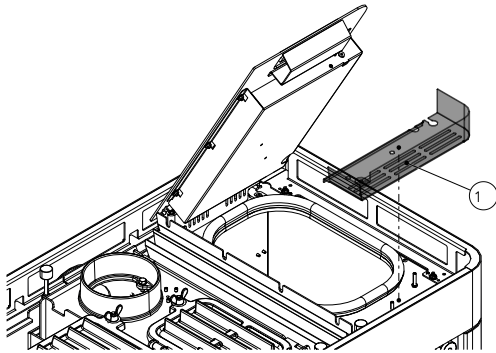

Fig. 23: Installer le réceptacle du réservoir

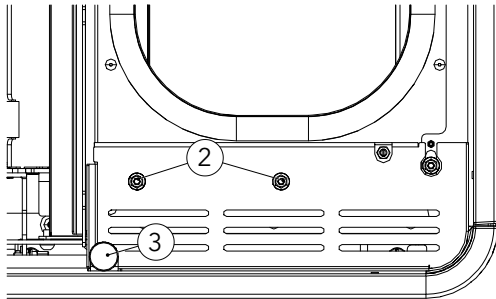

Fig. 24: Poser les écrous et les butoirs silicone/métal

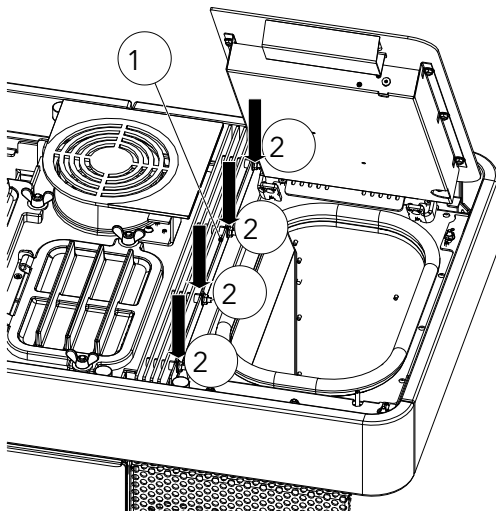

Fig. 25: Installer les lamelles de convection droites

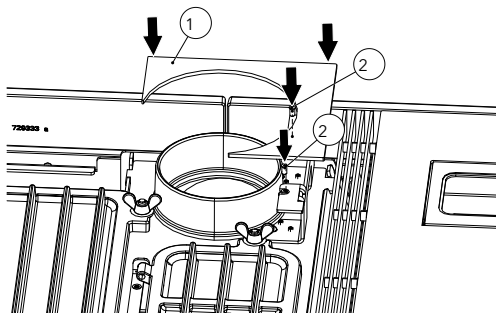

Fig. 26: Poser le recouvrement

- 26) Installer le réceptacle du réservoir (1) et le fixer avec les écrous (2) (M5/OC8).
- 27) Poser les butoirs silicone/métal (3) (M6/OC10) et ajuster le couvercle du réservoir.
- 28) Contrôler le bon fonctionnement du commutateur du couvercle du réservoir (clac audible à l'ouverture et à la fermeture).
- 29) Le réceptacle du réservoir (1) doit être aligné avec le socle.

- 30) Installer les lamelles de convection droites (1).
- 31) Visser à fond les quatre écrous (2) (M6/OC10).

- 32) Poser le recouvrement supérieur (1) et fixer les deux vis (2) (TX25).

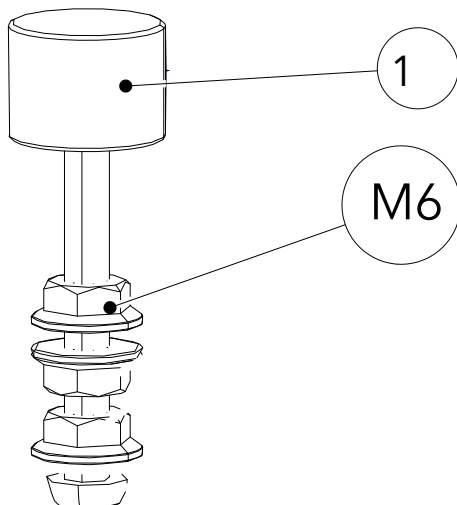
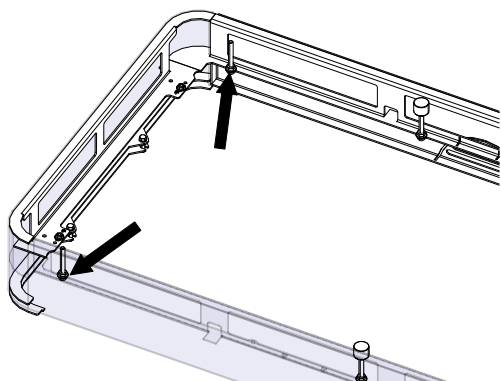

Fig. 27: Enlever les butoirs

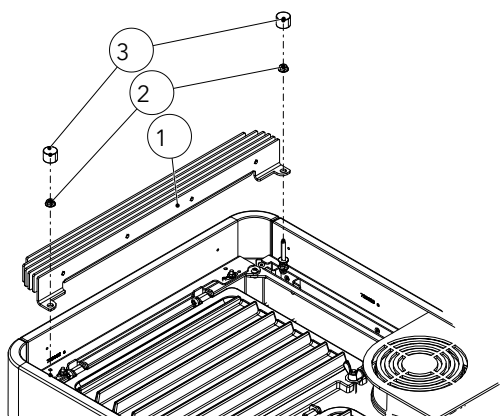

Fig. 28: Installer les lamelles de convection gauches

33) Enlever les deux butoirs en silicone de gauche (1) et l'écrou à embase (M6) supérieur.

34) Mettre en place les lamelles de convection (1) gauches et les fixer avec les deux écrous (2) (M6/OC10).

35) Installer les butoirs silicone/métal (3) (M6/OC10) et les ajuster correctement.

36) Poser le couvercle en verre.

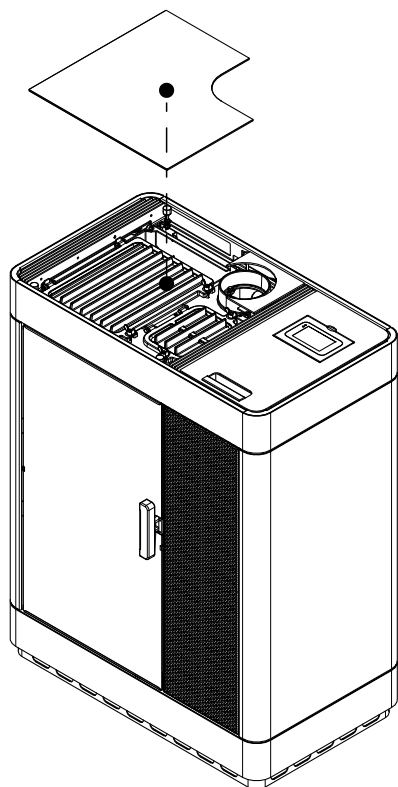

Fig. 29: Poser le couvercle en verre

Indice

1	Generalità	47
2	Montaggio	48
2.1	Montaggio del rivestimento in acciaio	48

1 Generalità

Rivestimento in acciaio

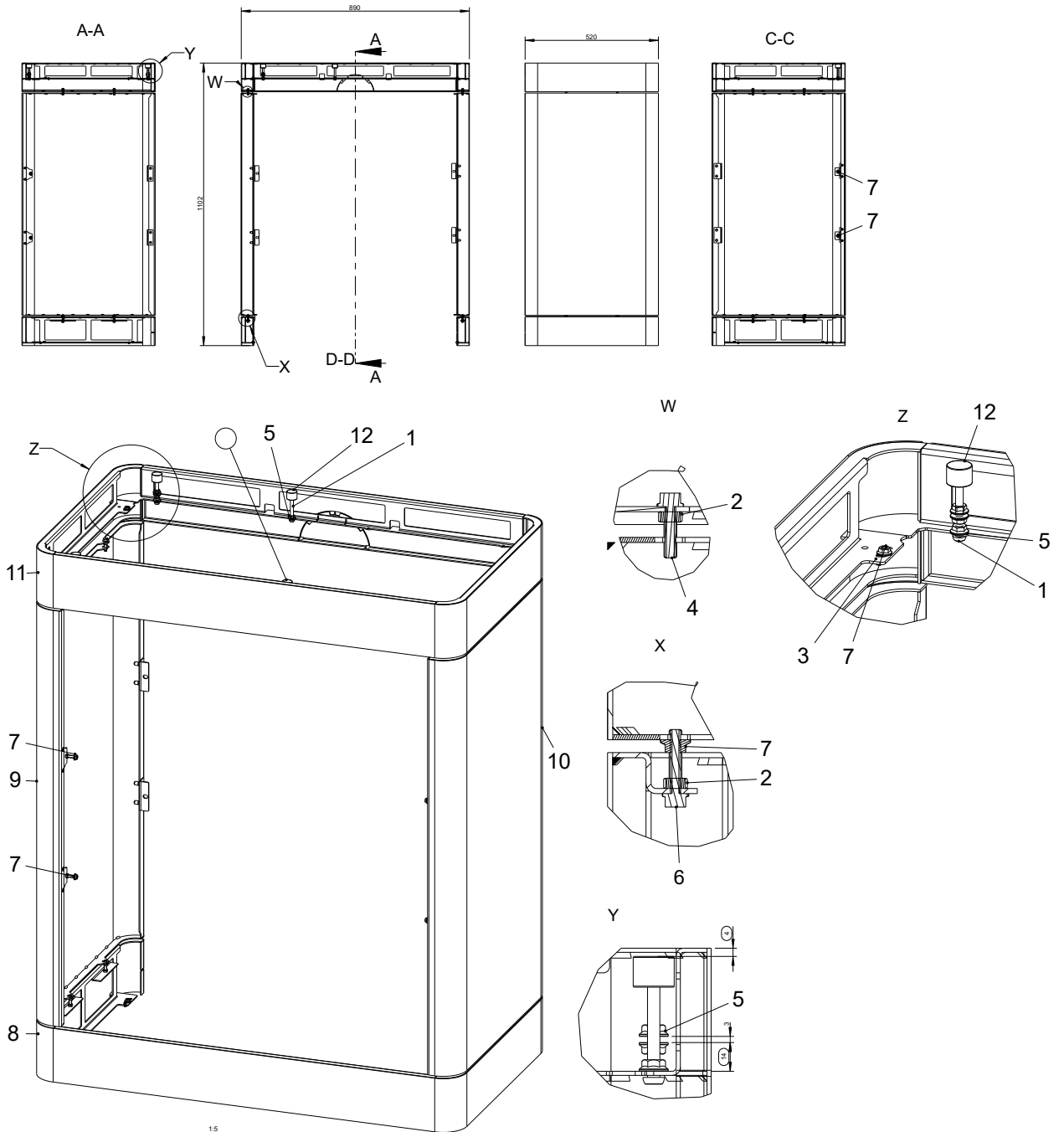

1.5

Pos.	Pz.	Articolo	N. art.
1	4	Viti a testa bombata con esagono incassato M6x50 ISO7380	718043-92
2	8	Dado esagonale M5 DIN934	718148-92
3	8	Perno filettato con esagono incassato e viti ad anello M5x8 DIN916	718199-92
4	4	Taptite Vite a testa esagonale M5x20 DIN7500D	718230-92
5	8	Dado esagonale con flangia M6 DIN6923	718740-92
6	4	Taptite Vite a testa esagonale M5x25 DIN7500D	718923-92
7	16	Dado esagonale con flangia M5 DIN6923	723916-92
8	1	Allineamento del rivestimento della base	733144-29
9	1	Rivestimento sx	733145
10	1	Rivestimento dx	733146

2 Montaggio

2.1 Montaggio del rivestimento in acciaio

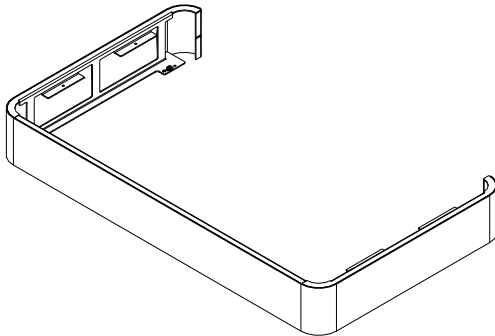

Fig. 1: Rimozione della base dall'imballaggio

- 1) Estrarre la base inferiore dall'imballaggio.
⇒ La base è pre-assemblata.

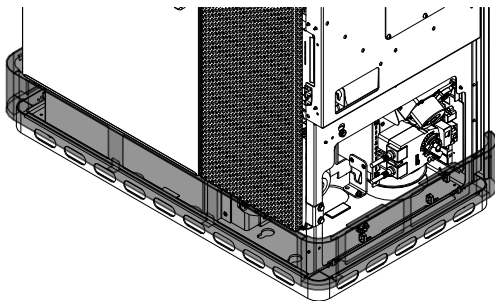

Fig. 2: Montaggio della base

- 2) Montare la base.

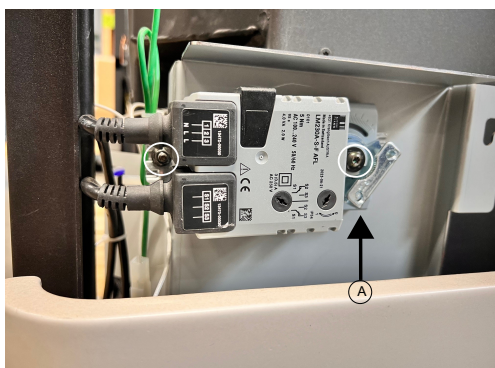

Fig. 3: Smontaggio del motore della griglia ribaltabile

- 3) Smontare il motore della griglia ribaltabile.
⇒ Prestare attenzione alla posizione del motore della griglia ribaltabile (A). Se la posizione non è quella indicata in figura, contattare il nostro rivenditore specializzato.
- 4) Allentare le due viti e rimuovere il motore della griglia ribaltabile.

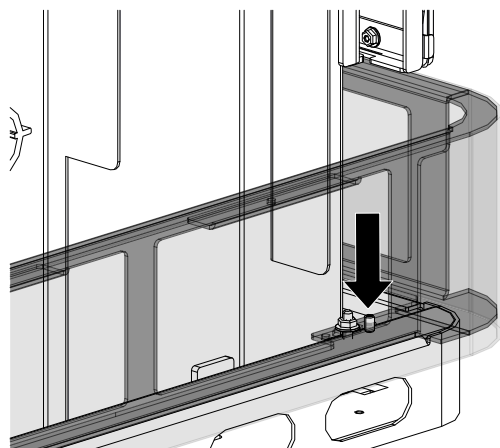

Fig. 4: Regolazione della base

- 5) Allineare la base alla stufa combinate mediante la vite di regolazione.

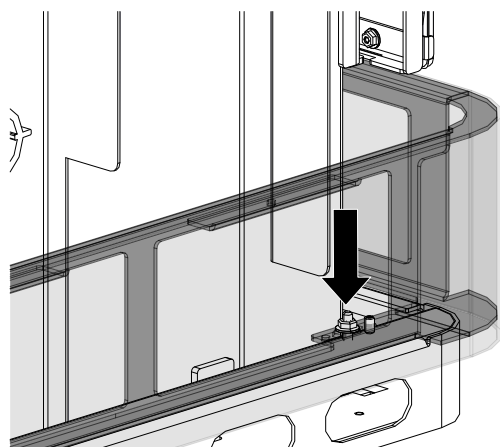

Fig. 5: Serraggio dei dadi

- 6) Serrare lateralmente i quattro dadi.

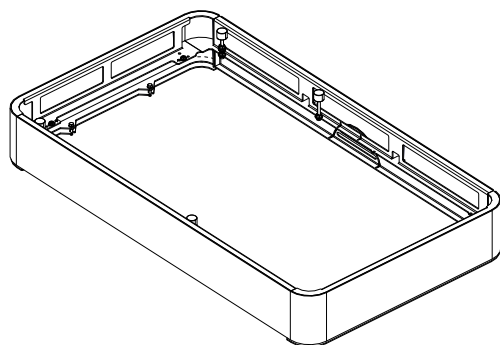

Fig. 6: Assemblaggio della base superiore

- 7) Estrarre la base superiore dall'imballaggio.
⇒ La base è pre-assemblata.

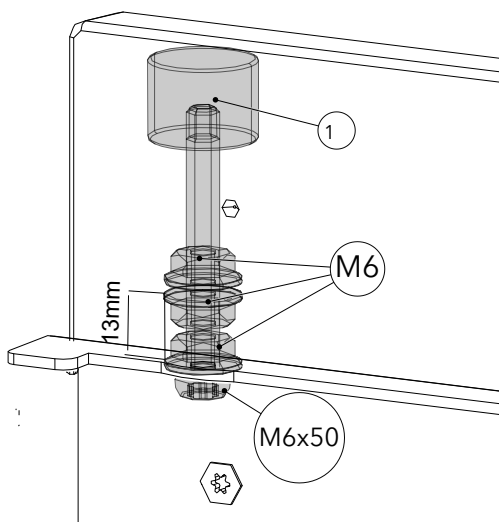

Fig. 7: Distanza a 13 mm

8) Controllare e regolare la distanza a 13 mm.

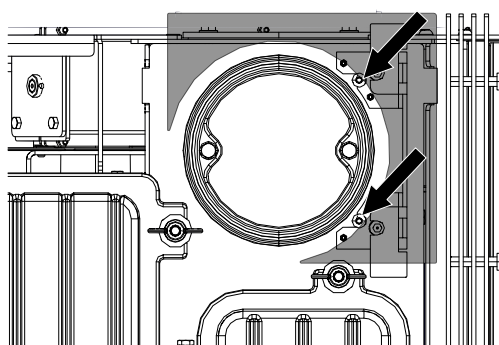

Fig. 8: Svitamento delle viti e rimozione della copertura

9) Svitare entrambe le viti (TX25) e togliere la copertura (fori longitudinali).

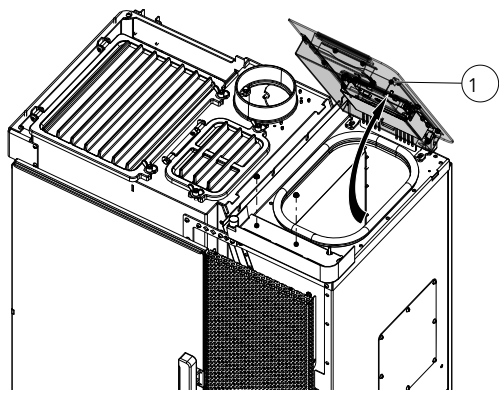

Fig. 9: Apertura del coperchio del contenitore

10) Aprire completamente il coperchio del contenitore (1).

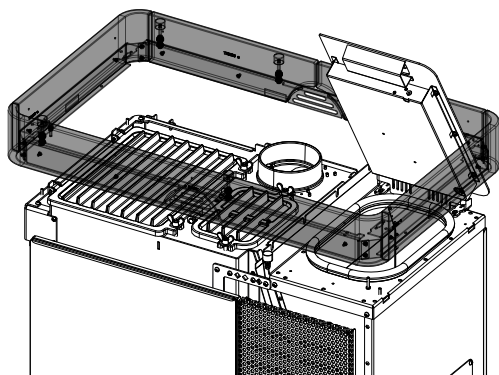
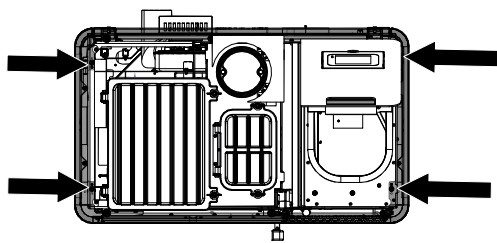

Fig. 10: Montaggio dell'anello superiore

11) Montare l'anello superiore. Fare attenzione a non graffiare il coperchio del contenitore.



- 12) Allineare l'anello superiore con la spina filettata M5x8 (1).
- 13) Montare e serrare i quattro dadi con flangia M5 (2).

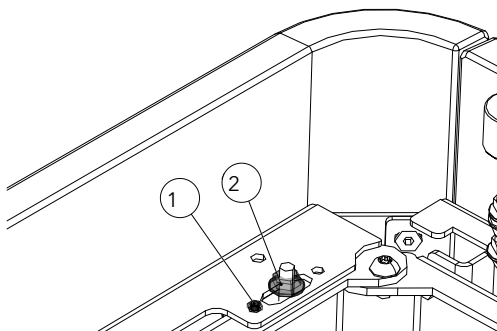
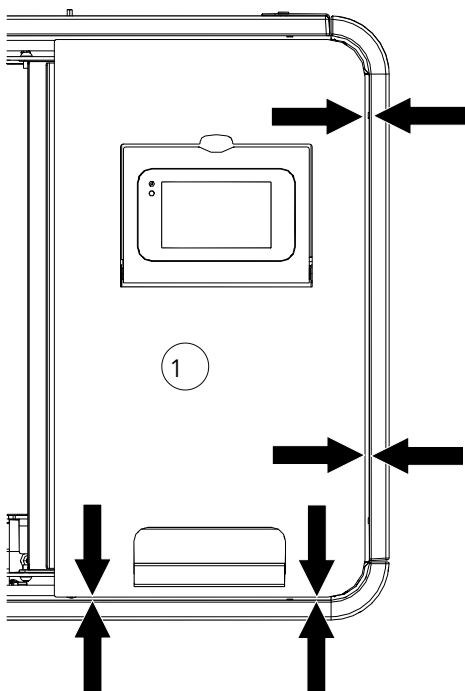

Fig. 11: Allineamento dell'anello superiore



- 14) Assicurati che il coperchio del contenitore possa essere aperto e chiuso senza problemi.

Fig. 12: Montaggio della struttura in ceramica superiore

15) Smontare i diaframmi posteriori.

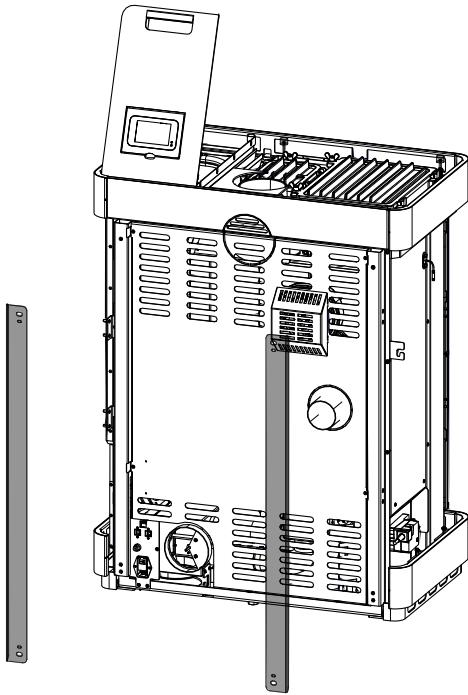

Fig. 13: Smontaggio dei diaframmi

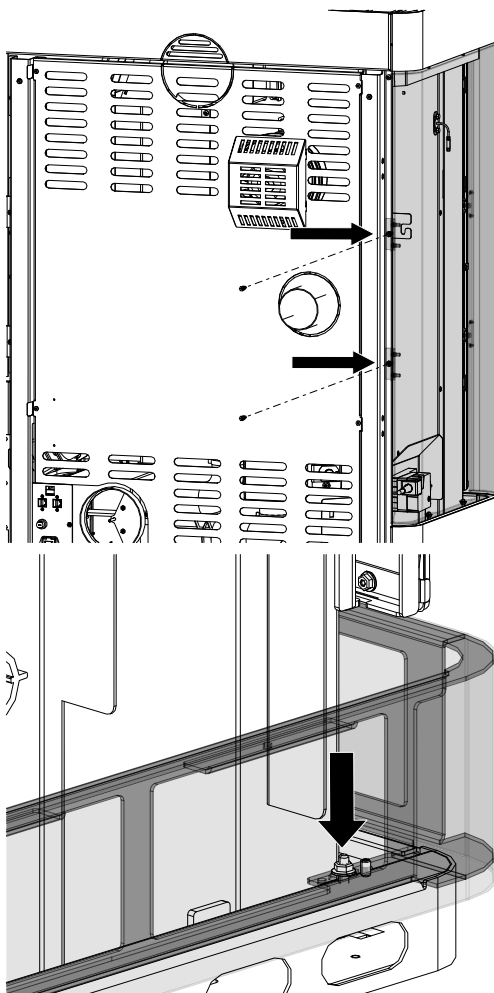

Fig. 14: Fissaggio del rivestimento in acciaio da dietro

16) Fissare il rivestimento laterale sinistro alla stufa combinata da dietro.

17) Se i fori non si adattano, la base inferiore deve essere allineata coi dadi in modo tale da poter montare il rivestimento laterale sinistro.

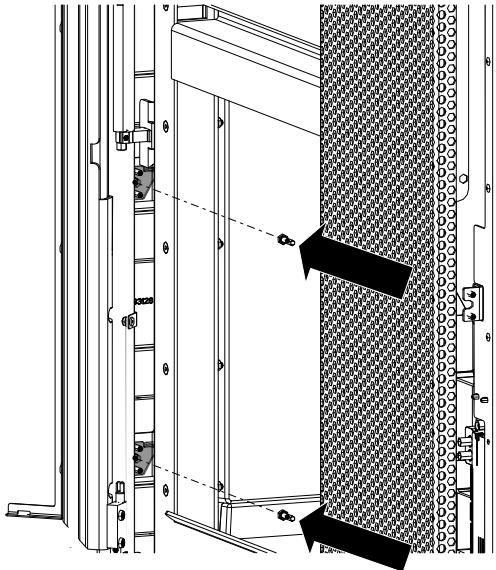

Fig. 15: Apertura dello sportello e fissaggio del rivestimento in acciaio

18) Aprire lo sportello e fissare il rivestimento laterale in acciaio dall'interno.

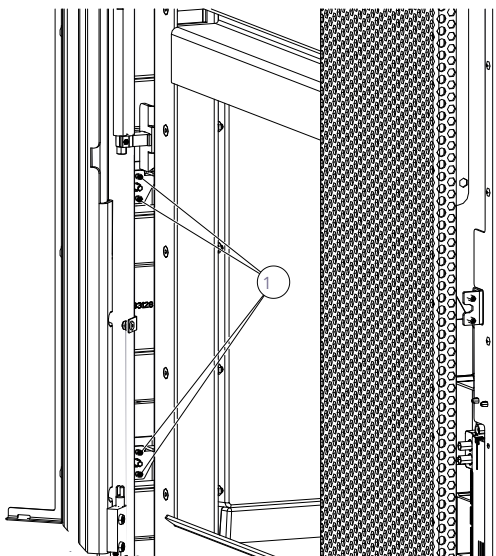

Fig. 16: Allineamento del rivestimento in acciaio

19) Mediante le viti di regolazione (1) è possibile allineare il rivestimento in acciaio con lo sportello.

- ⇒ Regolare le viti di regolazione in modo che lo sportello possa essere aperto facilmente, senza che tocchi il rivestimento laterale in acciaio.

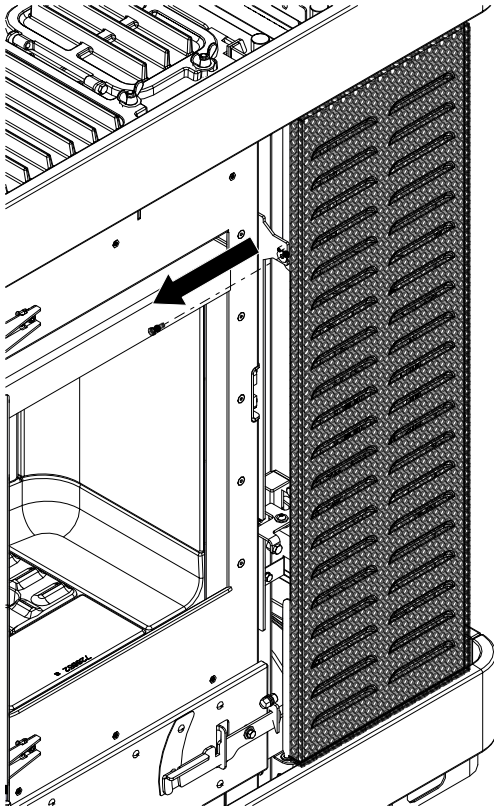

Fig. 17: Rimozione del rivestimento anteriore

- 20) Allentare la vite del rivestimento anteriore e rimuoverlo.

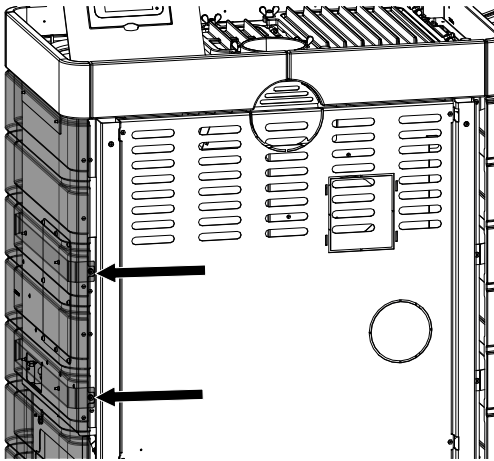

Fig. 18: Fissaggio del rivestimento laterale

- 21) Posizionare il rivestimento laterale di destra come descritto in precedenza e fissarlo in basso.

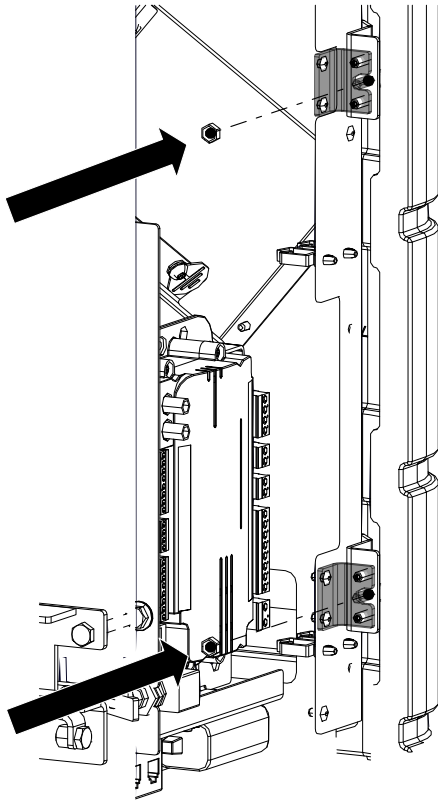

Fig. 19: Fissaggio e allineamento del rivestimento laterale

22) Fissare anteriormente il rivestimento laterale di destra e allinearlo con le viti di regolazione.

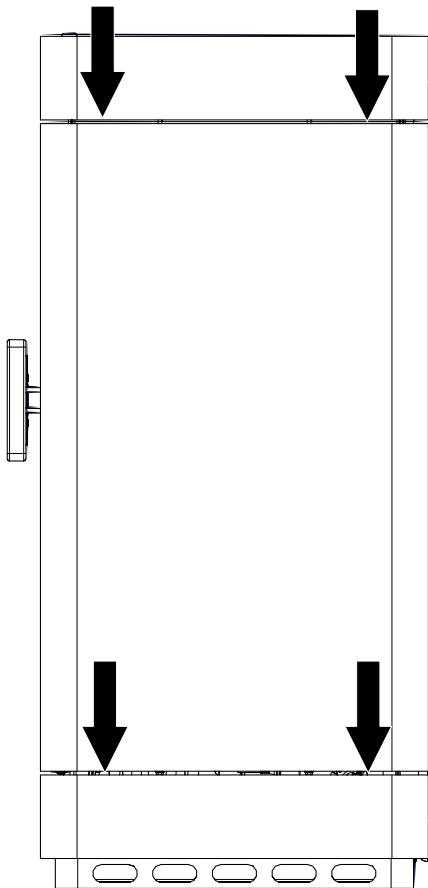

Fig. 20: Controllo delle distanze

23) Controllare infine che il rivestimento in acciaio presenti la stessa distanza su tutti i lati.
⇒ All'occorrenza, regolare le distanze con le viti di regolazione.

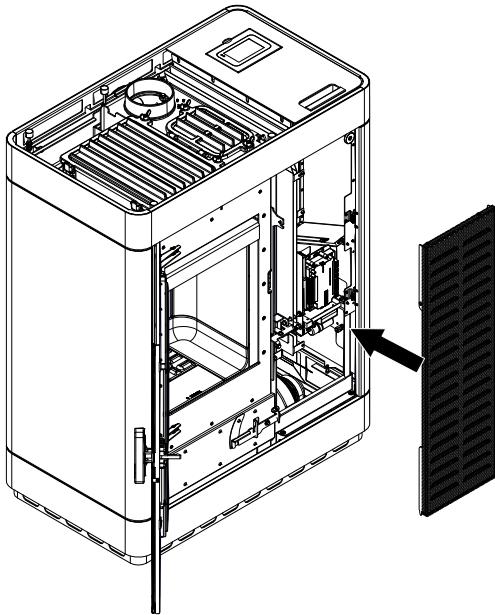

Fig. 21: Posizionamento del rivestimento

- 24) Fissare il rivestimento anteriormente e avvitare le viti senza stringere.

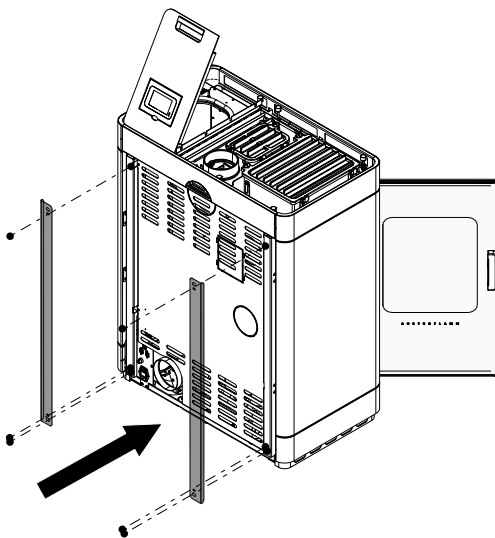

Fig. 22: Montaggio dei diaframmi

- 25) Rimontare i due diaframmi posteriori.

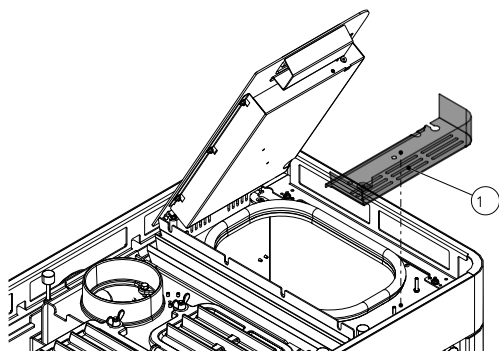

Fig. 23: Montaggio della nicchia del contenitore

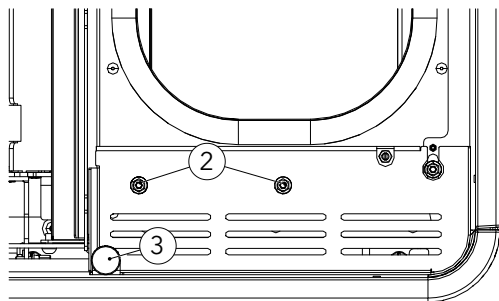

Fig. 24: Montaggio dei dadi e del tampone in silicone metallico

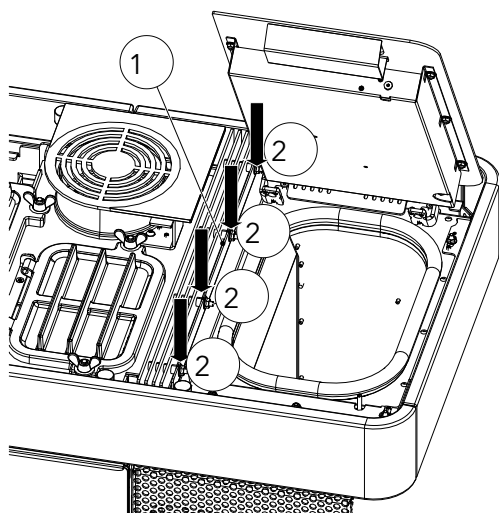

Fig. 25: Montaggio delle alette di convezione sulla destra

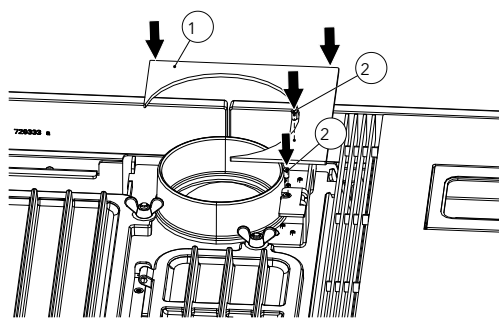

Fig. 26: Montaggio della copertura

- 26) Montare la nicchia del contenitore (1) e fissarla con i dadi (2) (M5/SW8).
- 27) Montare il tampone in silicone metallico (3) (M6/SW10) e allineare il coperchio del contenitore.
- 28) Controllare la funzionalità dell'interruttore del coperchio del contenitore (suono udibile del clic quando si apre/chiude).
- 29) La nicchia del contenitore (1) deve trovarsi allineata con la base.

- 30) Montare le alette di convezione sulla destra (1).
- 31) Serrare i quattro dadi (2) (M6/SW10).

- 32) Rimettere la copertura superiore (1) e stringere le due viti (2) (TX25).

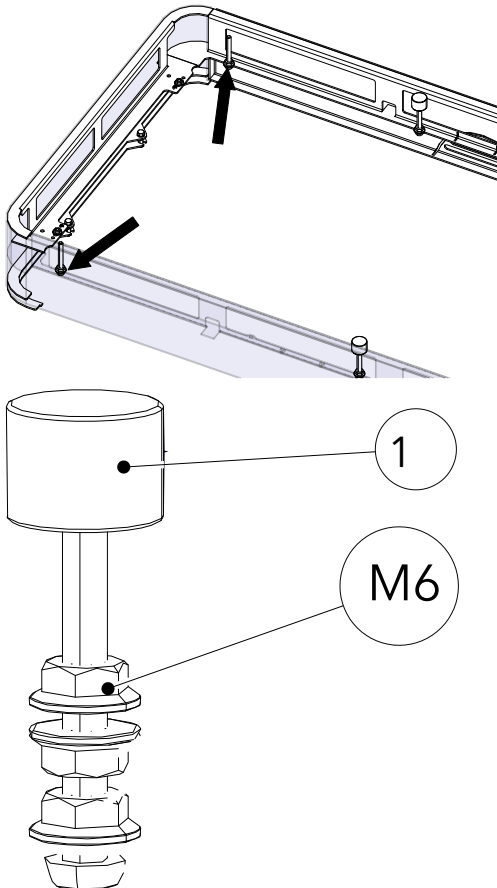

Fig. 27: Rimozione del tampone

- 33) Rimuovere i due tamponi in silicone a sinistra (1) e il dado superiore con flangia (M6).

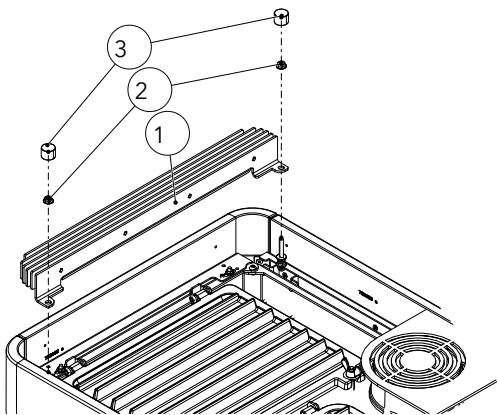

Fig. 28: Montaggio delle alette di convezione a sinistra.

- 34) Inserire le alette di convezione (1) a sinistra e fissarle con i due dadi (2) (M6/SW10).

- 35) Montare il tampone in silicone metallico (3) (M6/SW10) e allinearlo correttamente.

36) Inserire il coperchio dell'insero in vetro.

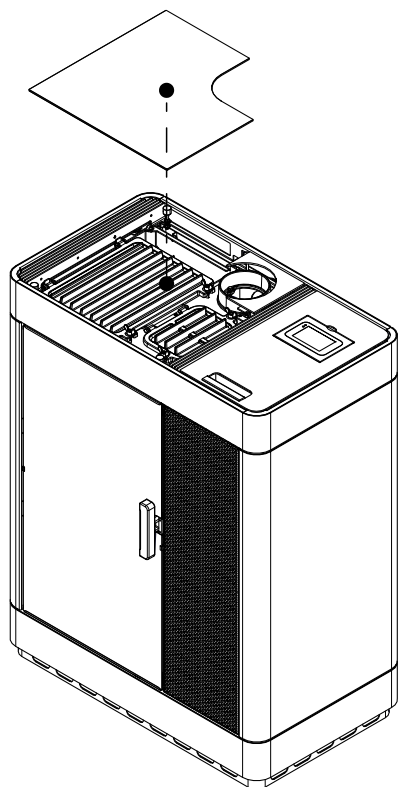

Fig. 29: Inserimento del coperchio dell'insero in vetro

AUSTROFLAMM GMBH
Austroflamm-Platz 1
A- 4631 Krenglbach

Tel: +43 (0) 7249 / 46 443
www.austroflamm.com
info@austroflamm.com

812103-29 - 945175

