

Montageanleitung / Assembly instructions  
Instructions de montage / Istruzioni di montaggio

## Umbausatz HMS montieren

Installing the HMS retrofit kit

Installer le kit de modification HMS

Montaggio del kit di conversione dell'HMS



**AUSTROFLAMM**

[www.austroflamm.com](http://www.austroflamm.com)

Originalbetriebsanleitung  
29/07/2024

Version: 1.0

#### IMPRESSUM

Eigentümer und Herausgeber

AUSTROFLAMM GMBH  
Austroflamm-Platz 1  
A- 4631 Krenglbach  
Tel: +43 (0) 7249 / 46 443  
[www.austroflamm.com](http://www.austroflamm.com)  
[info@austroflamm.com](mailto:info@austroflamm.com)

Redaktion: Olivera Stojanovic

Abbildungen: Konstruktion

Text: Technische Abteilung (Austroflamm)

#### Copyright

Alle Rechte vorbehalten. Der Inhalt dieser Anleitung darf nur mit Genehmigung des Herausgebers vervielfältigt oder verbreitet werden! Druck-, Rechtschreib- und Satzfehler vorbehalten.

Die Informationen in diesem Dokument können ohne vorherige Ankündigung geändert werden und stellen keine Verpflichtung seitens der Austroflamm GmbH dar. Für eventuelle Fehler in diesem Dokument übernimmt die Austroflamm GmbH keine Haftung.

## Inhaltsverzeichnis

Deutsch.....	4
English .....	10
Français.....	16
Italiano .....	22

## Inhaltsverzeichnis

1	Allgemeines.....	5
2	Demontage vom alten HMS.....	6
3	Montage neues HMS.....	8

# 1 Allgemeines

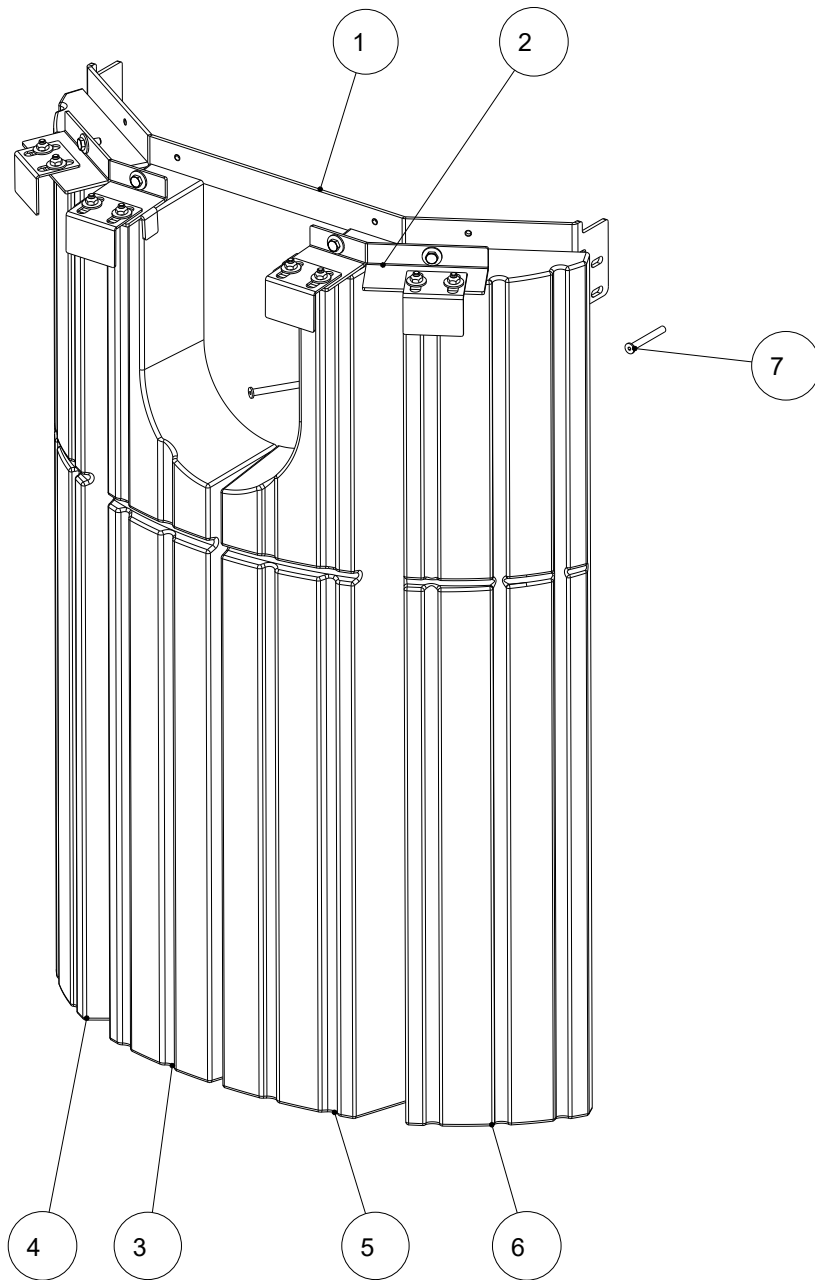

Pos. Nr.	Anzahl	Artikel	Artikel-Nr.
1	1	HMS-Halterung Umbau	732850-95
2	1	Befestigung HMS komplett	732758
3	1	HMS Rückteil Mitte rechts	732535
4	1	HMS Rückteil rechts	732536
5	1	HMS Rückteil Mitte links	732539
6	1	HMS Rückteil links	732537
7	4	Zylinderkopfschraube mit ISK.e.n.K. M6x50	718930-92

## 2 Demontage vom alten HMS

- 1) Deckel (falls montiert) abnehmen.



Abb. 1: Deckel abnehmen

- 2) Je zwei Stück Befestigungsschrauben der Stahlseitenverkleidung rechts und links oben innen lösen (M5/TX25).



Abb. 2: Schrauben lösen

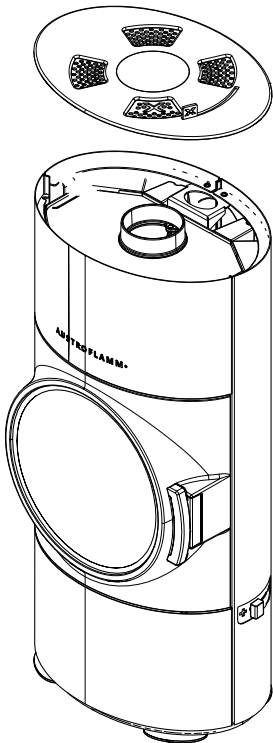

Abb. 3: Seitenverkleidung abnehmen

- 3) Seitenverkleidung nach oben anheben und abnehmen.

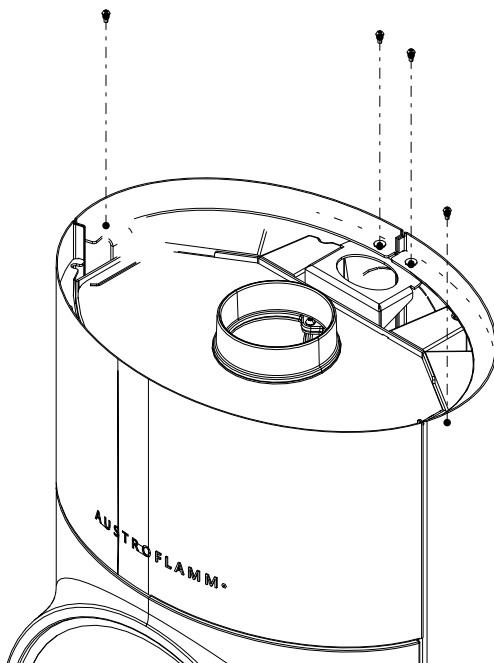
### ⚠ GEFAHR

#### Kippgefahr

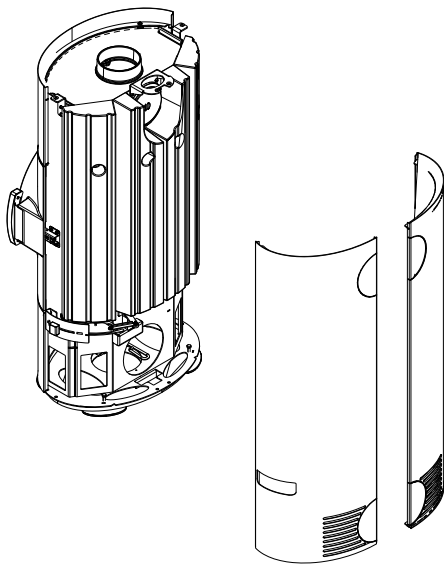
Bevor die HMS Steine ausgebaut werden - muss sichergestellt werden, dass der Kaminofen nicht nach vorne kippt.



Abb. 4: Keramik und Umlenkplatte herausnehmen

- 4) Tür öffnen.
- 5) Entnehmen Sie zuerst den oberen Keramott Stein (1) heraus.
- 6) Danach muss von Innen die Umlenkplatte (2) herausgenommen werden.
  - ⇒ Die Schrauben, die die HMS Steine befestigen dienen als Auflage für die Umlenkplatte. Wenn die Umlenkplatte nicht vorher rausgenommen wird - fällt diese auf den oberen Keramott Stein und kann diesen beschädigen.

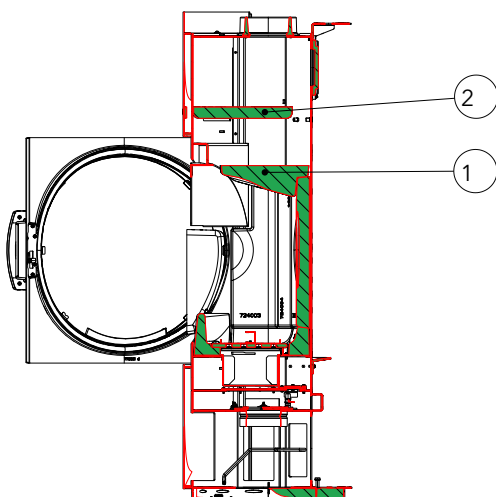

Abb. 5: Schrauben lösen und HSM demontieren

- 7) Lösen Sie die Schrauben.
- 8) HMS demontieren.

### 3 Montage neues HMS

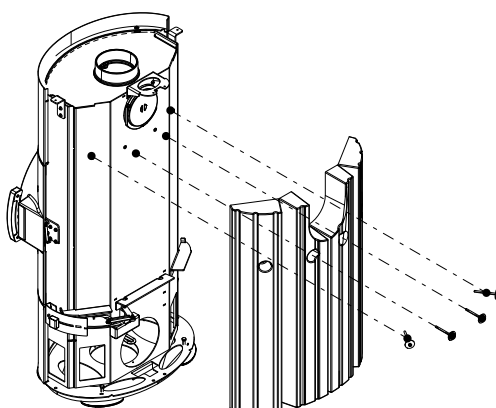

Abb. 6: Schrauben reinschrauben

- 1) Im Umbausatz für das neue HMS befinden sich vier Schrauben. Diese Schrauben in die Löcher reinschrauben – an denen das alte HMS befestigt war.

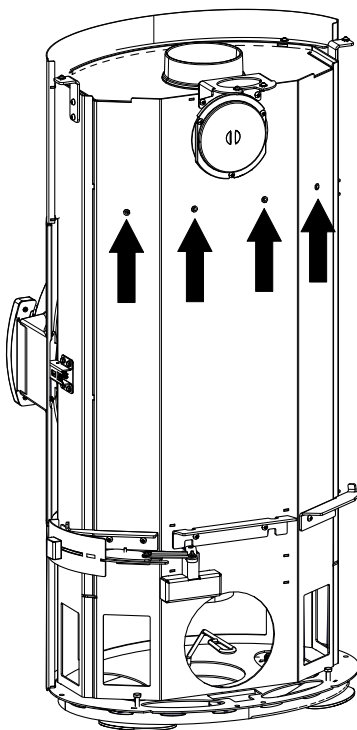

Abb. 7: Umlenkplatte und Keramott wieder einsetzen

- 2) Tür öffnen.
- 3) Die Umlenkplatte (2) wieder einsetzen.  
⇒ Die Schrauben, die in die Löcher geschraubt wurden (beim oberen Schritt) dienen als Auflage für die Umlenkplatte.
- 4) Den Keramott Stein (1) einsetzen.

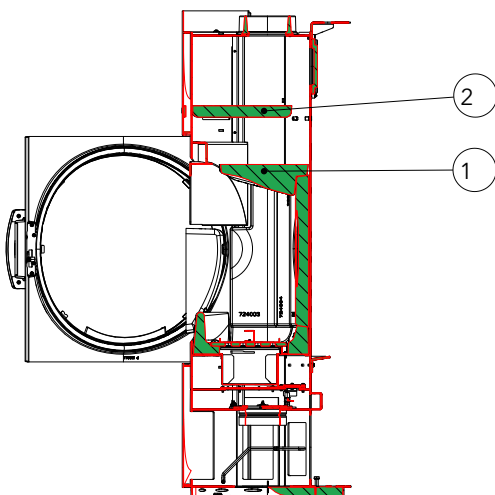

Abb. 8: Halterung montieren

- 5) Lange Halterung montieren.



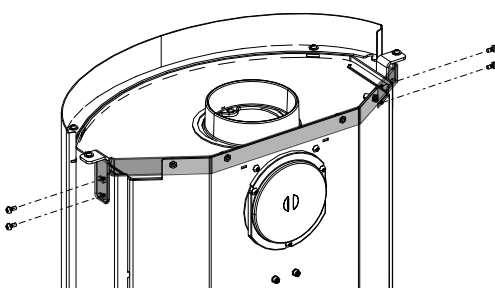

Abb. 9: Neue Halterungen montieren

- 6) Die kleinen Halterungen mit Schrauben und Muttern befestigen.



- 7) HMS-Stein anbringen und mit der zweiten Halterung (1) befestigen und fixieren.  
8) Wiederholen Sie den Vorgang für die restlichen HMS-Steine.

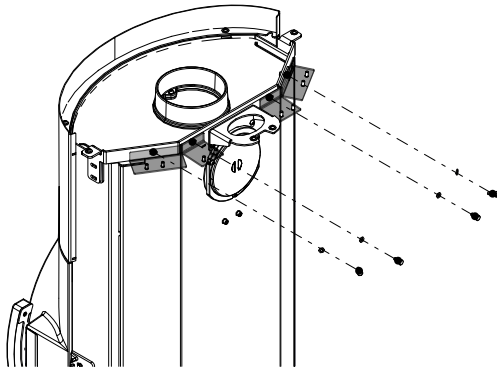
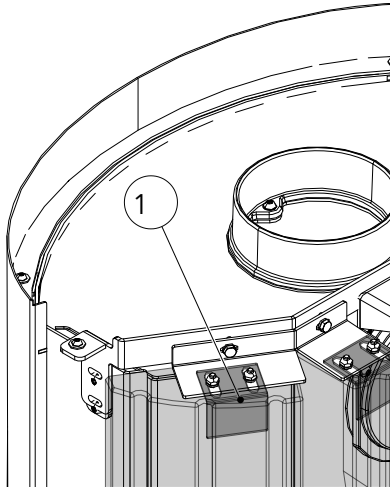

Abb. 10: HMS-Steine befestigen

- 9) Seitenverkleidungen wieder montieren und Deckel anbringen.

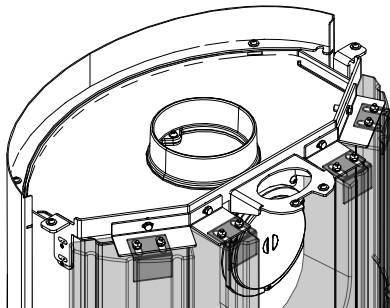

Abb. 11: Seitenverkleidung und Deckel anbringen

## Contents

1	General.....	11
2	Removing the old HMS.....	12
3	Mounting the new HMS.....	14

# 1 General

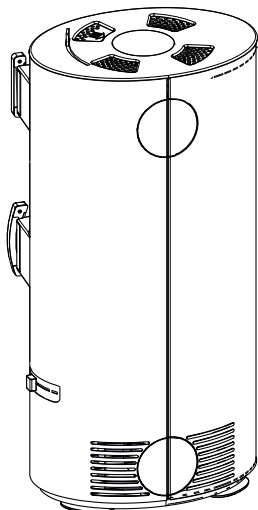
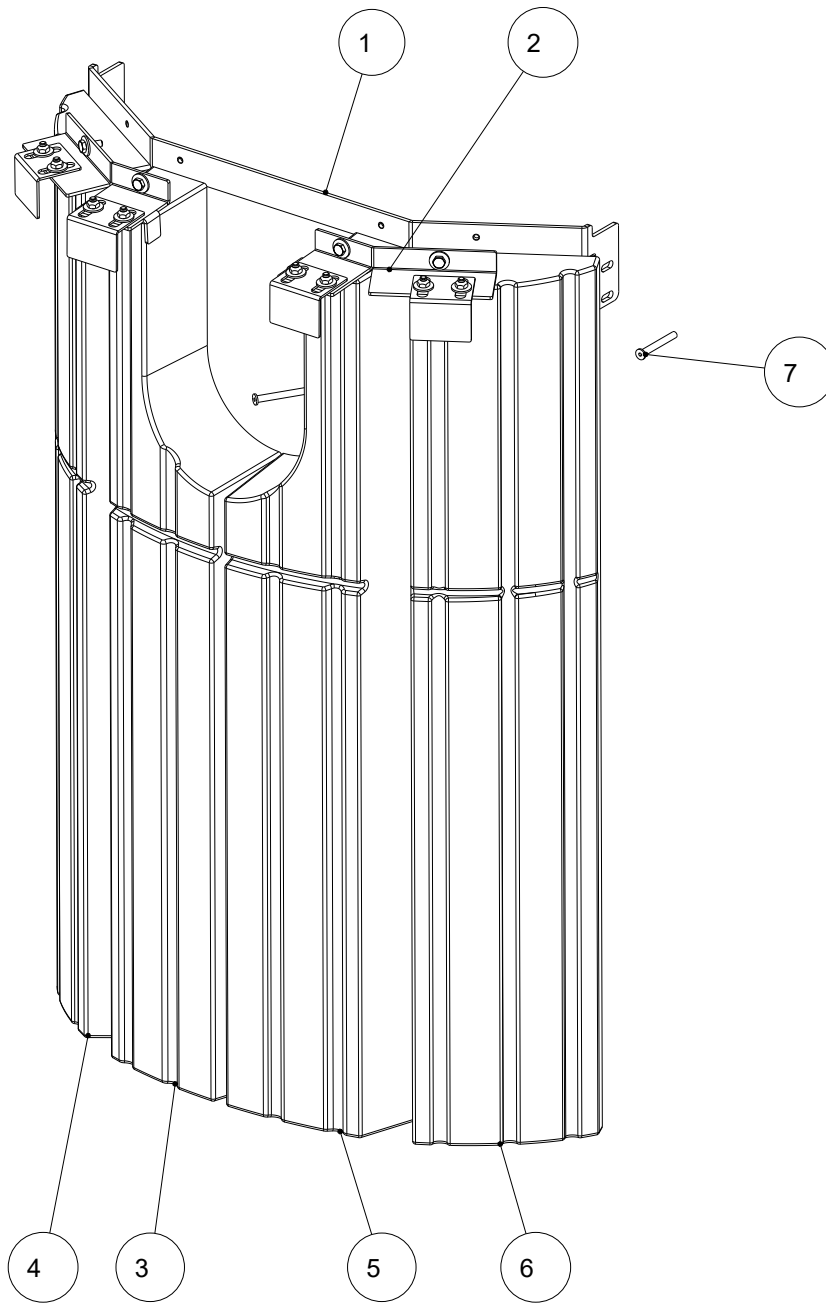

Item no.	Quantity	Article	Article no.
1	1	HMS mounting, conversion	732850-95
2	1	HMS fastening, complete	732758
3	1	HMS back part, centre right	732535
4	1	HMS back part, right	732536
5	1	HMS back part, centre left	732539
6	1	HMS back part, left	732537
7	4	Cheesehead bolt with socket head (very low head) M6x50	718930-92

## 2 Removing the old HMS

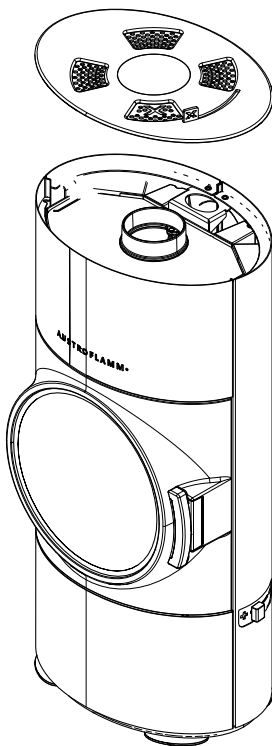

Fig. 1: Detaching the cover

1) Detach cover (if mounted).

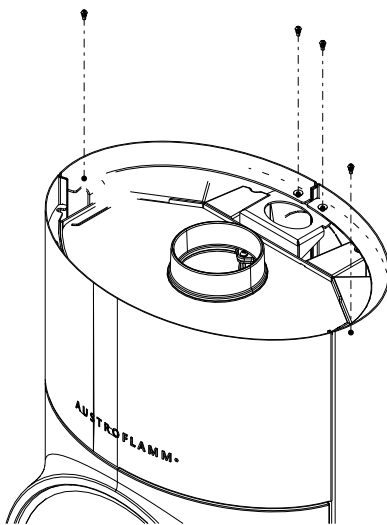

Fig. 2: Loosening the screws

2) Loosen the two locking screws (M5/TX25) of the steel side cladding, right and left inside top.

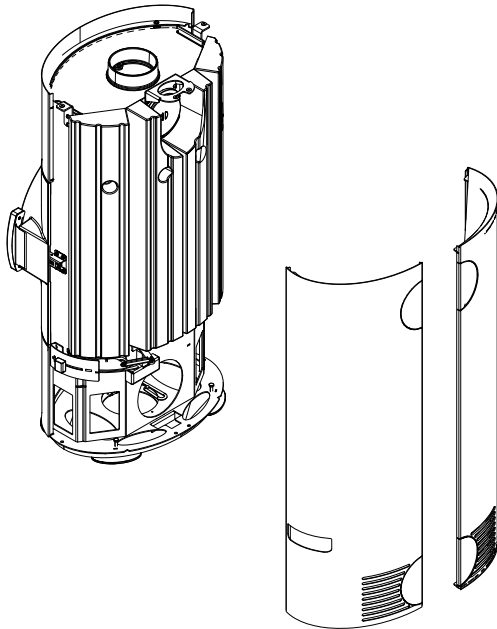

Fig. 3: Detaching the side cladding

3) Lift up and detach the side cladding.

**⚠ DANGER**

**Tilt hazard**

Before the HMS bricks are removed, it must be ensured that the stove does not tip forward.

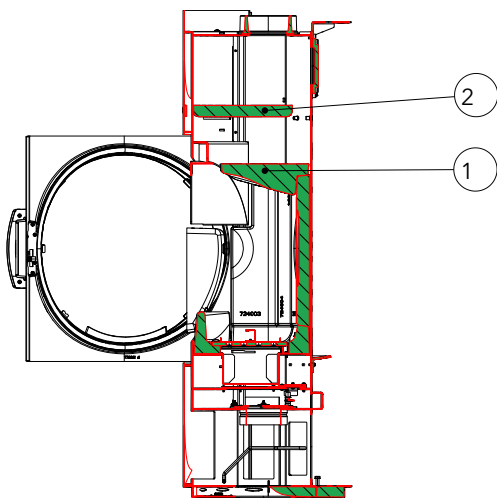

Fig. 4: Removing Keramott and baffle plate

- 4) Open door.
- 5) First take out the top Keramott brick (1).
- 6) Then the baffle plate (2) must be removed from inside.
  - ⇒ The screws that attach the HMS bricks are used as a support for the baffle plate. If the baffle plate is not taken out beforehand, it will fall on to the top Keramott brick and may damage it.

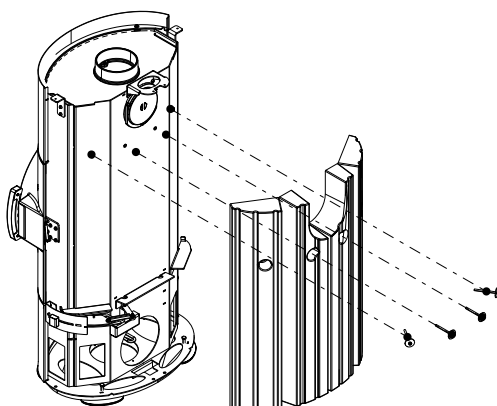

Fig. 5: Undoing the screws and removing the HMS

- 7) Undo the screws.
- 8) Remove the HMS.

### 3 Mounting the new HMS

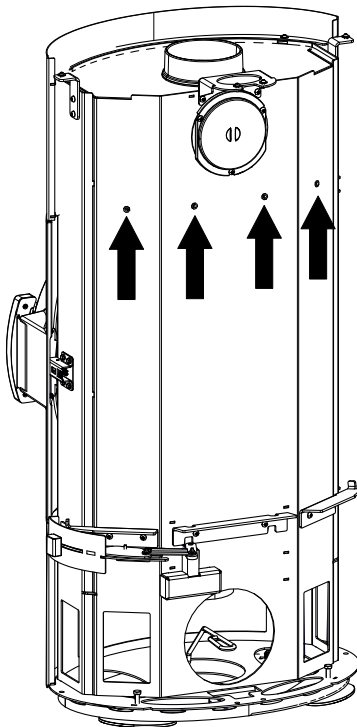

Fig. 6: Screwing in the bolts

- 1) There are four bolts in the retrofit kit for the new HMS. Screw these bolts into the holes which were used to attach the old HMS.

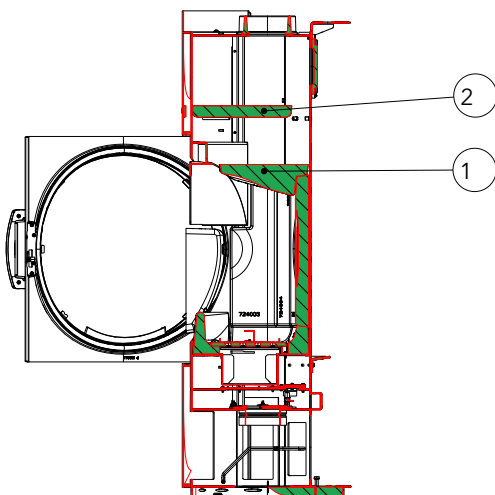

Fig. 7: Reinserting the baffle plate and Keramott

- 2) Open the door.
- 3) Reinsert the baffle plate (2).  
⇒ The bolts that were screwed into the holes (in the step above) are used as a support for the baffle plate.
- 4) Insert the Keramott block (1).

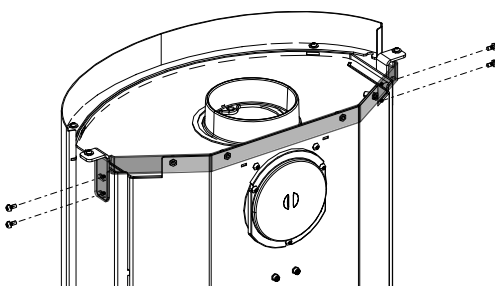

Fig. 8: Installing the mounting

- 5) Install the long mounting.

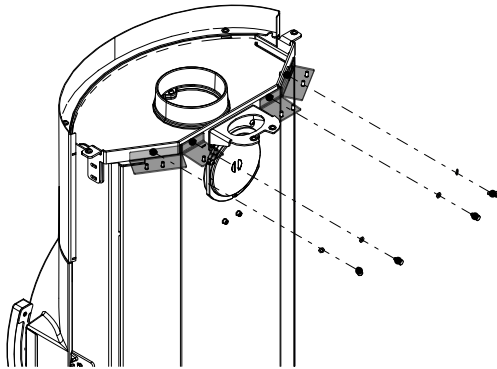
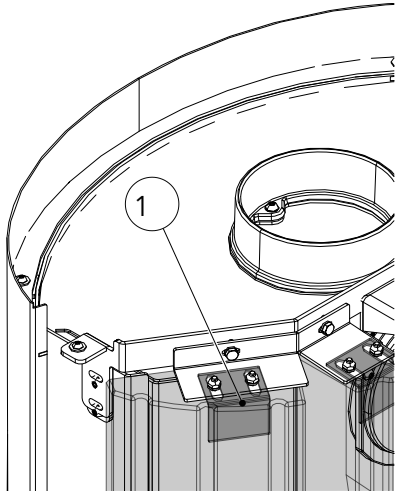

Fig. 9: Installing the new mountings

6) Use screws and nuts to fix the small mountings.



7) Mount HMS brick and attach and fix with the second mounting (1).

8) Repeat this procedure for the rest of the HMS bricks.

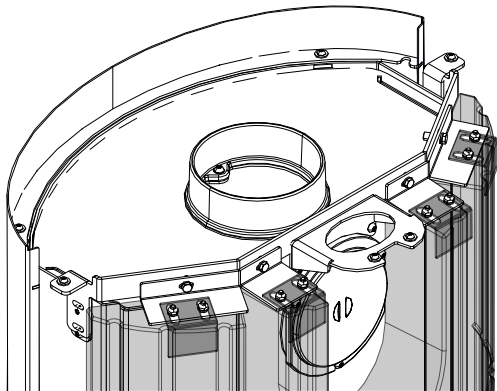

Fig. 10: Mounting the HMS bricks

9) Remount side cladding and attach cover.

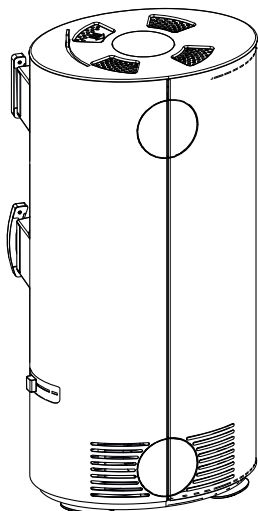

Fig. 11: Attaching side cladding and cover

## Sommaire

1	Généralités .....	17
2	Dépose de l'ancien HMS .....	18
3	Montage du nouvel HMS .....	20



# 1 Généralités

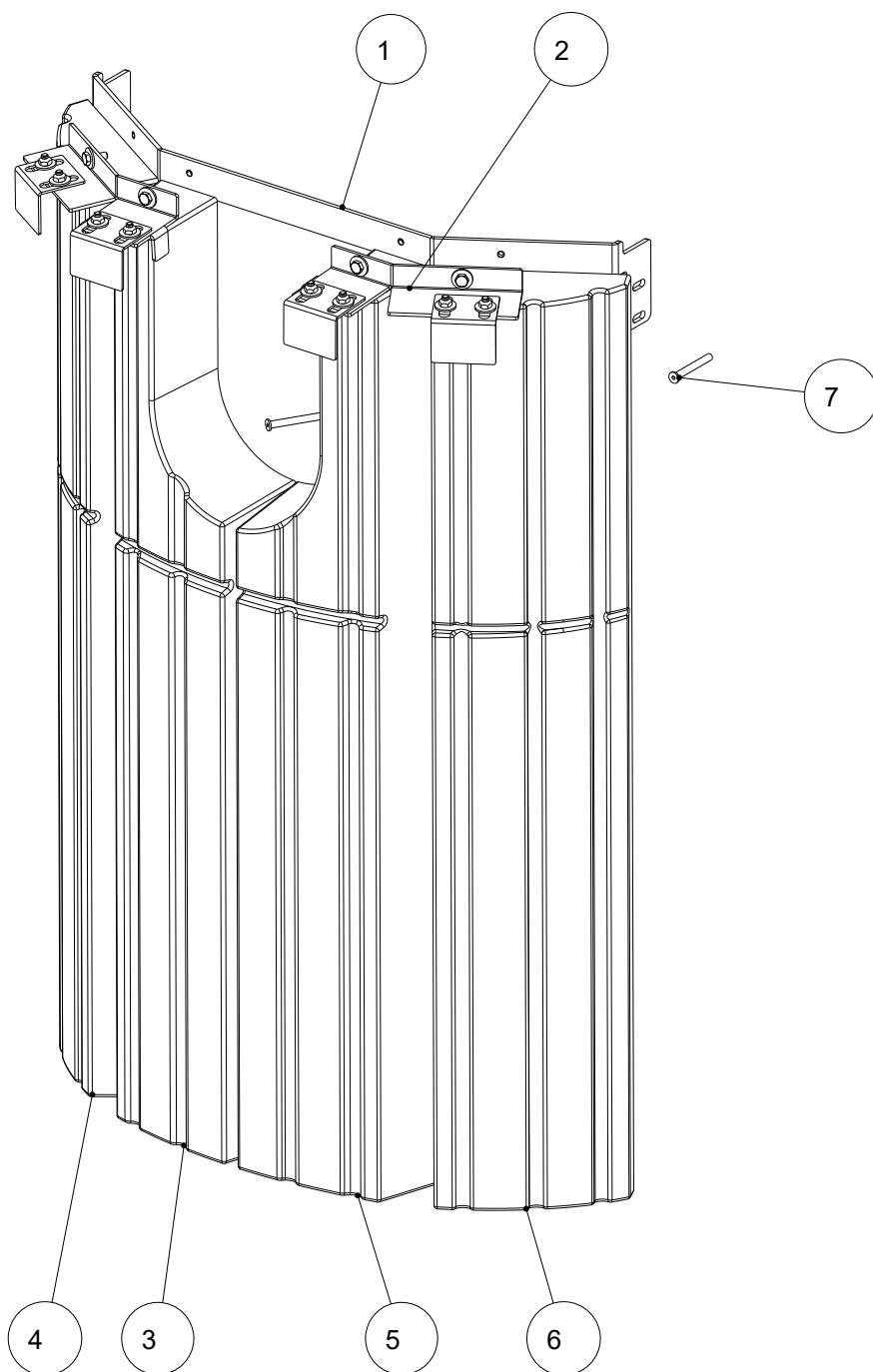

Pos. n°.	Quantité	Article	Article n°
1	1	Fixation HMS kit modification	732850-95
2	1	Fixation HMS complète	732758
3	1	HMS, partie arrière centre droit	732535
4	1	HMS, partie arrière droite	732536
5	1	HMS, partie arrière centre gauche	732539
6	1	HMS, partie arrière gauche	732537
7	4	Vis à tête cylindrique 6 pans creux à tête extrêmement basse M6x50	718930-92

## 2 Dépose de l'ancien HMS

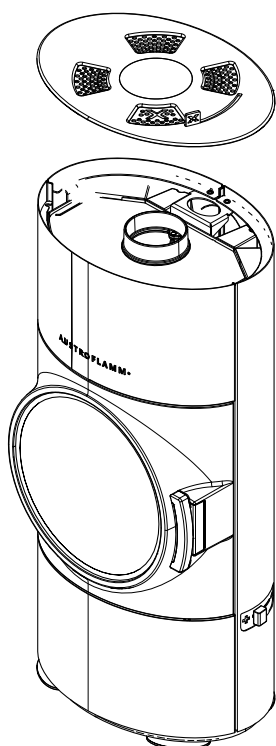

Fig. 1: Enlever le couvercle.

- 1) Enlever le couvercle (si en place).

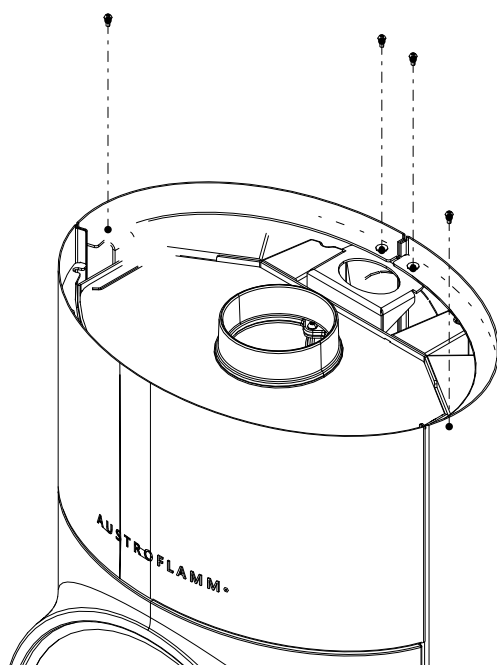

Fig. 2: Dévisser les vis

- 2) Dévisser de chaque côté, en haut à l'intérieur, deux vis de fixation de l'habillage en acier latéral (M5/TX25).

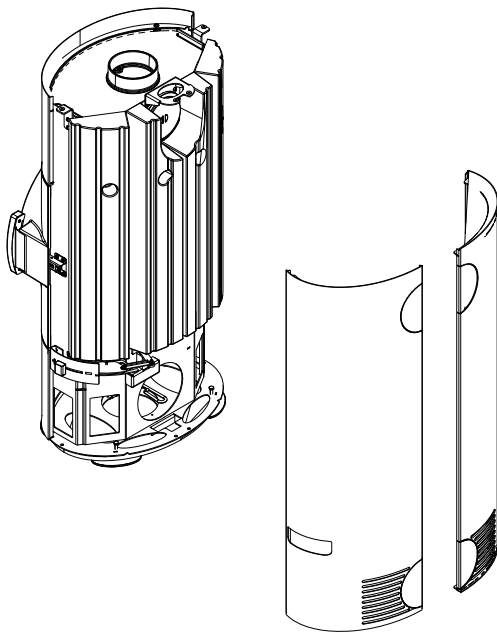

Fig. 3: Enlever l'habillage latéral

3) Soulever l'habillage latéral et l'enlever.

### DANGER

#### Risque de basculement

Avant de démonter les pierres HMS, assurez-vous que le poêle à bois ne bascule pas vers l'avant.

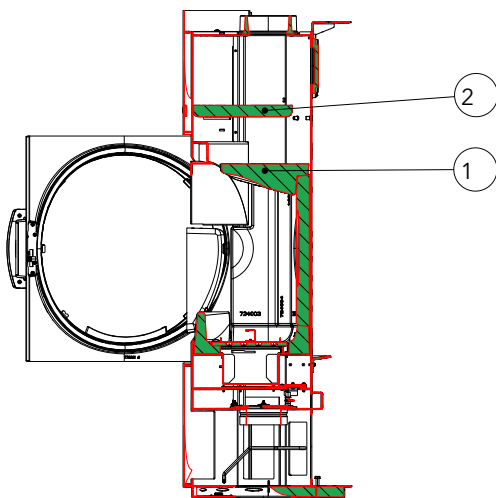

Fig. 4: Enlever la Keramott et la plaque déflectrice

- 4) Ouvrir la porte.
- 5) Extrayez d'abord la pierre en Keramott supérieure (1).
- 6) Ensuite, retirer la plaque déflectrice (2) de l'intérieur.

⇒ Les vis qui fixent les pierres HMS servent d'appui à la plaque déflectrice. Si la plaque déflectrice n'est pas enlevée avant, elle tombe sur la pierre en Keramott supérieure et peut l'endommager.

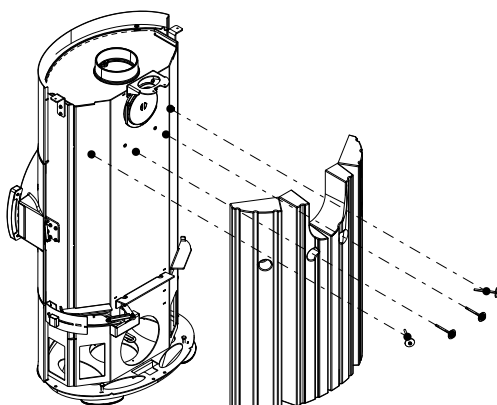

Fig. 5: Dévisser les vis et déposer l'HMS

- 7) Dévisser les vis.
- 8) Déposer l'HMS

### 3 Montage du nouvel HMS

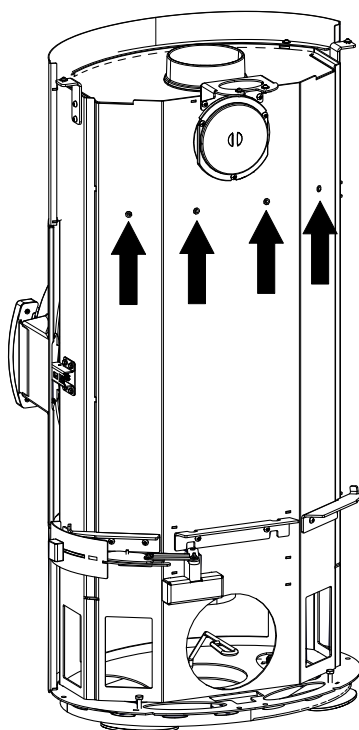

Fig. 6: Visser les vis

- 1) Le kit de modification pour le nouvel HMS contient quatre vis. Visser ces vis dans les trous auxquels l'ancien HMS était fixé.

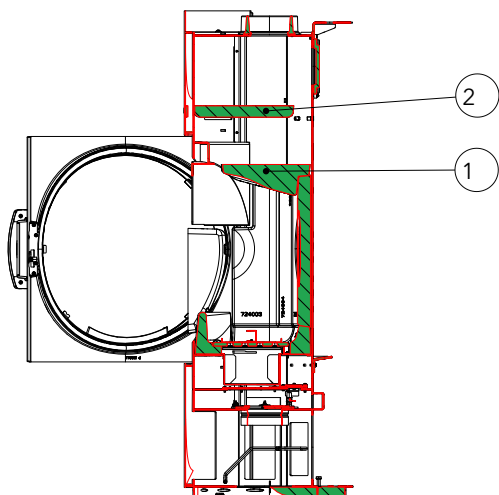

Fig. 7: Remettre la plaque déflectrice et la Keramott en place

- 2) Ouvrir la porte.
- 3) Remettre la plaque déflectrice (2) en place.  
⇒ Les vis qui ont été vissées dans les trous (à l'étape précédente) servent d'appui à la plaque déflectrice.
- 4) Mettre la pierre en Keramott (1) en place.

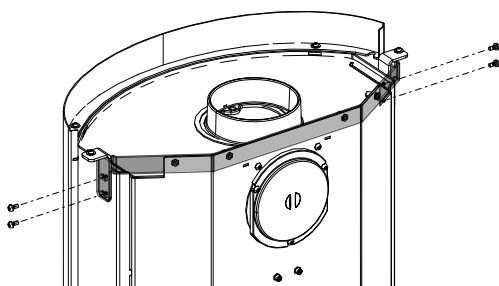

Fig. 8: Installer la fixation

- 5) Installer la fixation longue.

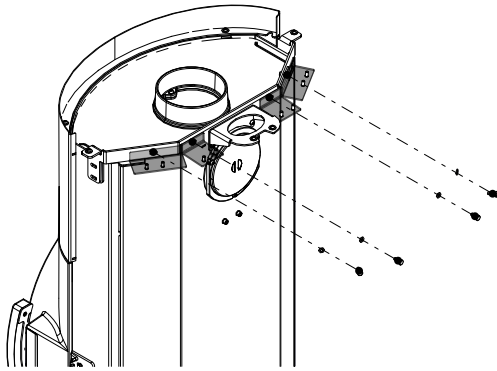
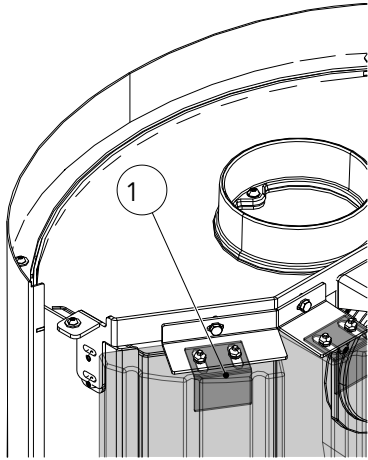

Fig. 9: Installer les nouvelles fixations

6) Fixer les petites fixations avec les vis et les écrous.



7) Poser la pierre HMS et la fixer avec la deuxième fixation (1).

8) Répétez la procédure pour les pierres HMS restantes.

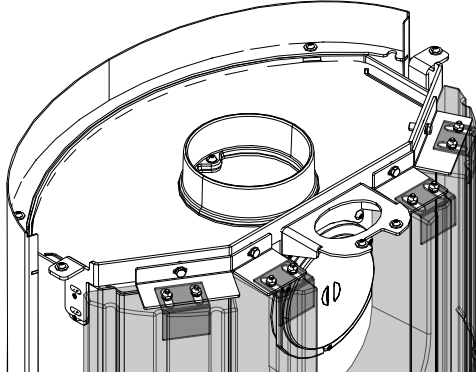

Fig. 10: Fixez les pierres HMS

9) Revisser les habillages latéraux et remettre le couvercle en place.

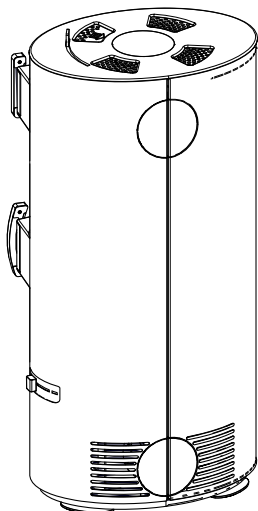

Fig. 11: Remettre l'habillage latéral et le couvercle en place

---

## Indice

1	Generalità .....	23
2	Smontaggio del vecchio HMS .....	24
3	Montaggio del nuovo HMS.....	26

# 1 Generalità

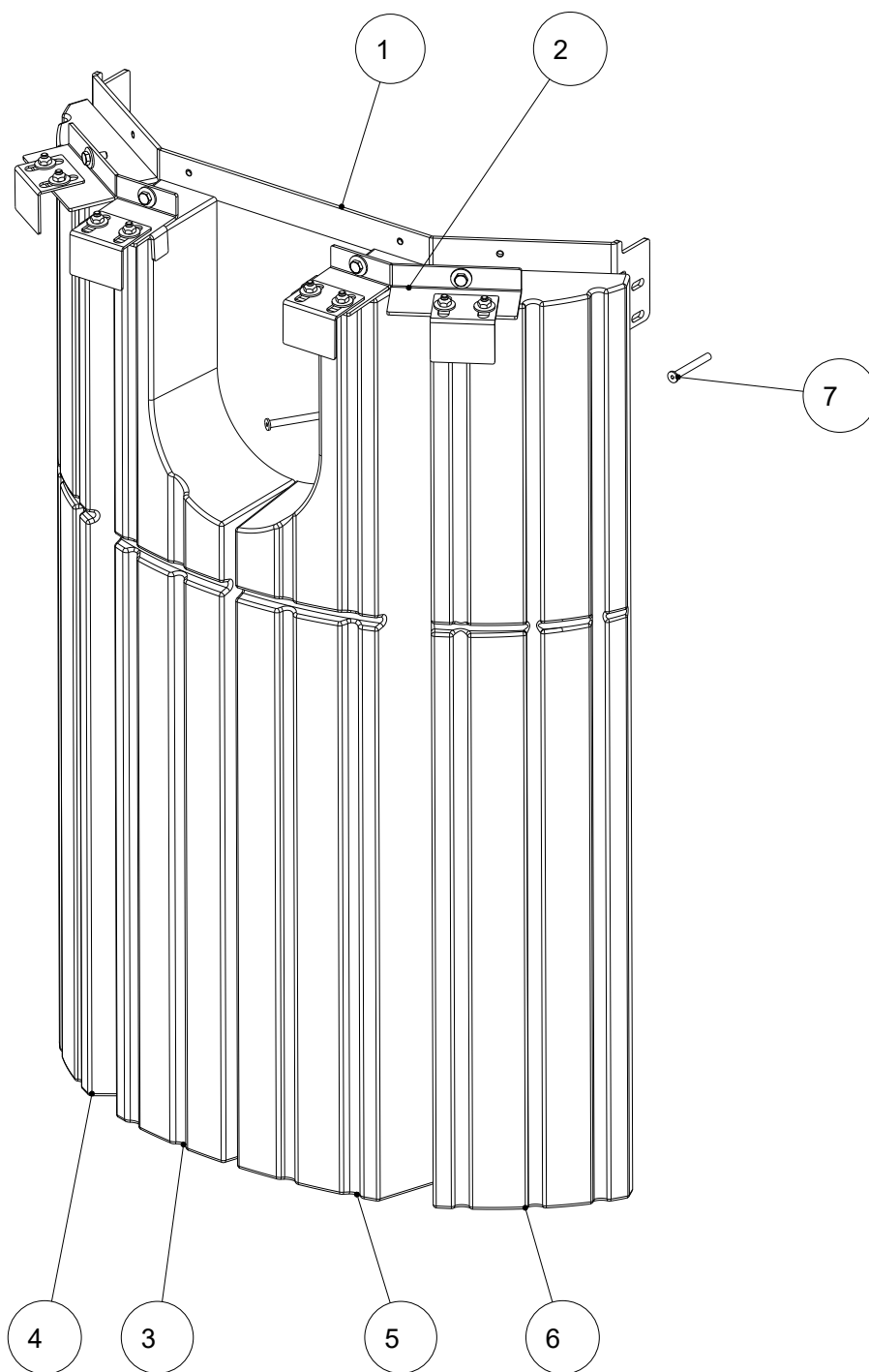

N. pos.	Q.tà	Articolo	N. art.
1	1	Conversione supporto HMS	732850-95
2	1	Fissaggio HMS completo	732758
3	1	Parte posteriore centrale HMS dx	732535
4	1	Parte posteriore HMS dx	732536
5	1	Parte posteriore centrale HMS dx	732539
6	1	Parte posteriore HMS sx	732537
7	4	Vite a testa cil. con esagono incass. e testa bassa M6x50	718930-92

## 2 Smontaggio del vecchio HMS

- 1) Rimuovere il coperchio (se presente).

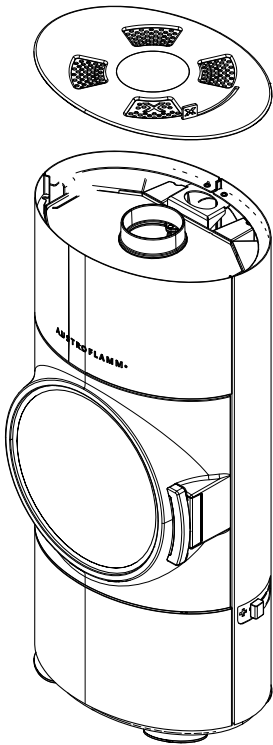

Fig. 1: Rimozione del coperchio

- 2) Svitare le viti di fissaggio del rivestimento laterale in acciaio, all'interno superiore destro e sinistro, 2 in tutto (M5/TX25).

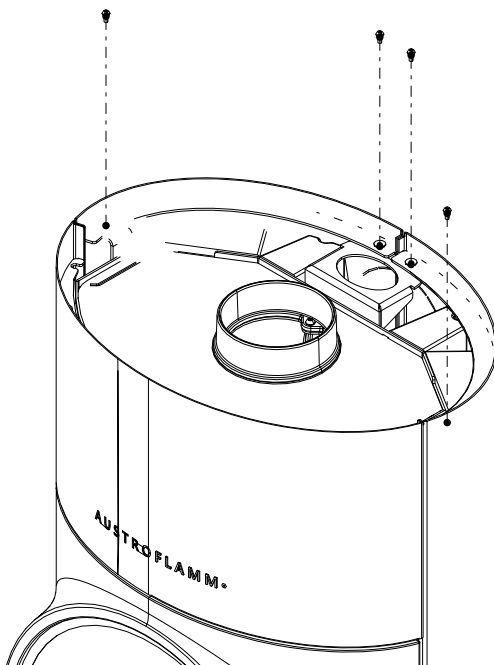

Fig. 2: Svitamento delle viti



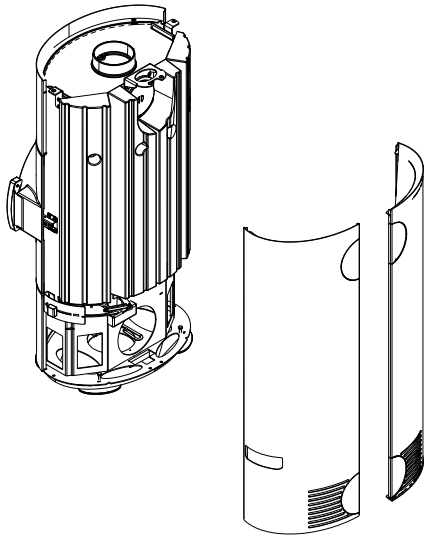

Fig. 3: Rimozione del rivestimento laterale

- 3) Sollevare il rivestimento laterale verso l'alto e rimuoverlo.

### PERICOLO

#### Pericolo di ribaltamento

Prima di rimuovere le lastre di pietra HMS, assicurarsi che la stufa non si ribalti in avanti.

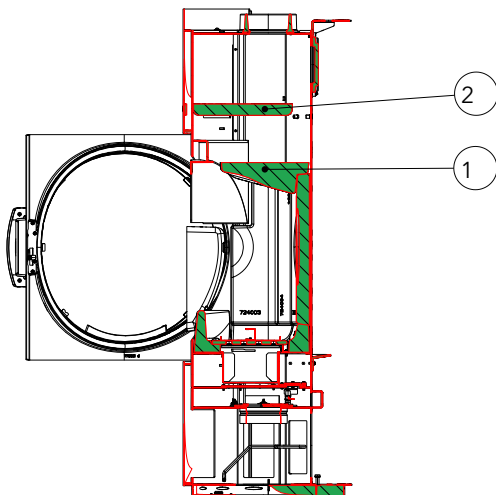

Fig. 4: Rimozione del Keramott e del deflettore

- 4) Aprire lo sportello.
- 5) Per prima cosa rimuovere la mattonella in Keramott superiore (1).
- 6) Poi rimuovere il deflettore (2) dall'interno.
  - ⇒ Le viti che fissano le mattonelle HMS servono da supporto al deflettore. Se prima non si rimuove il deflettore, cadrà sulla mattonella in Keramott superiore col rischio di danneggiarlo.

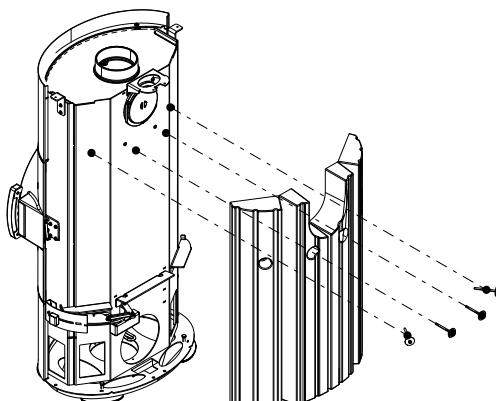

Fig. 5: Svitamento delle viti e smontaggio dell'HMS

- 7) Svitare le viti.
- 8) Smontare l'HMS.

### 3 Montaggio del nuovo HMS

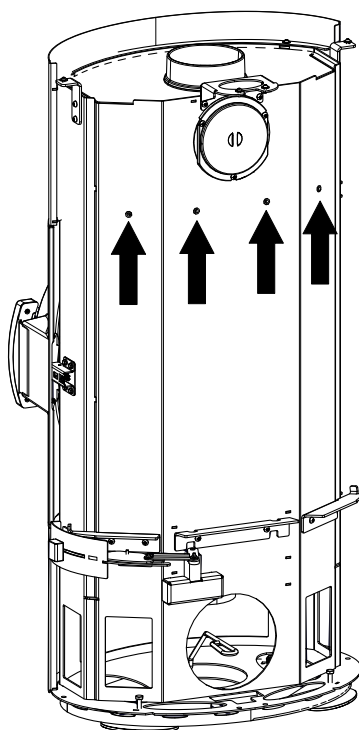

Fig. 6: Avvitamento delle viti

- 1) Il kit di conversione del nuovo HMS contiene quattro viti. Avvitare queste viti nei fori in cui era fissato il tipo vecchio.

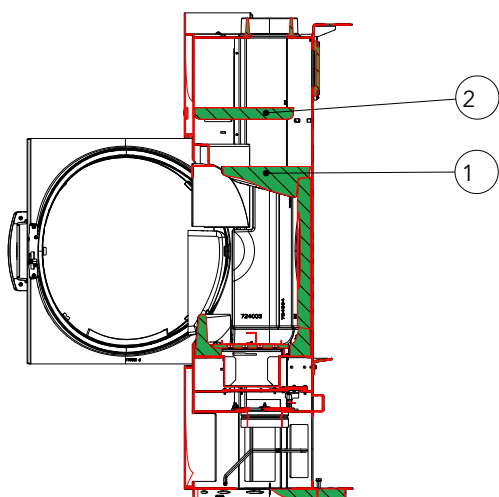

Fig. 7: Riposizionamento del deflettore e del Keramott

- 2) Aprire lo sportello.
- 3) Reinserrire il deflettore (2).  
⇒ Le viti che sono state avvitate nei fori (nella fase descritta sopra) servono come supporto per il deflettore.
- 4) Inserire la pietra in Keramott (1).

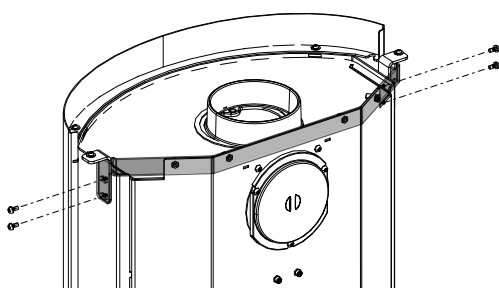

Fig. 8: Montaggio del supporto

- 5) Inserire il supporto lungo.

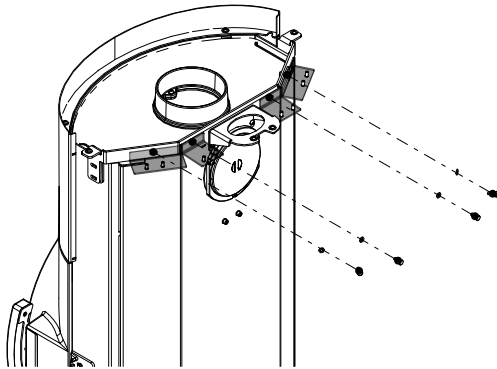
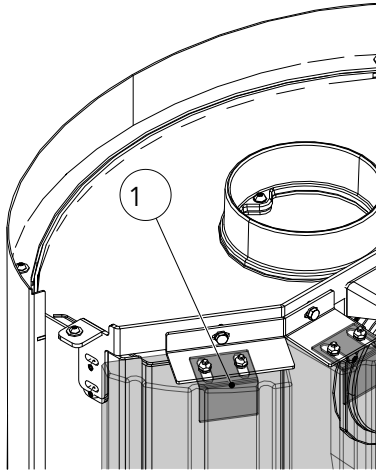

Fig. 9: Montaggio del nuovo supporto

6) Fissare i supporti con viti e dadi.



7) Posizionare la pietra HMS e fissarla col secondo supporto (1).

8) Ripetere l'operazione per le restanti pietre HMS.

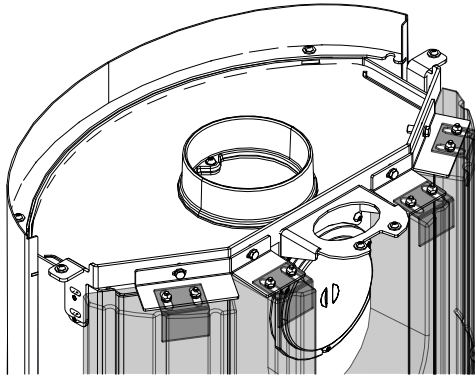

Fig. 10: Fissaggio delle pietre HMS

9) Rimontare i rivestimenti laterali e rimettere il coperchio.

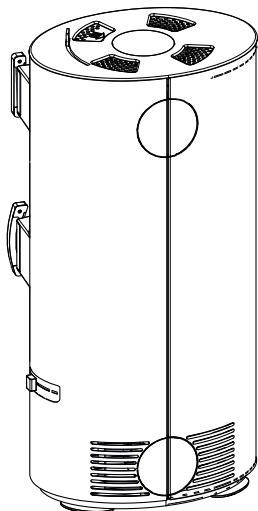

Fig. 11: Collocazione del rivestimento laterale e del coperchio

AUSTROFLAMM GMBH  
Austroflamm-Platz 1  
A- 4631 Krenglbach

Tel: +43 (0) 7249 / 46 443  
[www.austroflamm.com](http://www.austroflamm.com)  
[info@austroflamm.com](mailto:info@austroflamm.com)

732864-945095

